

± 38,556 SF AVAILABLE FOR SUBLEASE



*The Tower at*  
**4TH & MADISON**  
SEATTLE, WA

**CBRE**

# Amenities



Fourth & Madison is one of the premier office buildings in Downtown Seattle.



The project includes floor to ceiling glass with 9' ceilings, on-site child care, fitness center, building conference rooms and retail amenities such as a bank, barbershop and food/coffee serves alternatives.



Rooftop garden patio located on the 7th floor, building conference rooms, fitness center, and Bright Horizons child care

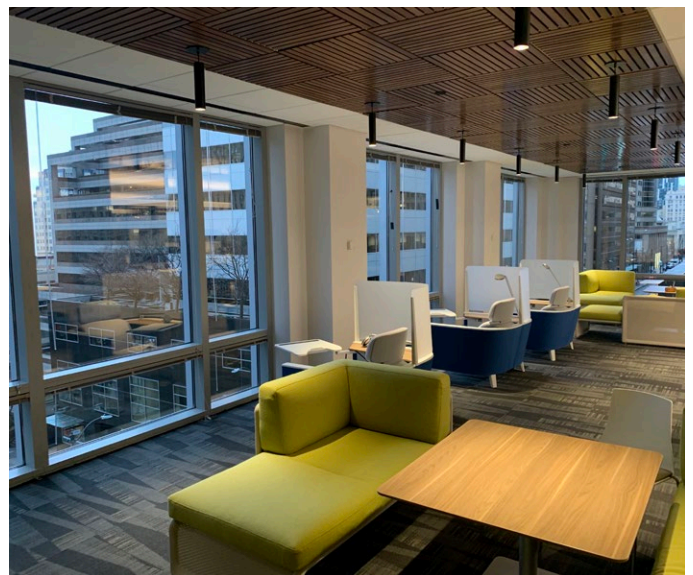

# Floor Plan

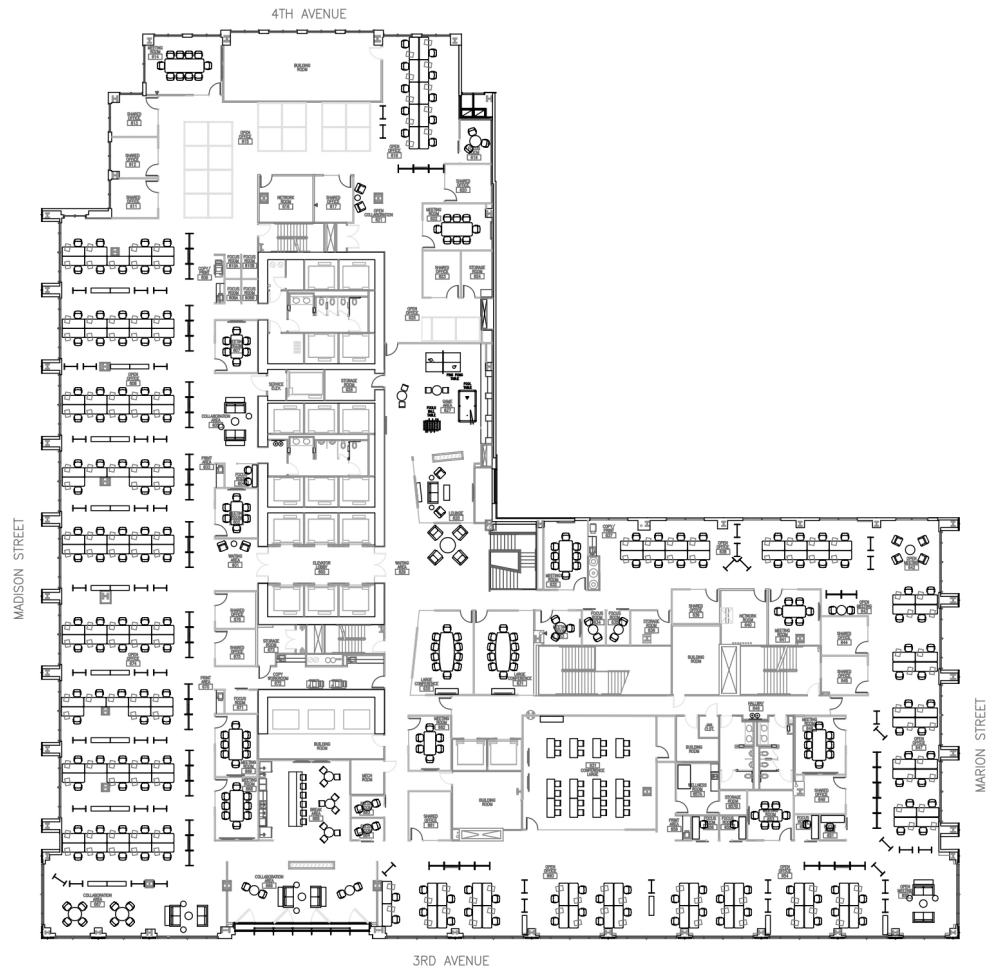

## Suite Features

- ▣ *6th floor: 38,556 SF*
- ▣ Available 07/01/19 (exp. 4/30/24)
- ▣ Plug n Play and furniture in place
- ▣ Brand new build out as of 2017

**EXCELLENT MASS TRANSIT ACCESS  
VIA THIRD AVENUE AND THE FERRY TERMINAL**

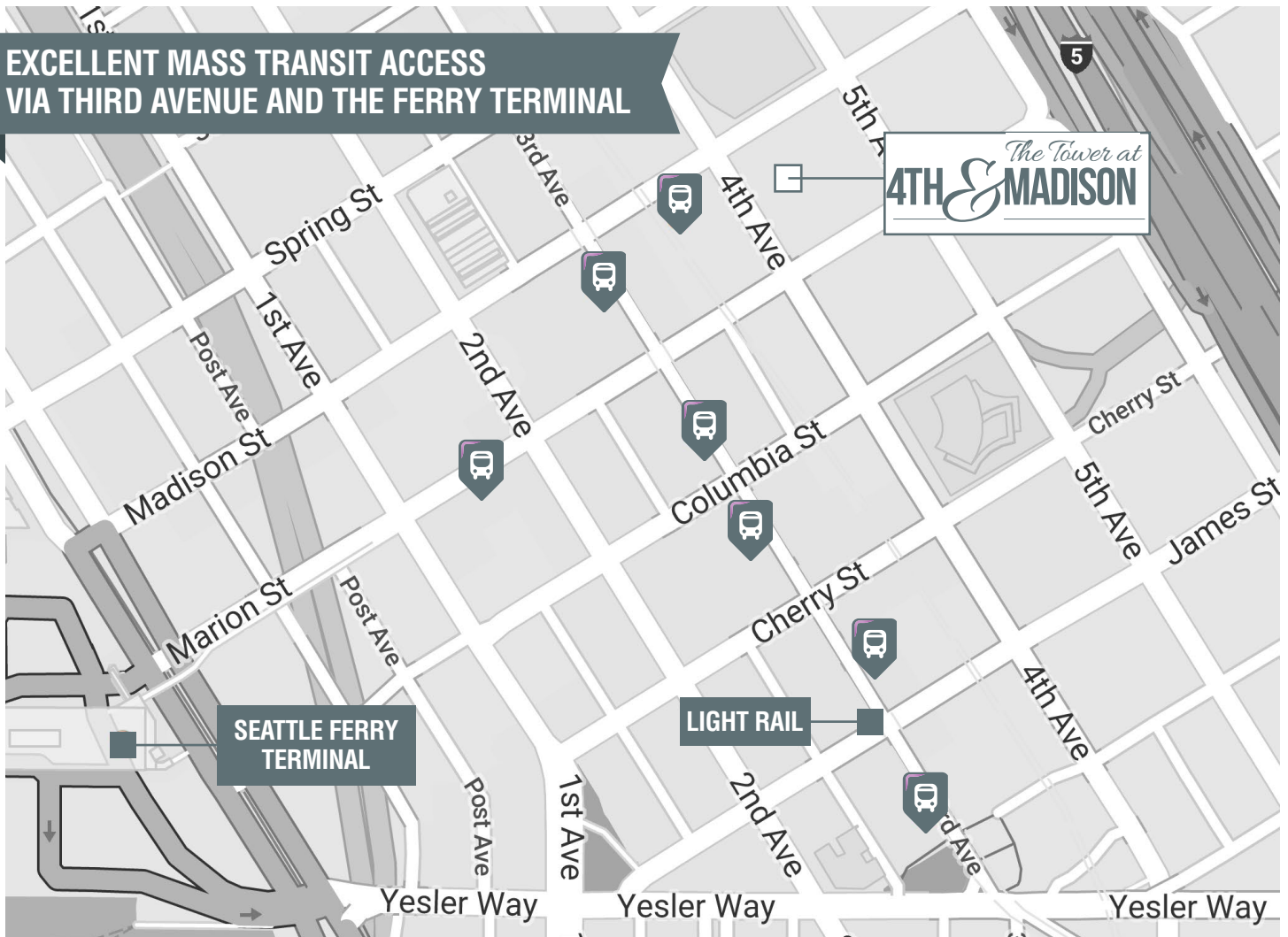

*The Tower at*  
**4TH & MADISON**  
SEATTLE, WA

*Contact Information:*

**NICK CARKONEN**  
SENIOR VICE PRESIDENT  
+1 206 292 6039  
NICK.CARKONEN@CBRE.COM

**PETE HOLLOMON**  
SENIOR VICE PRESIDENT  
+1 425 462 6928  
PETE.HOLLOMON@CBRE.COM

© 2019 CBRE, Inc. All rights reserved. This information has been obtained from sources believed reliable, but has not been verified for accuracy or completeness. Any projections, opinions, or estimates are subject to uncertainty. The information may not represent the current or future performance of the property. You and your advisors should conduct a careful, independent investigation of the property and verify all information. Any reliance on this information is solely at your own risk. CBRE and the CBRE logo are service marks of CBRE, Inc. and/or its affiliated or related companies in the United States and other countries. All other marks displayed on this document are the property of their respective owners. Photos herein are the property of their respective owners and use of these images without the express written consent of the owner is prohibited. PMStudio\_Jan2019

**CBRE**