

# FOR LEASE



## 10 S ACADEMY STREET | GREENVILLE, SC 29601

**Keith Jones, CCIM, SIOR**  
keith@naiearlearfurman.com  
864 678 5932

**Patrick McNeil Epps**  
mepps@naiearlearfurman.com  
864 678 5956

**Hunter Garrett, CCIM, SIOR**  
hgarrett@naiearlearfurman.com  
864 678 5934

**NAI Earle Furman**  
101 E. Washington Street, Suite 400  
Greenville, SC 29601 864 232 9040



# FOR LEASE

10 S ACADEMY STREET | GREENVILLE, SC 29601

## OFFICE HIGHLIGHTS

- Three story office building
- **Available: Suite 200 = 12,445 SF**
- Suite 250 available soon (5,329 SF)
- Plenty of onsite parking
- Located in Greenville's CB District
- Pedestrian access to downtown
- Traffic count: N. Academy Street 28,400 vpd
- Existing tenants include: AGFA Corporation, Eastland Management, Foster Victor Wealth Advisors, Standard Constructors, Inc. & Health Plans, Inc.
- Lease rate: \$24.50/SF FSG





# FOR LEASE

10 S ACADEMY STREET | GREENVILLE, SC 29601

## PROPERTY PHOTOS

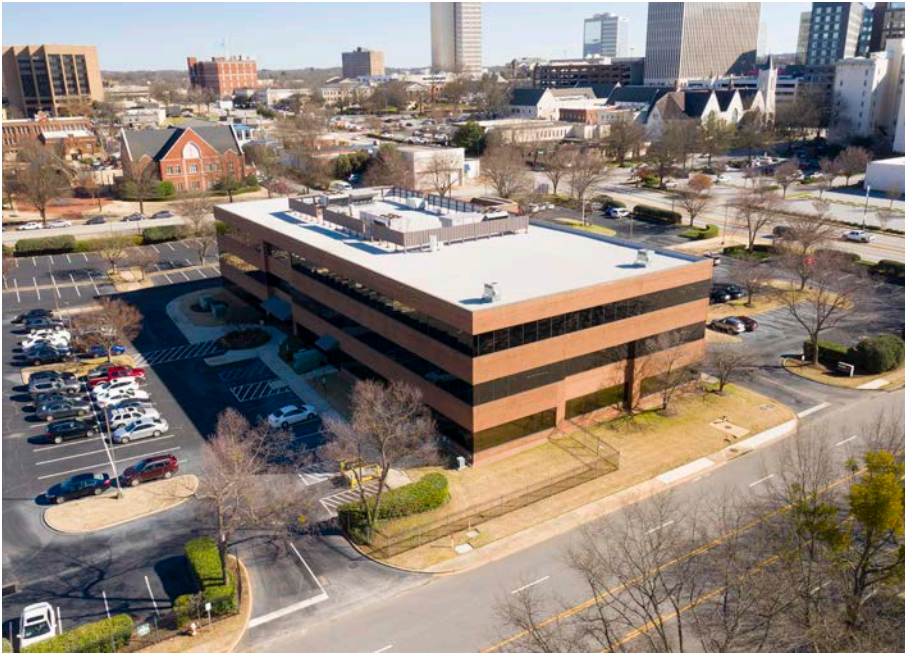



# FOR LEASE

10 S ACADEMY STREET | GREENVILLE, SC 29601

**Available** = ±12,445 SF (Suite 200)

**Sublease Space** = ±5,329 SF (Suite 250)

**Entire Floor** = ±17,774 SF

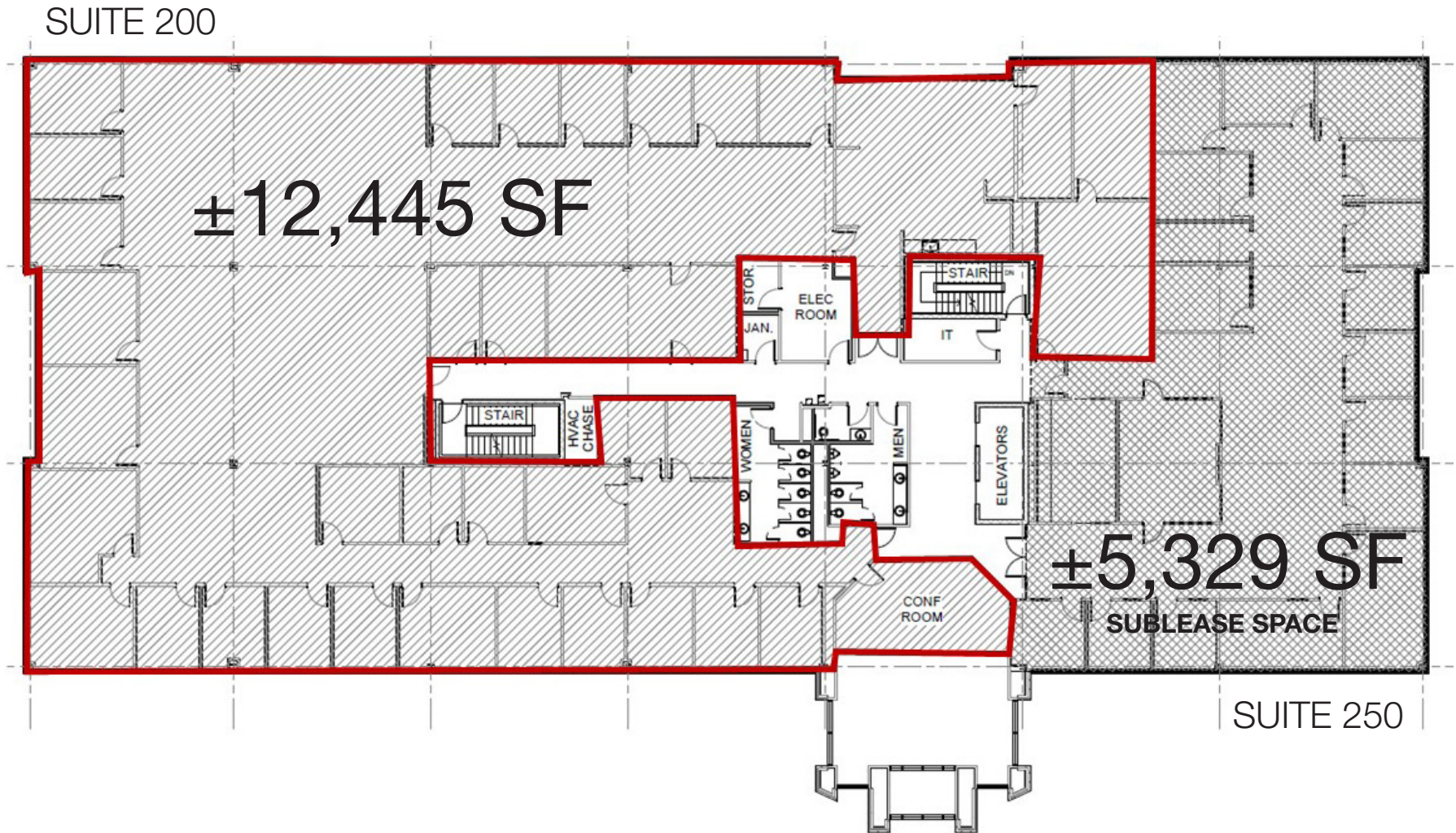

# FOR LEASE

10 S ACADEMY STREET | GREENVILLE, SC 29601

## SITE PLAN

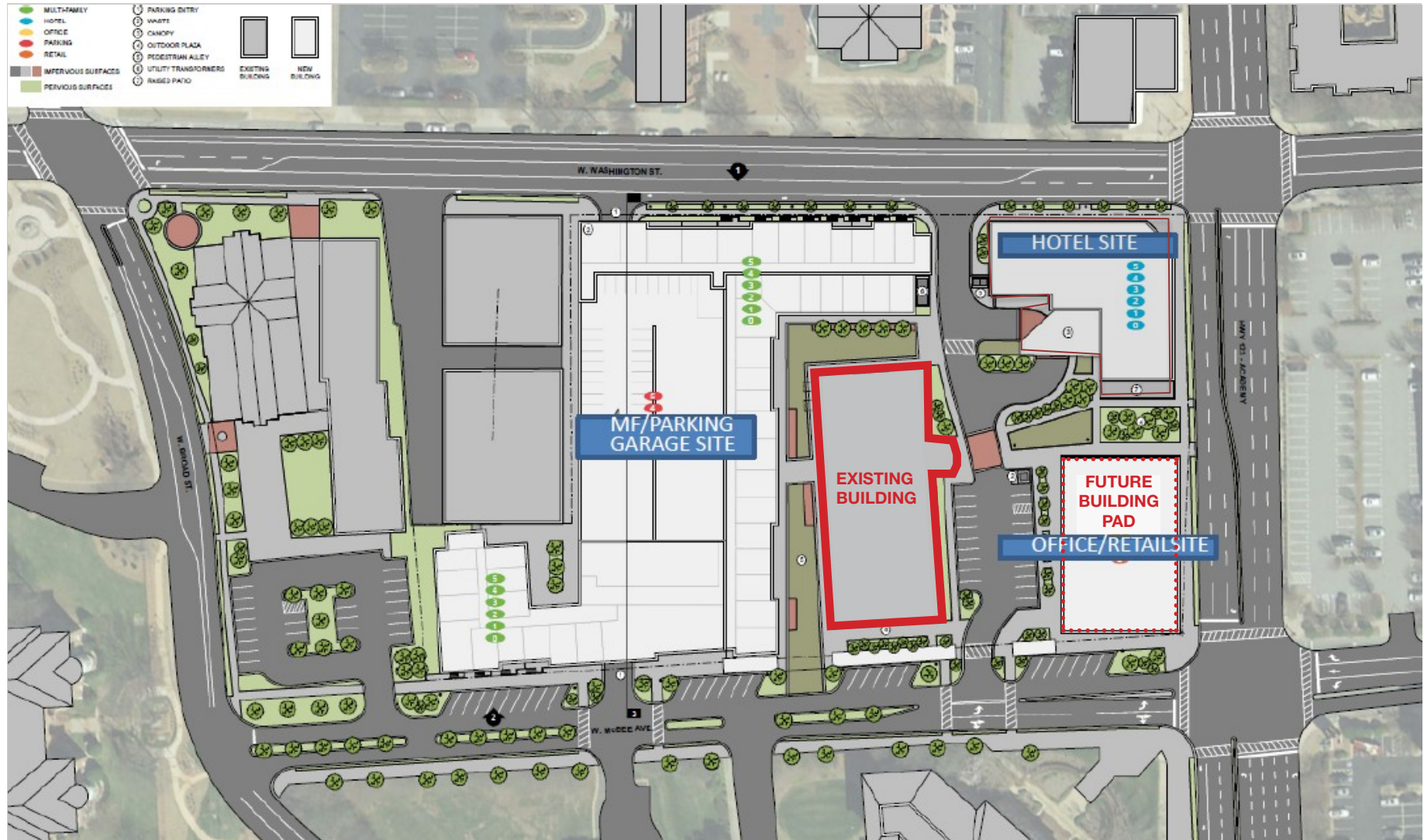



# FOR LEASE

10 S ACADEMY STREET | GREENVILLE, SC 29601

