

# 18322 Governors Highway

Homewood, IL 60430 | Cherry Creek Shopping Center

## For Lease

Retail Property



- ▶ ±1,500 SF outlot endcap available
- ▶ Cherry Creek Shopping Center is anchored by Walgreens and Ace Hardware
- ▶ Located on Governors Highway with visibility on 183rd Street (29,900 combined VPD)
- ▶ Co-tenants in outlot are Pop's Beef and Forever Yogurt
- ▶ Area Tenants include Big Lots, Jewel-Osco, Walt's Food Center, Panera Bread, Subway, McDonald's, Burger King, Bank of America, Edible Arrangements and more

### DEMOGRAPHICS

	1 MILE	3 MILES	5 MILES
Estimated Population	12,428	83,229	196,521
Adj. Daytime Demographics	11,570	80,286	194,663
Estimated Households	4,828	30,098	68,624
Estimated Average Household Income	\$100,396	\$87,552	\$74,886

#### DOUG RENNER

312.275.3137  
doug.renner@baumrealty.com

#### MARK FREDERICKS

312.275.3109  
mark@baumrealty.com



© 2018 All information supplied is from sources deemed reliable and is furnished subject to errors, omissions, modifications, removal of the listing from sale or lease, and to any listing conditions, including the rates and manner of payment of commissions for particular offerings, the terms of which are available to principals or duly licensed brokers. Any square footage dimensions set forth are approximate.

# 18322 Governors Highway

Homewood, IL 60430 | Cherry Creek Shopping Center

## For Lease

Retail Property

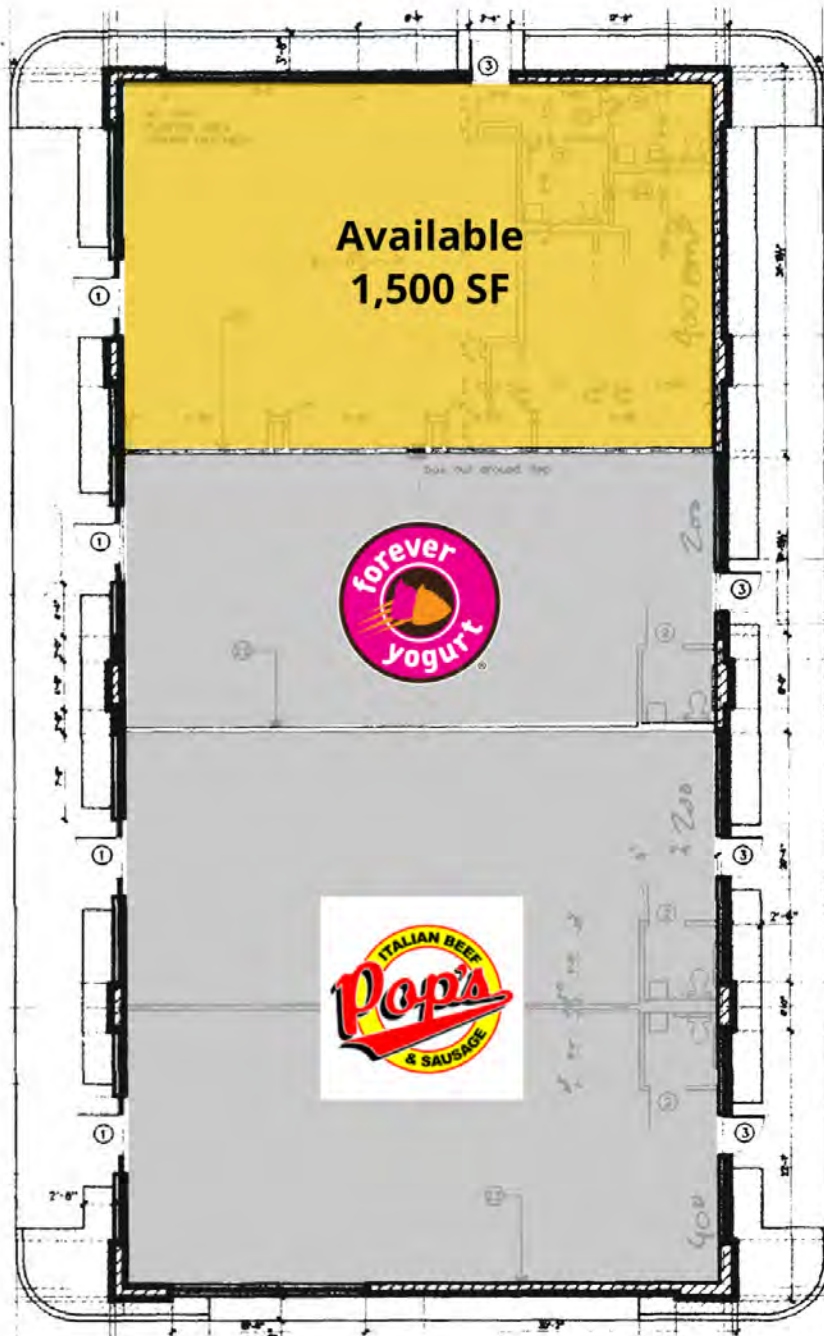

**DOUG RENNER**  
312.275.3137  
doug.renner@baumrealty.com

**MARK FREDERICKS**  
312.275.3109  
mark@baumrealty.com



© 2018 All information supplied is from sources deemed reliable and is furnished subject to errors, omissions, modifications, removal of the listing from sale or lease, and to any listing conditions, including the rates and manner of payment of commissions for particular offerings, the terms of which are available to principals or duly licensed brokers. Any square footage dimensions set forth are approximate.



18322 Governors Highway  
Homewood, IL 60430



Google

Map data ©2018 Google Imagery ©2018 , DigitalGlobe, U.S. Geological Survey, USDA Farm Service Agency



© 2018 All information supplied is from sources deemed reliable and is furnished subject to errors, omissions, modifications, removal of the listing from sale or lease, and to any listing conditions, including the rates and manner of payment of commissions for particular offerings, the terms of which are available to principals or duly licensed brokers. Any square footage dimensions set forth are approximate.

