

## Creative Office For Lease

# Scripps Lake Office Plaza ±3,627 RSF Available (Divisible)

9810 Scripps Lake Drive, San Diego, CA 92131



### ASKING RATE

- \$2.50 + Utilities PSF/Mo

### PROPERTY DETAILS

- An approximately 13,628 SF Class “A” creative office building
- ±3,627 RSF (Divisible); Available now
- Modern architecture
- Prominent building location at the center of Scripps Lake Drive and Trenea Street
- On-site showers
- Close proximity to multiple restaurants, retail centers, fitness centers and Mira Mesa Market Center (500,000 SF)

# Voit

REAL ESTATE SERVICES

Real People. Real Solutions.®

### BRANDON KEITH

858.458.3326

Lic. #01177792

bkeith@voitco.com

### RYAN BRACKER

858.458.3355

Lic. #01353870

rbracker@voitco.com

4180 La Jolla Village Dr, Ste.100  
La Jolla, California 92037  
858.453.0505 | 858.408.3976 Fax  
Lic #01333376 | [www.voitco.com](http://www.voitco.com)

Licensed as a Real Estate Broker and Salesperson by the CA Bar of Real Estate. The information contained herein has been obtained from sources we deem reliable. While we have no reason to doubt its accuracy, we do not guarantee it. ©2014 Voit Real Estate Services, Inc. All Rights Reserved. Real People. Real Solutions.® is a registered trademark of Voit Real Estate Services.

## PLAZA LOCATION

Scripps Lake Office Plaza is located in Scripps Ranch, just northeast of San Diego. This building stands prominently at the corner of Scripps Lake Drive and Treena Street.

## PLAZA DESCRIPTION

Scripps Lake Office Plaza features dramatic angled geometry and a striking use of bold color, and stands prominently at the corner of Scripps Lake Drive and Treena Street in Northeast San Diego. The two story office project provides approximately 13,628 SF of office space, and the development includes approximately 31,000 SF of site area to support the office, including 45 parking spaces, landscaping, and site and accent lighting. The design features a 2,500 SF landscaped entry courtyard with eastern exposure serving as the front door to the office suites.

## SITE PLAN



SUITES A & B: ±3,627 RSF (DIVISIBLE)  
AVAILABLE NOW

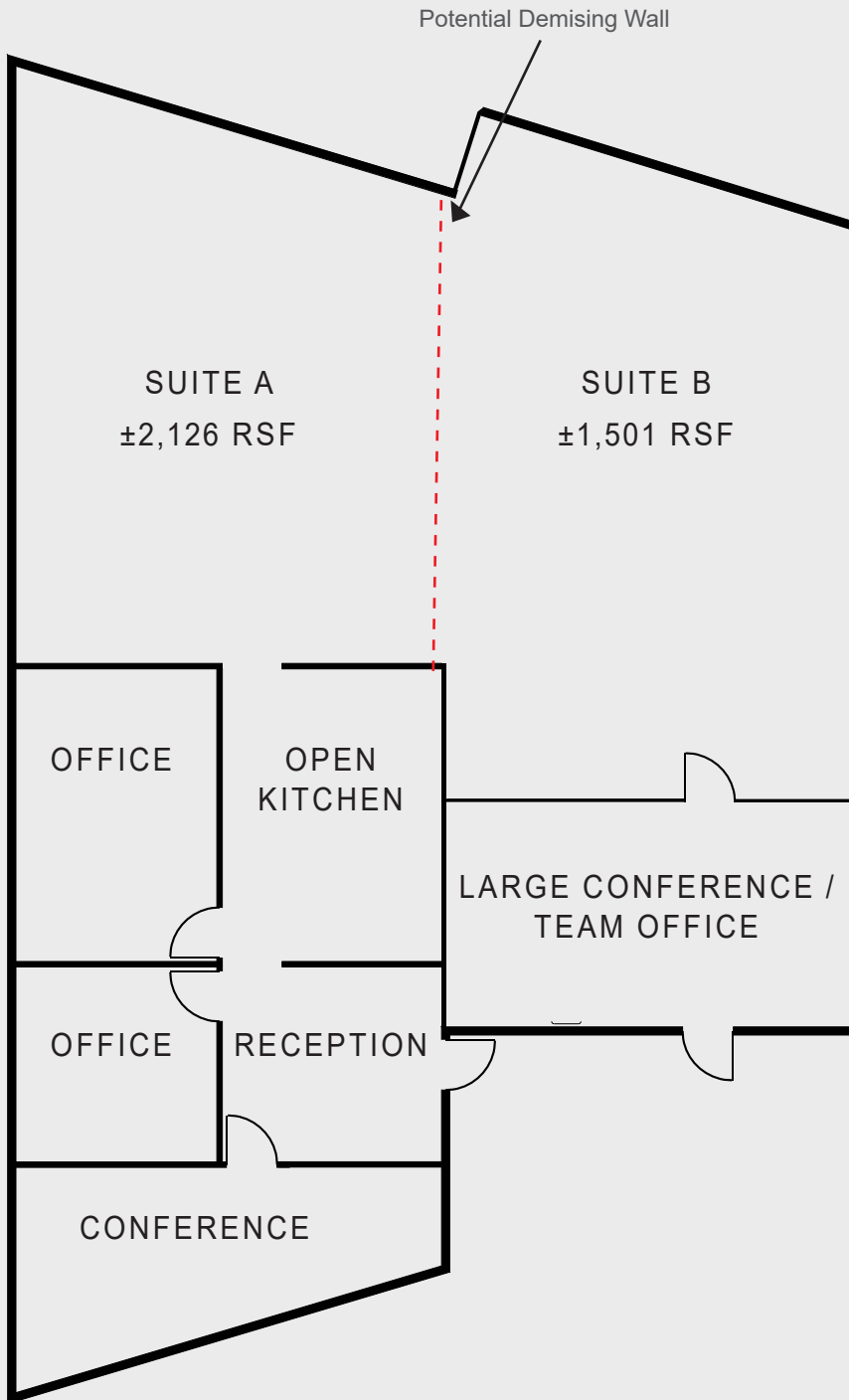

For Lease

# Scripps Lake Office Plaza

9810 Scripps Lake Drive | San Diego, CA

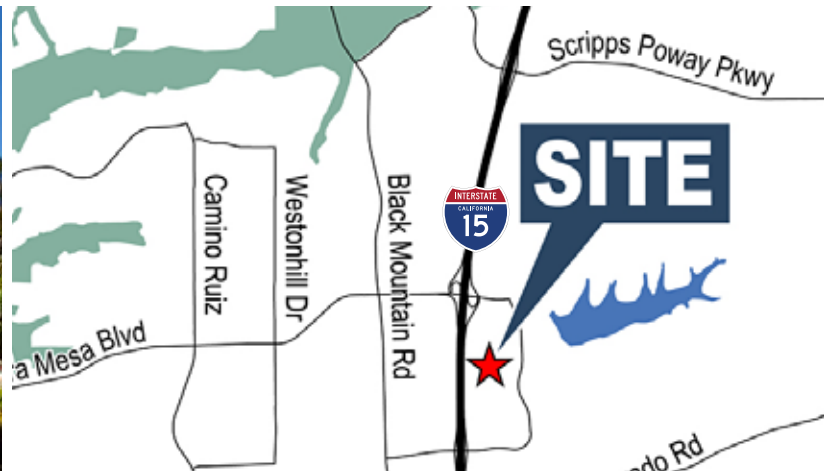

**BRANDON KEITH**  
858.458.3326  
Lic. #01177792  
bkeith@voitco.com

**RYAN BRACKER**  
858.458.3355  
Lic. #01353870  
rbracker@voitco.com

4180 La Jolla Village Drive, Suite 100, La Jolla, CA 92037  
858.453.0505 | 858.408.3976 Fax | Lic #01333376 | [www.voitco.com](http://www.voitco.com)

Licensed as a Real Estate Broker and Salesperson by the CA Bur of Real Estate. The information contained herein has been obtained from sources we deem reliable. While we have no reason to doubt its accuracy, we do not guarantee it. ©2014 Voit Real Estate Services, Inc. All Rights Reserved. Real People. Real Solutions.® is a registered trademark of Voit Real Estate Services.

# Voit

REAL ESTATE SERVICES

Real People. Real Solutions.®