

12550

STOWE DRIVE

FOR SALE - POWAY



Voit

REAL ESTATE SERVICES

PROPERTY FEATURES

12550 Stowe Drive is a 12,348 square foot freestanding industrial/flex building located in the Poway Industrial Park. The property offers excellent accessibility to Scripps Poway Parkway along with the following features:

- 12,348 Rentable Square Feet
- 0.75 Acres (32,670 SF)
- 2.0/1,000 Parking Ratio (25 Parking Spaces)
- 100% HVAC
- Extensive Electrical Drops
- 1 Grade Level Door and 1 Dock Well
- Zoned LI
- Fenced Yard
- 20% Office, 80% HVAC Production Area
- Interior cage



12550 STOWE DRIVE



SALE PRICE

- **SALE PRICE:** \$2,160,000 (\$175/SF)

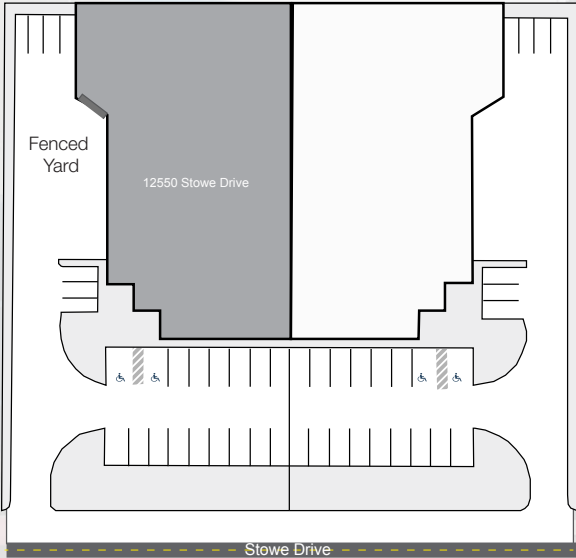
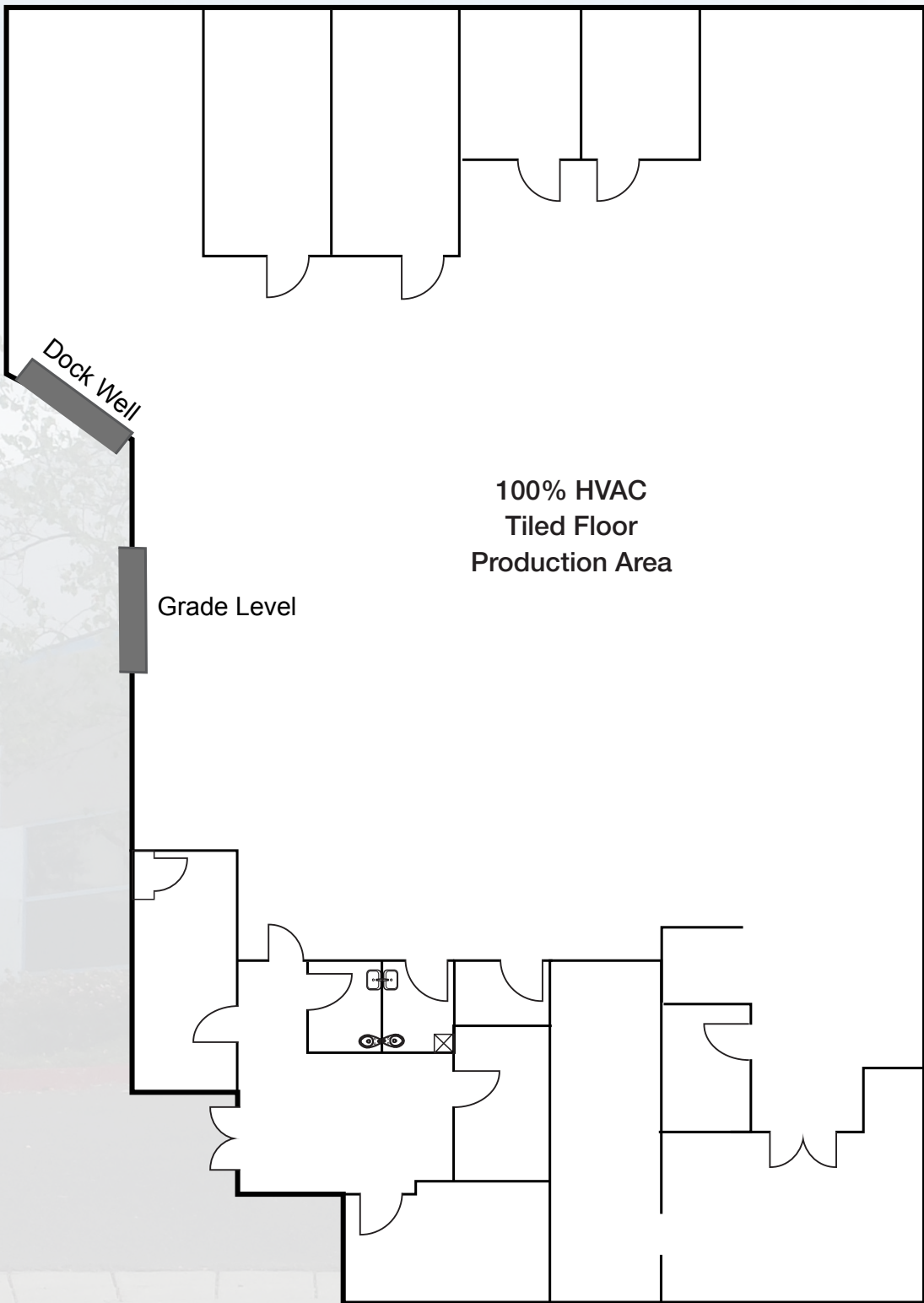

RANDY LACHANCE

Senior Vice President

858.458.3374 [Direct]

rlachance@voitco.com

Lic. No. 00969674

GREG MARX

Associate

858.458.3302 [Direct]

gmarx@voitco.com

Lic. No. 019406964

12550

STOWE DRIVE



RANDY LACHANCE
Senior Vice President
858.458.3374 [Direct]
rlachance@voitco.com
Lic. No. 00969674

GREG MARX
Associate
858.458.3302 [Direct]
gmarx@voitco.com
Lic. No. 01940696

Voit

REAL ESTATE SERVICES

4747 Executive Drive, Suite 800, San Diego, CA 92121 • 858.453.0505 • 858.408.3976 Fax • Lic #01333376 | www.voitco.com

Licensed as Real Estate Salespersons by the CA Bar of Real Estate. The information contained herein has been obtained from sources we deem reliable. While we have no reason to doubt its accuracy, we do not guarantee it.
©2015 Voit Real Estate Services, Inc. All Rights Reserved. Real People. Real Solutions.® is a registered trademark of Voit Real Estate Services.