

NOTES:

ALL SEWER UNDER PAVEMENT SHALL HAVE MECHANICALLY COMPACTED GRANULAR TRENCH BACKFILL.

ASPHALT PAVING TO BE 4" BITUMINOUS PAVEMENT OVER 10" CRUSHED STONE BASE.

PCC PAVING TO BE 7" PCC PAVEMENT.

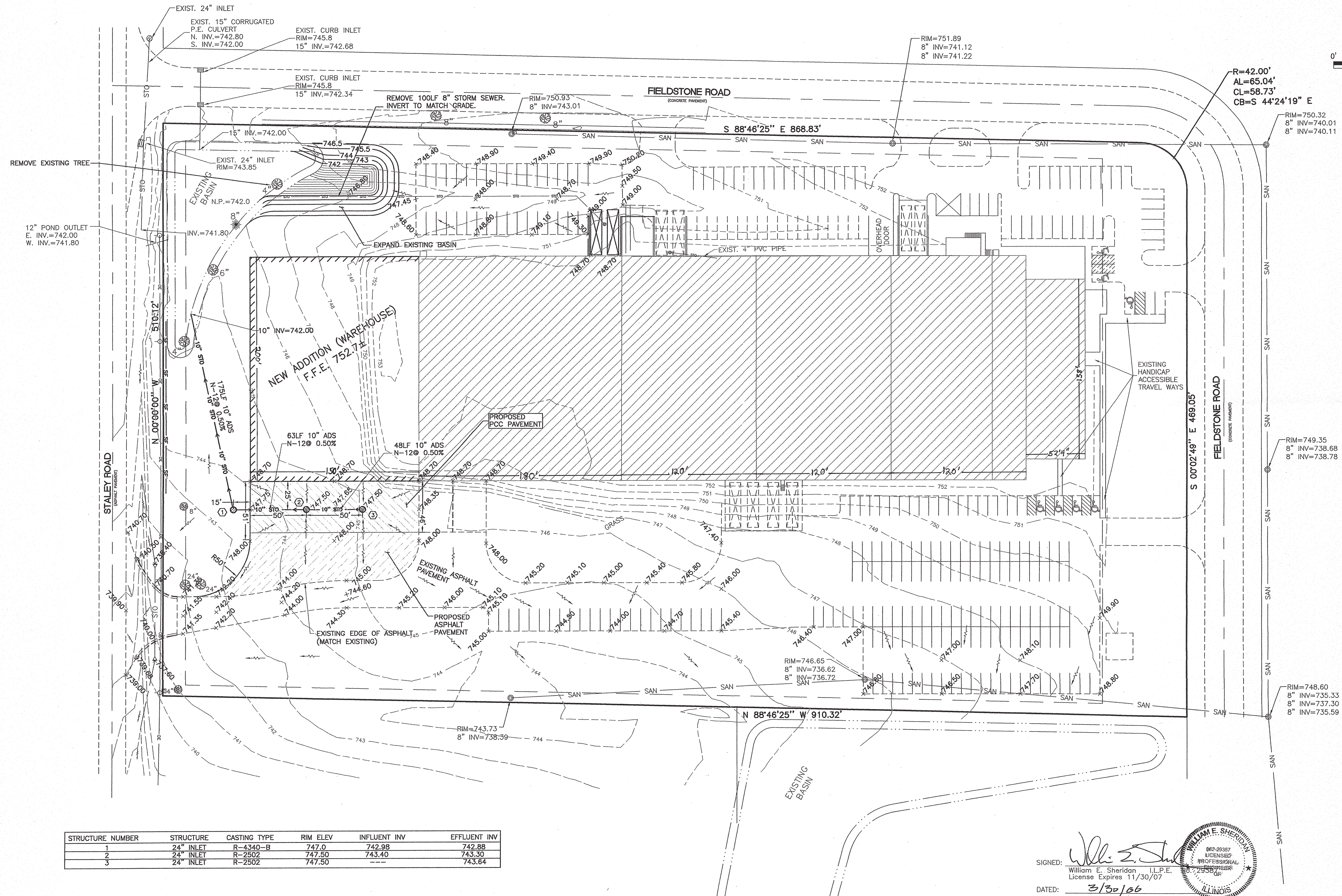

STRUCTURE NUMBER	STRUCTURE	CASTING TYPE	RIM ELEV	INFLUENT INV	EFFLUENT INV
1	24" INLET	R-4340-B	747.0	742.98	742.88
2	24" INLET	R-2502	747.50	743.40	743.30
3	24" INLET	R-2502	747.50	---	743.64

SIGNED: *William E. Sheridan*
 William E. Sheridan I.L.P.E.
 License Expires 11/30/07
 DATED: 3/30/06

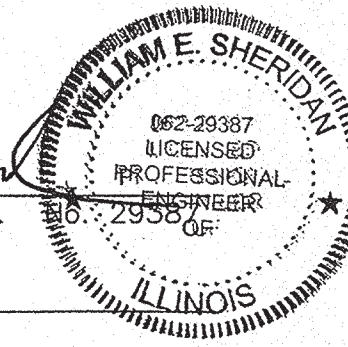

**HORIZON HOBBIES
 SITE PLAN
 CHAMPAIGN COUNTY, ILLINOIS**

PROJECT NO. 04134	DATE: 2/28/06	DRAWN BY: CMO	CHECKED: WES
REVISIONS	NO.	DATE	BY
	1	3/30/06	CMO
			REMARKS
			REVISED BASIN



Professional Design Firm License No. 184-003223 Expires: 04/30/2007
 201 West Springfield, Suite 300, P.O. Box 140, Champaign, Illinois 61824-0140
 217-352-8976 217-356-0953 FAX 217-356-0570