

304 Park Avenue South

FLATIRON
NEW YORK, NY



NEWMARK

304 PARK AVENUE SOUTH

Property Details

Location

23rd Street between Park Avenue South and Broadway

Approximate Size

Ground Floor 1,715 SF

Frontage

27 FT on 23rd Street

Possession

Immediate

Site Status

Formerly Fields Good Chicken

Neighbors

Shake Shack, Starbucks, Walgreens, Dos Toros, Zucker's, Krispy Kreme, Sticky's, McDonald's, Chop't and DIG

Comments

Turn-key vented QSR opportunity

Located across from One Madison, a 1.4M SF office development that will have 4,000 employees within the building upon completion (Q3 2023)

Ideally positioned next to the 23rd Street 6 train subway station

Situated on a busy 7-day-a-week thoroughfare

Ground Floor

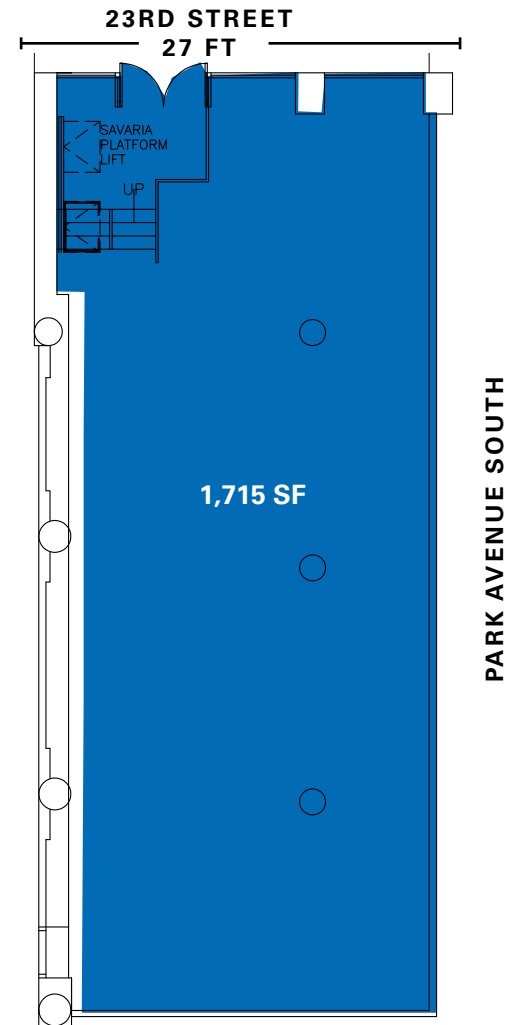

Area Photos



304 PARK AVENUE SOUTH



+ COMING SOON

CONTACT

Adam Weinblatt

t 212-372-2103

adam.weinblatt@nmrk.com

nmrk.com