

# 946

*west randolph*

Fulton Market, Chicago, IL

Corner Second Level Office/Retail Opportunity  
3,407 SF with Dedicated Entryway



**CBRE**



# floorplans

Please note that the first level space of 1,460 SF can be added for a two level presence



FIRST FLOOR

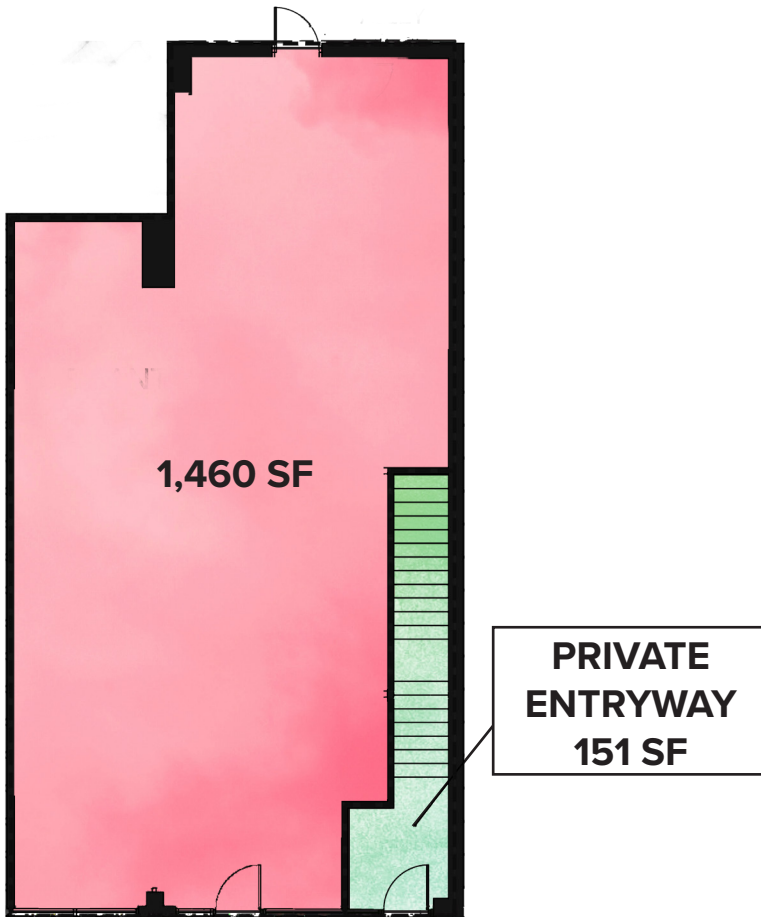

SECOND FLOOR



RANDOLPH ST.

# "main & main" location

3,407 SF Second Level with Private Entryway

High Ceilings and Corner Presence with Great Light

Located next to Starbucks and the Highly Anticipated Future Tex-Mex Restaurant from the Owners of Parlor Pizza

± 1,200 Hotel Rooms within One Mile

One block from the CTA Morgan "L" stop (Pink & Green Lines) with ±900,000 Riders per Year

Two blocks from both Google's and McDonald's HQs

## Demographics Within . 5 Mi



POPULATION  
**14,667**



DAYTIME POPULATION  
**31,520**



MEDIAN AGE  
**35**

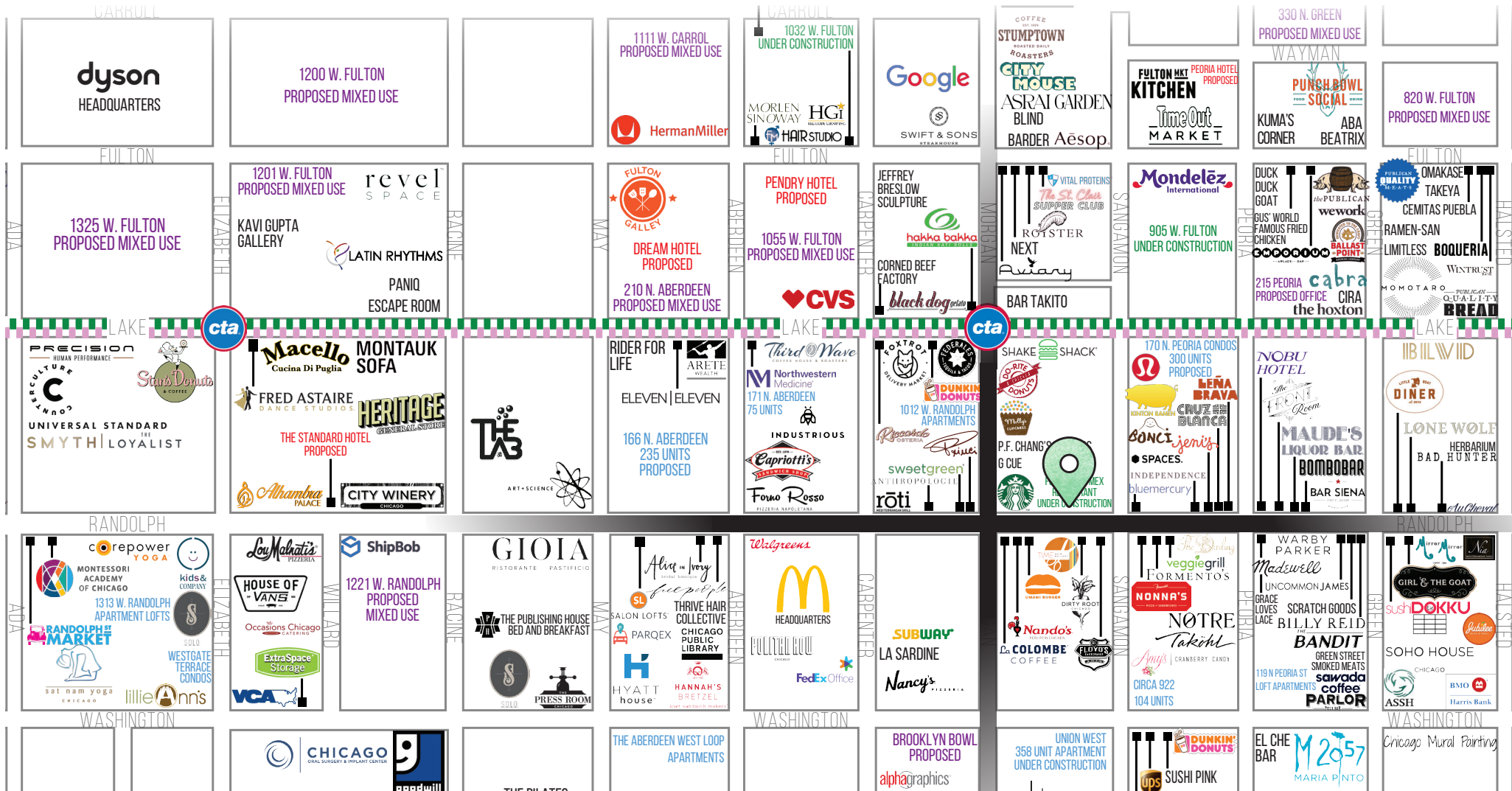

by the block

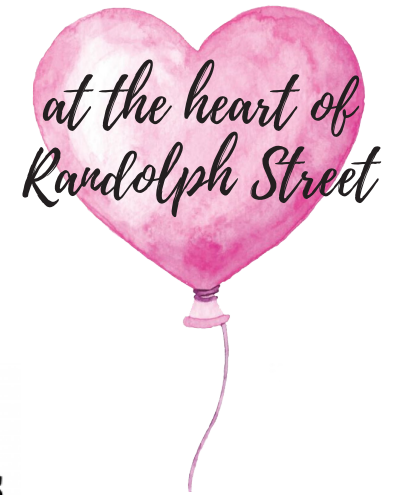

within one block



La COLOMBE



rōti  
MEDITERRANEAN GRILL

SHAKE SHACK



P.F. CHANG'S  
veggiegrill

within two blocks

ANTHROPOLOGIE

BILLY REID

CLUB MONACO



BAR ★ SIENA

bluemercury®  
makeup • skincare • spa

Forno Rosso  
PIZZERIA NAPOLETANA

free people



FORMENTO'S

LEÑA  
BRAVA



INDEPENDENCE

J.P. GRAZIANO  
GROCERY Co., Inc.

MAUDE'S  
LIQUOR BAR

NOBU  
HOTEL

Walgreens

WARBY PARKER



# 946

*west randolph*

for more information please contact:

**Sharon Kahan**  
**First Vice President**  
**312.297.7679**

**sharon.kahan@cbre.com**

**Amy Sider**  
**First Vice President**  
**312.935.1909**

**amy.sider@cbre.com**

**CBRE**