

For Lease

5% SUMMER BONUS ON ALL DEALS SIGNED BY LABOR DAY



1321 Rutherford Lane
Austin, Texas 78753

PROPERTY OVERVIEW

Space Available	Suite 170/180 3,000 - 9,450 SF
Rate	Negotiable
Operating Expenses	\$4.61 PSF Year EST.

Building features:

- Rear Loading; Semi Dock - Grade Level Doors
- 18' Clear Height
- 1 Ramp
- Sprinklered
- Dropped Ceiling
- 100% Climate Controlled
- 3 Phase 480 Volt Service
- Available Now



FOR MORE INFORMATION

Ace Schlameus
512.225.2709

Ace.Schlameus@am.jll.com

Kyle McCulloch
512.225.2713

Kyle.McCulloch@am.jll.com

Dalfen
INDUSTRIAL

SUITE 170/180 | 9,450 SF
GLOBAL BUSINESS PARK B

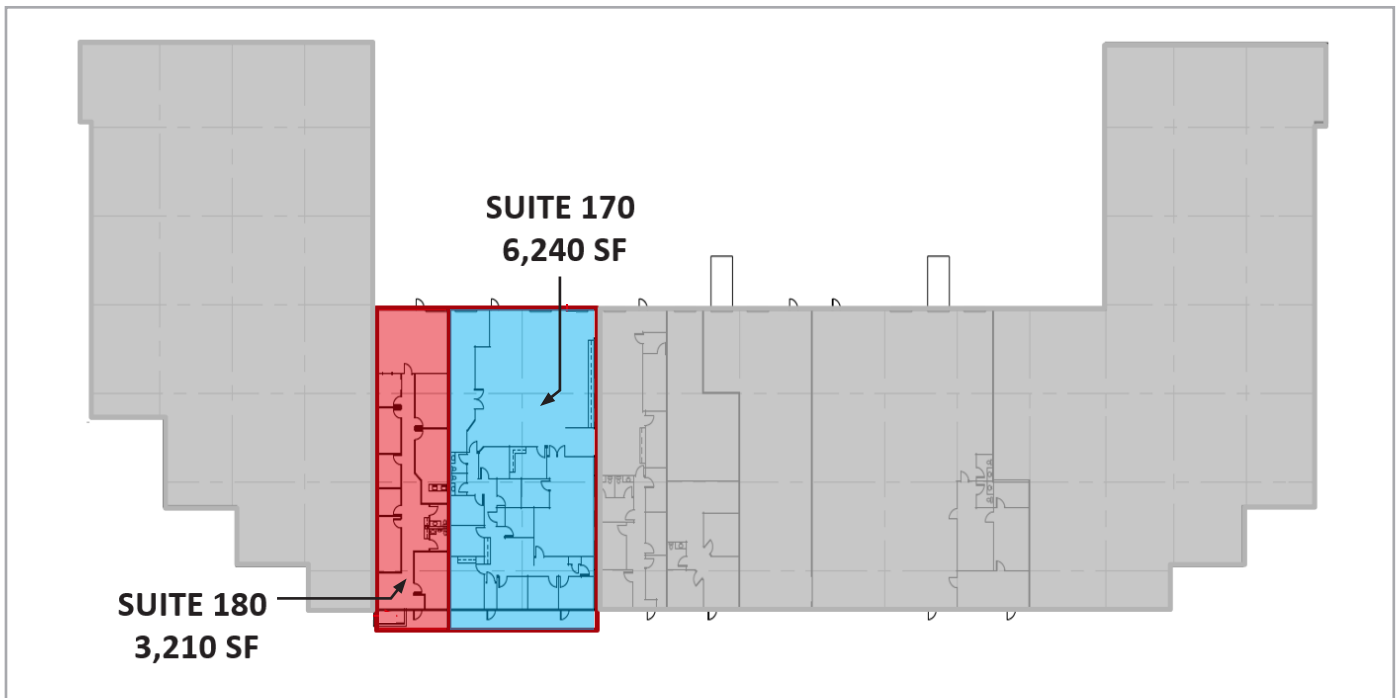

 **JLL**® Ace Schlameus 512.225.2709
Ace.Schlameus@am.jll.com Kyle McCulloch 512.225.2713
Kyle.McCulloch@am.jll.com

Dalfen
INDUSTRIAL