

FOR SALE/LEASE

Whitney Mesa Business Park II

1840 Whitney Mesa Dr., Henderson, NV 89014

Under New Ownership



THE BROOKHOLLOW GROUP



FOR SALE \$943,785 (\$135/SF)

- 6,991 SF freestanding office building
- Built in 2008 - First generation build-out
- Move-in ready high image office space in Green Valley
- Extensive windows for natural light
- Break room & kitchenette with refrigerators, microwaves & built-in cabinets
- 25 parking spaces, including 3 covered spaces
- Occupy whole building or lease out suite(s) to offset ownership costs
- Also For Lease: \$0.79/SF + \$0.21/SF NNN (est.)
- Asking Price: \$943,785 (\$135/SF)



Jennifer Levine
Senior Associate
Lic # S.0067711
702.734.4523
jlevine@voitco.com

Kevin J. Higgins, SIOR
Executive Vice President
Lic #B.0016109.CORP
702.734.4555
khiggins@voitco.com

Garrett Toft
Senior Vice President
Lic #BS.0061824
702.734.4503
gtoft@voitco.com

Zac Zaher
Associate
Lic #BS.0143683
702.734.4544
zzaher@voitco.com

Voit
REAL ESTATE SERVICES

6385 S. Rainbow Blvd., Suite 100, Las Vegas, NV 89118
702.734.4500 Tel | 702.733.7690 Fax | Lic #01333376 | www.voitco.com

FOR SALE/LEASE

Whitney Mesa Business Park II

1840 Whitney Mesa Dr., Henderson, NV 89014

Under New Ownership



THE BROOKHOLLOW GROUP

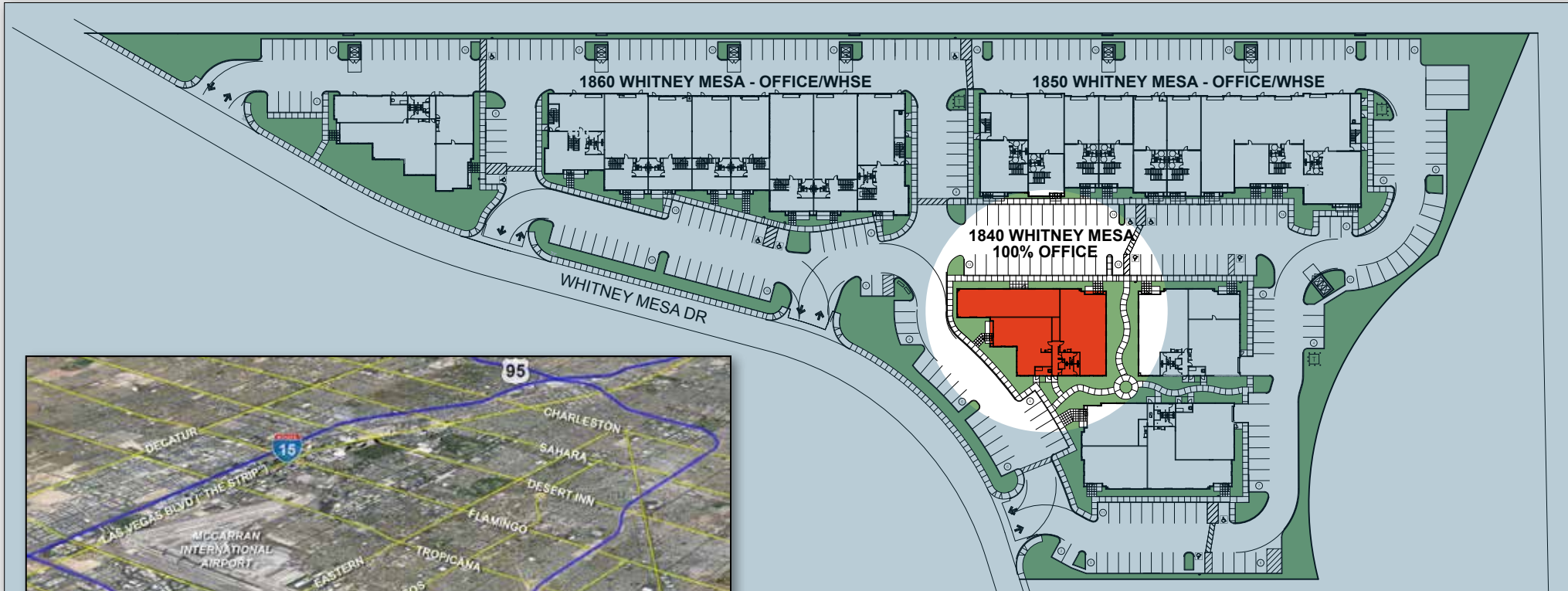

FOR SALE			
Total SF	Parking Spaces	Price/SF	Total Asking Price
6,991	25	\$135	\$943,785

Jennifer Levine
Senior Associate
Lic # S.0067711
702.734.4523
jlevine@voitco.com

Kevin J. Higgins, SIOR
Executive Vice President
Lic #B.0016109.CORP
702.734.4555
khiggins@voitco.com

Garrett Toft
Senior Vice President
Lic #BS.0061824
702.734.4503
gtoft@voitco.com

Zac Zaher
Associate
Lic #BS.0143683
702.734.4544
zzaher@voitco.com

Voit

REAL ESTATE SERVICES

6385 S. Rainbow Blvd., Suite 100, Las Vegas, NV 89118
702.734.4500 Tel | 702.733.7690 Fax | Lic #01333376 | www.voitco.com

FOR SALE/LEASE

Whitney Mesa Business Park II

1840 Whitney Mesa Dr., Henderson, NV 89014

Under New Ownership



THE BROOKHOLLOW GROUP

6,991 SQUARE FEET

- New state-of-the-art freestanding office building built in 2008 including Class A tenant improvements
- Move-in ready high image office space in Green Valley
- Extensive windows for natural light
- Break room & kitchenette with refrigerators, microwaves, & built-in cabinets
- 25 parking spaces, including 3 covered spaces
- Occupy whole building or lease out suite(s) to offset ownership costs
- Also For Lease: \$0.79/SF + \$0.21/SF NNN (est.)
- Asking Price: \$943,785 (\$135/SF)

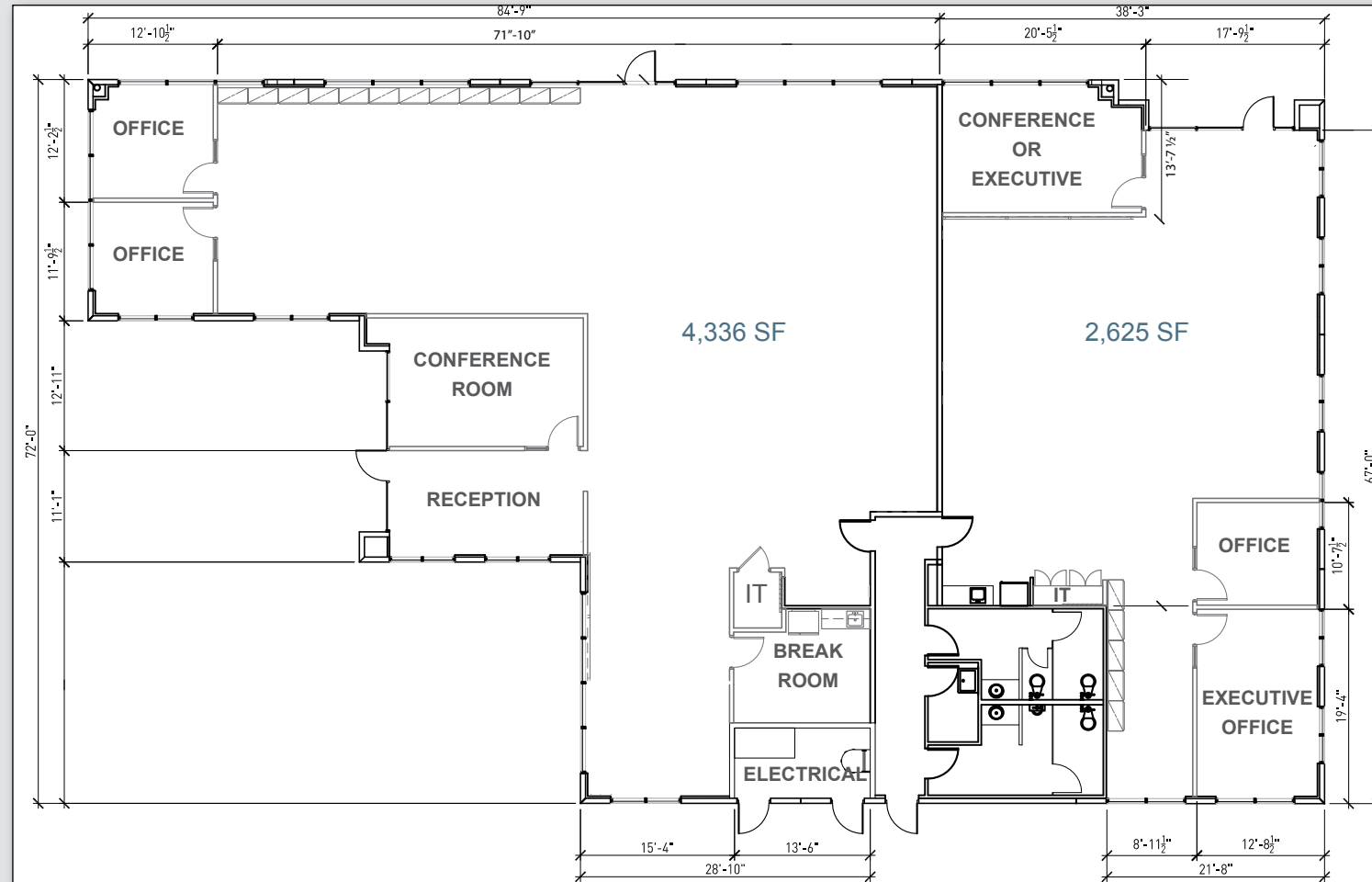

Jennifer Levine
Senior Associate
Lic # S.0067711
702.734.4523
jlevine@voitco.com

Kevin J. Higgins, SIOR
Executive Vice President
Lic #B.0016109.CORP
702.734.4555
khiggins@voitco.com

Garrett Toft
Senior Vice President
Lic #BS.0061824
702.734.4503
gtoft@voitco.com

Zac Zaher
Associate
Lic #BS.0143683
702.734.4544
zzaher@voitco.com

Voit
REAL ESTATE SERVICES

6385 S. Rainbow Blvd., Suite 100, Las Vegas, NV 89118
702.734.4500 Tel | 702.733.7690 Fax | Lic #01333376 | www.voitco.com

FOR SALE/LEASE

Whitney Mesa Business Park II

1840 Whitney Mesa Dr., Henderson, NV 89014

Under New Ownership



THE BROOKHOLLOW GROUP



Jennifer Levine
Senior Associate
Lic # S.0067711
702.734.4523
jlevine@voitco.com

Kevin J. Higgins, SIOR
Executive Vice President
Lic #B.0016109.CORP
702.734.4555
khiggins@voitco.com

Garrett Toft
Senior Vice President
Lic #BS.0061824
702.734.4503
gtoft@voitco.com

Zac Zaher
Associate
Lic #BS.0143683
702.734.4544
zzaher@voitco.com

Voit
REAL ESTATE SERVICES

6385 S. Rainbow Blvd., Suite 100, Las Vegas, NV 89118
702.734.4500 Tel | 702.733.7690 Fax | Lic #01333376 | www.voitco.com