

# LAKEWOOD OFFICE SPACE AVAILABLE

1200 S. Wadsworth Blvd., Lakewood, CO 80232



www.FullerRE.com



<b>Lease Rate:</b>	<b>\$12.00/SF Full Service Gross</b>
<b>Available:</b>	1,000± SF (Suite 300)
<b>Parking:</b>	50 Surface Spaces (free)
<b>YOC:</b>	1974

This desirable Wadsworth Blvd. office building offers a comfortable office environment, a great Lakewood location with easy access to public transportation, and attractive lease rates. Only minutes from the Belmar Shopping District and 6th Avenue, offering a variety of nearby retail and restaurant amenities. Suite 300 is a 1,000 sq. ft. office with an open floorplan, two private offices, large conference table, kitchenette, and lots of natural lighting. Suitable for general or medical office use.



**Fuller Real Estate**  
(303) 534-4822

**Alex Scott**  
(720) 287-5417 direct  
(972) 207-8877 mobile  
AScott@FullerRE.com

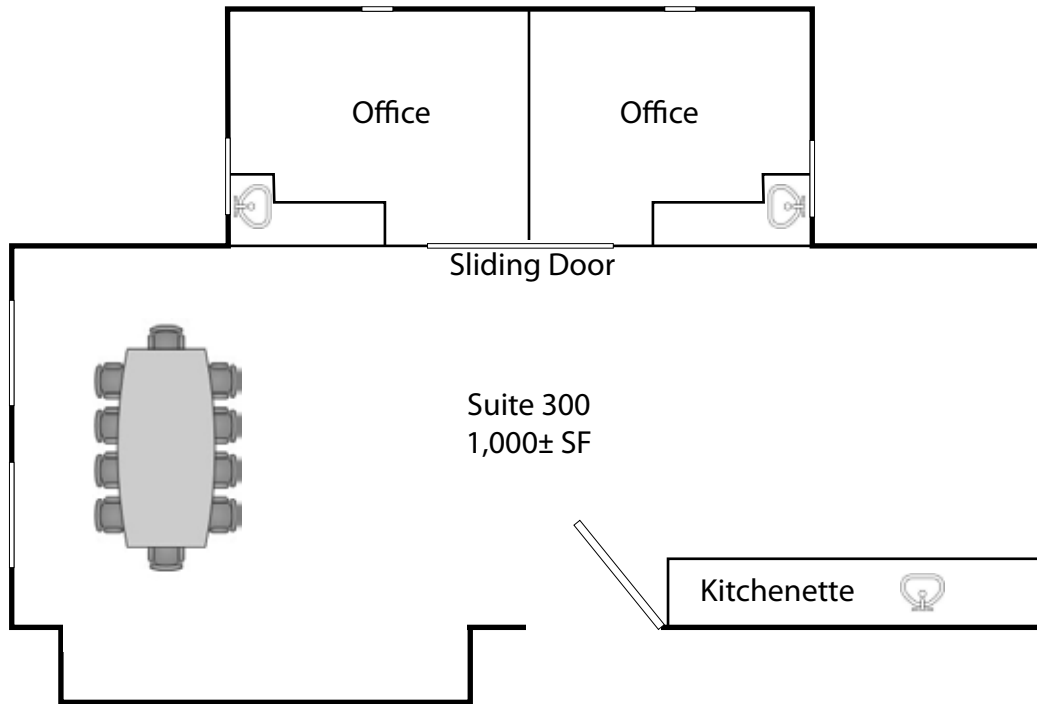

Floorplan is presented as a visual representation only and is most likely not completely accurate, nor is it to scale.

