

# congress & water streets

5,910 SF AVAILABLE  
ICONIC CORNER AT  
POST OFFICE SQUARE

RETAIL SPACE  
FOR LEASE

# Congress Square

# FOOD + BEVERAGE

SURROUNDED BY AN IMPRESIVE MIX OF THE BEST F&B IN THE CITY

## AREA EMPLOYERS

(1,000 AND ABOVE)



3,400 EMPLOYEES



STATE STREET

3,244 EMPLOYEES

BROWN BROTHERS HARRIMAN

1,500 EMPLOYEES



1,500 EMPLOYEES



1,200 EMPLOYEES



1,000 EMPLOYEES



1,100 EMPLOYEES



1,200 EMPLOYEES



1,000 EMPLOYEES

DIG INN

3 MIN

clover

4 MIN

BLUE BOTTLE COFFEE

5 MIN

marie!



5 MIN



4 MIN

Tatte BAKERY & CAFÉ

1 MIN

sweetgreen

2 MIN

Yvonne's

8 MIN

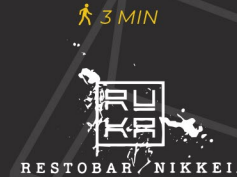

3 MIN

George Howell COFFEE

2 MIN



7 MIN

14 MIN

## HOTELS

## TRANSIT

STATE 2 MINS T

GOVERNMENT CENTER 5 MINS T

DOWNTOWN CROSSING 6 MINS T

SOUTH STATION 9 MINS T

HYATT CENTRIC

163 ROOMS  
2 MIN

HARBORSIDE

116 ROOMS  
6 MIN

MARRIOTT BOSTON LONG WHARF

412 ROOMS  
8 MIN

THE GODFREY HOTEL BOSTON

242 ROOMS  
8 MIN

INTERCONTINENTAL BOSTON

424 ROOMS  
8 MIN

THE LANGHAM

317 ROOMS  
4 MIN

congress  
& water  
streets



## 5,910 SF AVAILABLE NOW

### ICONIC CORNER AT POST OFFICE SQUARE

- Corner opportunity viable for multiple retail uses
- Frontage on both Water (XX feet) and Congress (XX feet) Streets, the main connectors between Downtown Crossing and the Financial District
- Situated at the top of Post Office Square, the heart of the neighborhood, with impressive visibility
- Key corner for both foot and vehicular traffic in Downtown Boston
- Meticulously preserved Historic space with large windows and natural light. Functional for modern retail uses
- Highly visible location with close proximity to key Downtown Boston nodes: Post Office Square, State Street, and Faneuil Hall
- Ample ceiling heights of 14-20' throughout space
- Walker's Paradise: 90 | Rider's Paradise: 100



IMMEDIATELY AVAILABLE

# STREET LEVEL

14-20' CEILING HEIGHTS

Congress  
& Water  
streets

CONGRESS STREET

WATER STREET

RESIDENTIAL

QUAKER LANE

HYATT  
CENTRIC

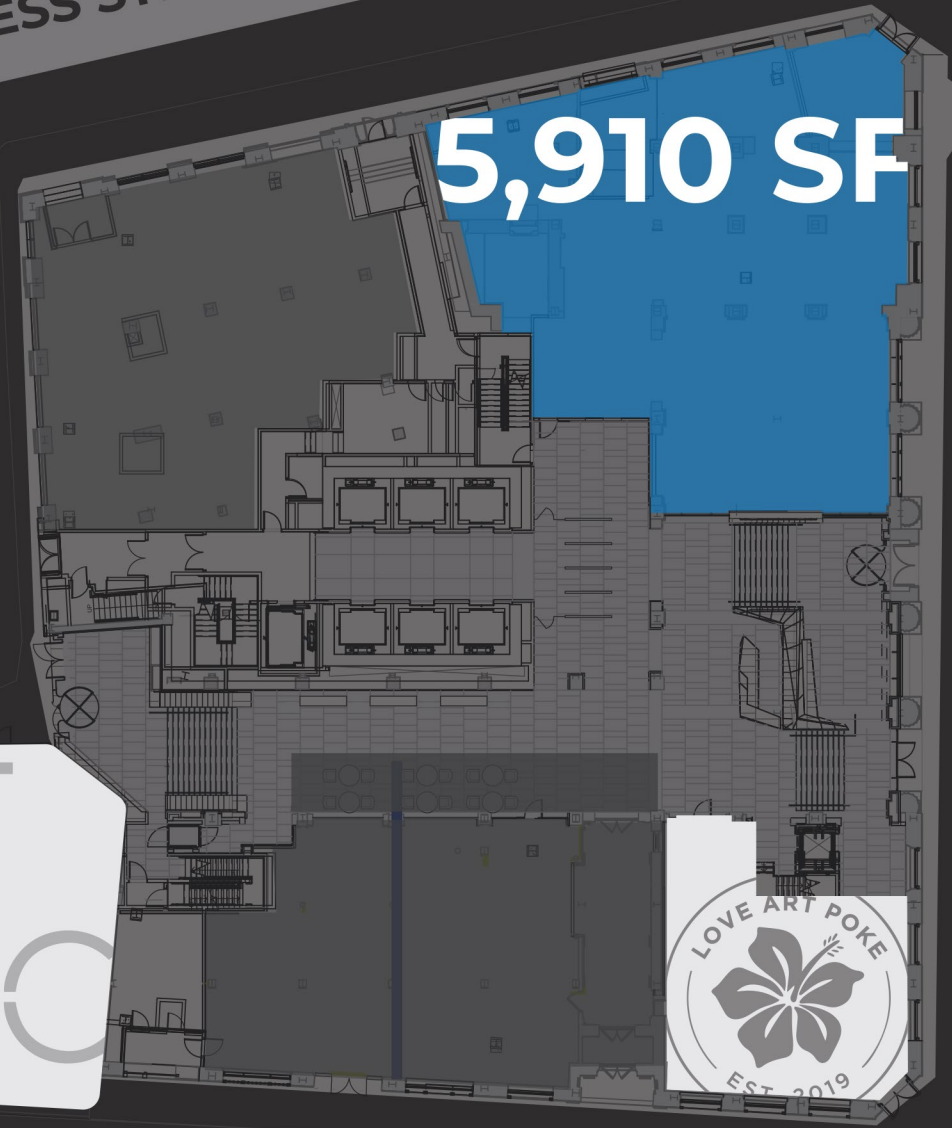

5,910 SF



DEVONSHIRE STREET

# DOWNTOWN BOSTON



GOVERNMENT CENTER  
10,828 DAILY RIDERS

GOVERNMENT CENTER  
CITY HALL

FANEUIL HALL  
18M VISITORS PER YEAR

MASSACHUSETTS  
STATE HOUSE

OMNI HOTELS & RESORTS  
551 ROOMS

NINE ZERO  
A KIMPTON HOTEL  
190 ROOMS

BOSTON  
COMMON

Peet's Coffee & Tea  
Capital One

PARK STREET  
19,653 DAILY RIDERS

STODDARD'S  
FINE FOOD & ALE

49  
SOCIAL  
FOOD & DRINK

THE GODFREY  
HOTEL CHICAGO  
242 ROOMS

GEORGE HOWELL  
COFFEE

SONOS  
375 EMPLOYEES

CARBONITE  
350 EMPLOYEES

BOSTON  
COMMON COFFEE CO.

thinkingcup

THE RITZ-CARLTON  
AMC THEATRES

BOYLSTON STREET  
6,826 DAILY RIDERS

sip  
WINE BAR • KITCHEN

EQUINOX

CHINATOWN  
6,498 DAILY RIDERS

MILLENNIUM PLACE  
256 CONDO UNITS  
COMPLETED IN 2013

LEGAL CROSSING  
CAFFÈ NERO

FOREVER 21

DOWNTOWN CROSSING  
23,478 DAILY RIDERS

CHASEO  
flying tiger  
MOUNTAIN WAREHOUSE

DSW  
GAP FACTORY

verizon  
CVS

Walgreens

b.good  
SPYCE  
DIG INN

sweetgreen  
clover

SHAKE SHACK  
GRE.CO

Marshall's  
TJ-maxx  
HomeGoods  
BSC

AT&T Wireless  
macy's

BARRY'S  
BOOTCAMP

HYATT REGENCY  
502 ROOMS

sweetgreen  
drybar

OGAWA COFFEE

PRET  
CAFFÈ NERO

HAVAS MEDIA  
PRIMARK  
Roche Bros.  
OLD NAVY

BLUE BOTTLE  
acaemia  
Bailey Sage

PRET  
Starbucks COFFEE  
oath  
DUNKIN' DONUTS

SOUTH STATION  
112,800 DAILY RIDERS

DAVIDSTEAL  
lou lou  
JOHNSTON & MURPHY  
LUKE'S  
THE CHICKEN & RICE GUYS

sweetgreen  
EQUINOX

PRET  
HALE and HEARTY

CONGRESS SQUARE

sweetgreen  
SAMUEL ADAMS

Starbucks COFFEE  
COCOBEET  
STATE STREET  
13,258 DAILY RIDERS

HILL HOLIDAY  
500 EMPLOYEES  
Brooks Brothers  
Santander

OGAWA COFFEE

POST OFFICE SQUARE

FINANCIAL DISTRICT

OLD SOUTH MEETING HOUSE

BLUE BOTTLE  
acaemia  
Bailey Sage

BLUE BOTTLE  
acaemia  
Bailey Sage

PRET  
Starbucks COFFEE  
oath  
DUNKIN' DONUTS

T

**CONTACT INFO**

**PETER CONSIDINE**

617.369.5959

pconsidine@dartco.com

**LINDSEY SANDELL**

617.369.5936

lsandell@dartco.com

**congress  
square**

congress  
square

