



## Citadel International III

5950 Hazeltine National Drive, Orlando, Florida 32822

### Property Features

- Class 'A', 6-story, 139,042± RSF office building
- All spaces available as shown
- Great view from the 5th & 6th floors
- Suite 620 & 650 can be combined to make 5,824 RSF suite
- Beautiful three-story atrium and lobby
- Parking: 4/1,000 SF
- Spectrum and AT&T are the building's high speed internet and phone providers
- Located in the LeeVista Center
- Convenient access to SR 436 (Semoran Blvd), SR 528 (Beachline), SR 417 (GreeneWay) and Orlando International Airport



### Availabilities

Suite	RSF	Available
3rd Floor	22,891	Now
5th Floor	8,019	Now
Suite 620	2,800	Now
Suite 630	1,186	Now
Suite 650	2,870	Now

For more information:

**Mary Frances West, CCIM**

+1 407 949 0725

mfwest@realvest.com

Contact Agent for Lease Rate

12.13.19

The information contained herein has been given to us by the owner of the property or other sources we deem reliable. We have no reason to doubt its accuracy, but we do not guarantee it. All information should be verified prior to purchase or lease.

1800 Pembroke Drive Suite 350

Orlando, Florida 32810

+1 407 875 9989

[nairealvest.com](http://nairealvest.com)

5950 Hazeltine National Drive  
Orlando, Florida 32822

For Lease  
Class "A" Office Space

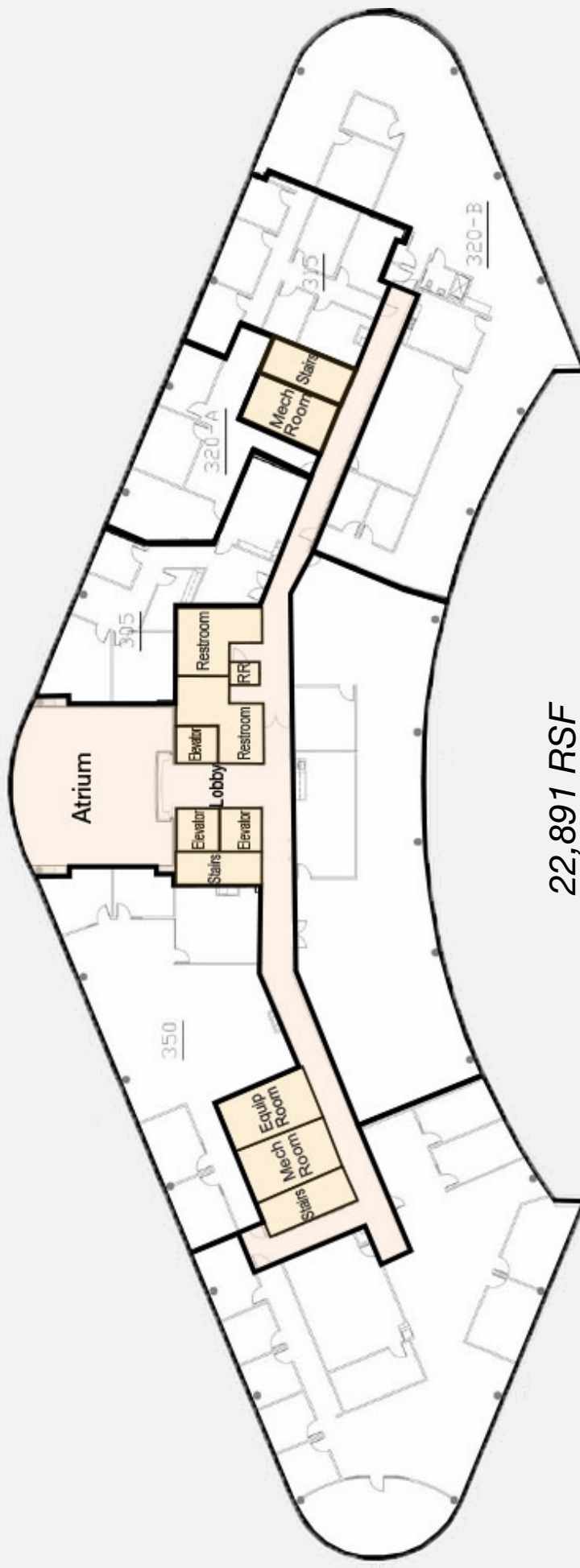

22,891 RSF  
Third Floor

**5950 Hazeltine National Drive**  
Orlando, Florida 32822

For Lease  
Class "A" Office Space

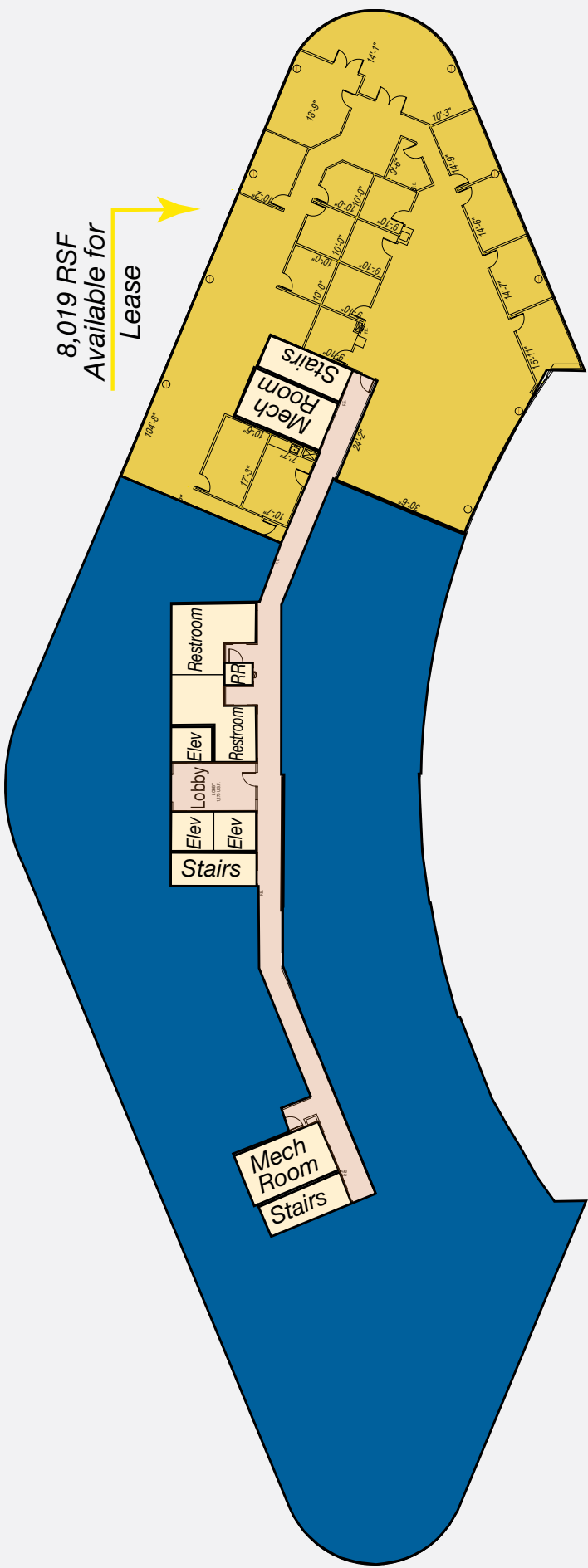

Fifth Floor

5950 Hazeltine National Drive  
Orlando, Florida 32822

For Lease  
Class "A" Office Space

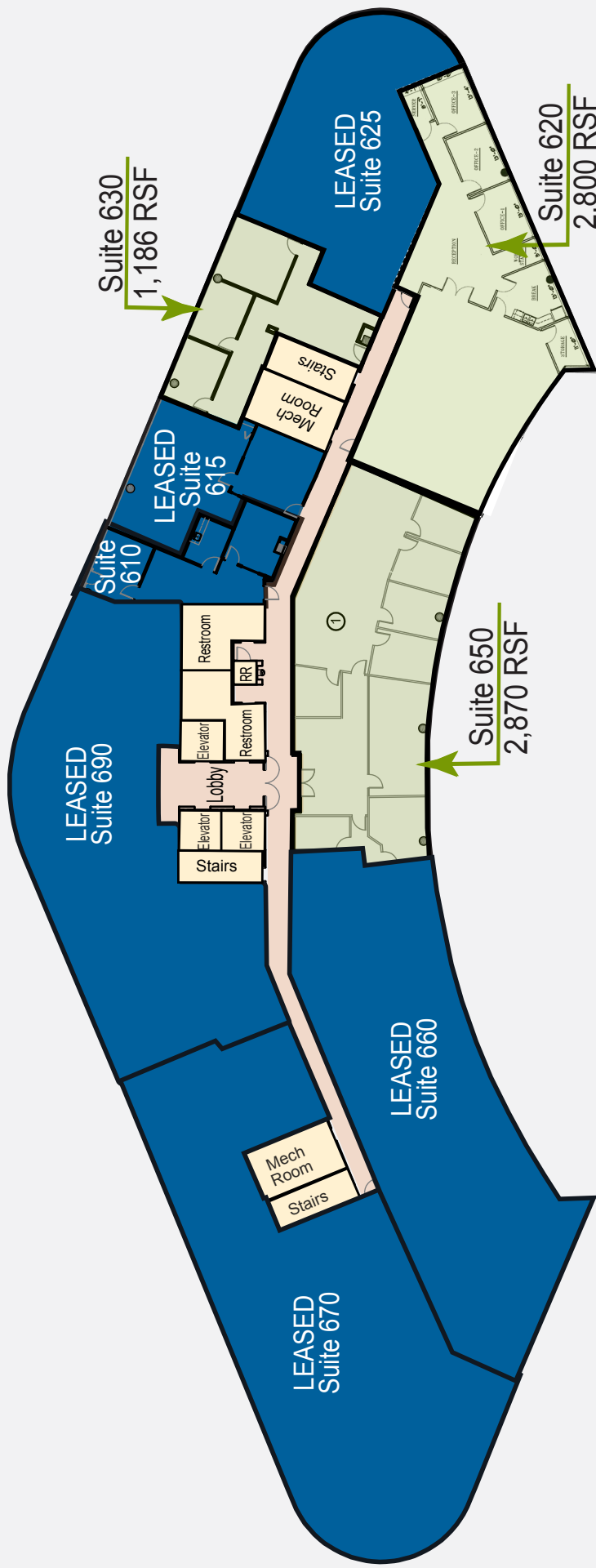

Suite 650 & 620  
Combined = 5,670 RSF

Sixth Floor