

32,060 SF

FOR SALE

7920 DEERING AVENUE
CANOGA PARK, CA 91304



- + FREE STANDING BUILDING WITH EXTERIOR TRUCK WELL
- + LARGE FENCED CONCRETE YARD
- + 6 GROUND LEVEL DOORS (UP TO 16 POSSIBLE)
- + 1600 AMPS OF 480 VOLT ELECTRICAL SERVICE
- + LOCATED MINUTES NORTH OF WARNER CENTER/101 FREEWAY

PROPERTY INFO

PRICE/SF:	\$240.18	POWER:	A:1600, V:277/480, P:3, W:4
SALE PRICE:	\$7,700,000	PARKING SPACES/RATIO:	70 / 2.19:1
AVAILABLE SF:	32,060	YARD:	Yes - Fenced
OFFICE SF/#:	4,000 / 7	RESTROOMS:	6
PROPERTY TYPE:	Industrial	LOT SIZE:	71,227
GROUND LEVEL DOORS/DIM:	6 / 16' x 12'	ZONING:	M2
TRUCK HIGH:	1 (Well)	APN#:	2109-017-026
SPRINKLERED:	No	POSSESSION:	Close of Escrow
CLEAR HEIGHT:	16'	TO SHOW:	Call Agent

Notes: Ground Level Door with Exterior Truck Well.

LOCATOR MAP:

7920 DEERING AVE

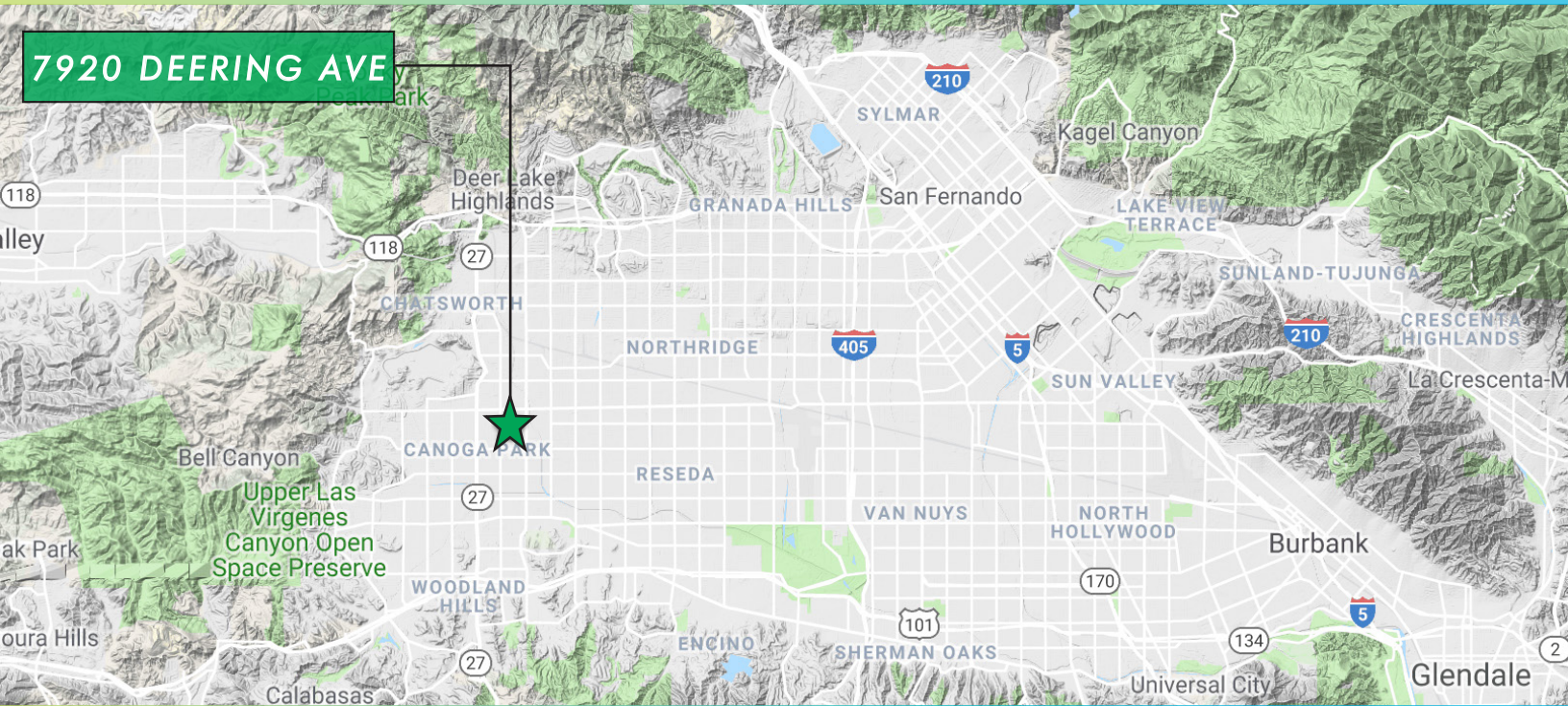

FLOOR PLAN:

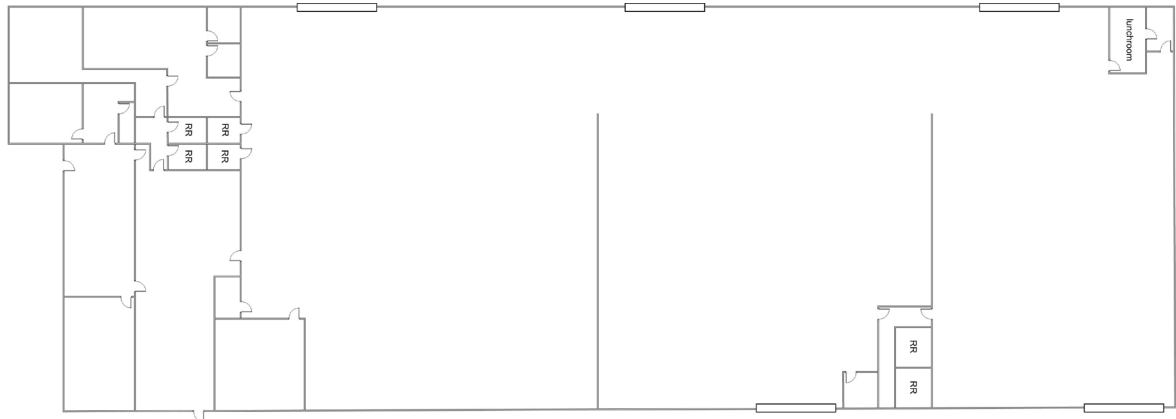

PHOTOS:



FOR MORE INFORMATION, PLEASE CONTACT:



GREG GERACI
Senior Vice President
+1 818 502 6741
greg.geraci@cbre.com
Lic 01004871



DAVID HARDING
Senior Vice President
+1 818 502 6731
david.harding@cbre.com
Lic 01049696



BILLY WALK
First Vice President
+1 818 502 6733
william.walk@cbre.com
Lic 01398310



MATT DIERCKMAN
Senior Vice President
+1 818 502 6752
matt.dierckman@cbre.com
Lic 01301723

www.cbre.com/lanorth

© 2019 CBRE, Inc. All rights reserved. This information has been obtained from sources believed reliable, but has not been verified for accuracy or completeness. You should conduct a careful, independent investigation of the property and verify all information. Any reliance on this information is solely at your own risk. CBRE and the CBRE logo are service marks of CBRE, Inc. All other marks displayed on this document are the property of their respective owners. Photos herein are the property of their respective owners. Use of these images without the express written consent of the owner is prohibited.

