

# Brooklyn Logistics Center 1

Brooklyn, New York



32,500 SF  
Industrial Space for Lease



# Building Specifications

- 32,500 SF available
- 3 interior recessed loading positions
- 12'-16' clear height
- 20' x 48'-8" column spacing
- 5,000 SF paved and fenced parking lot (21 spaces) and street parking
- M1-2 zoning

Available  
 Non-Prologis Building  
 Dock Door  
 Drive-in Door

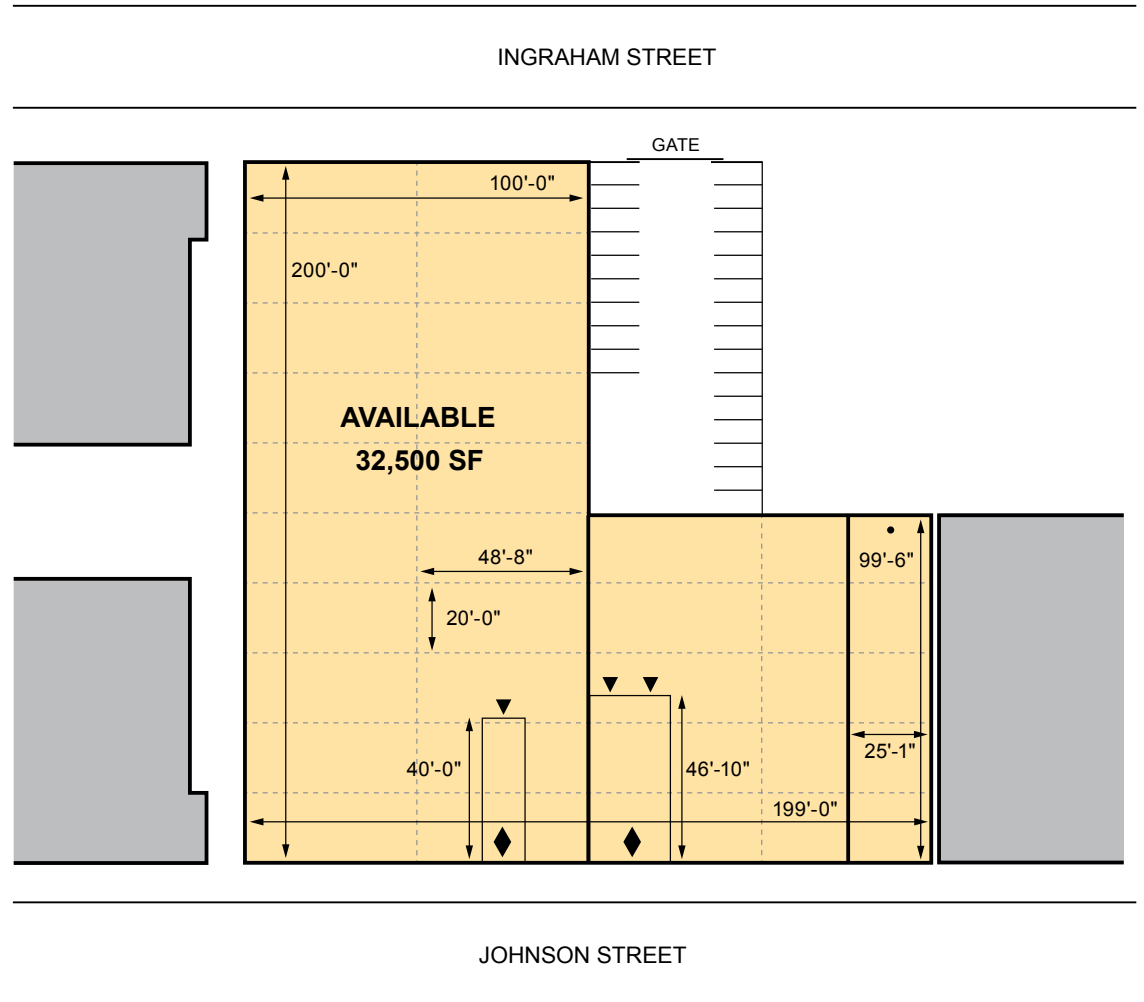

## Population

	Total Population	Total Daytime Population
1 MILE »	133,560	102,562
3 MILES »	1,084,796	885,625
5 MILES »	3,341,506	4,713,600



## Household Income

	Median	Average	Per Capita
1 MILE »	\$49,767	\$73,975	\$26,760
3 MILES »	\$56,802	\$84,554	\$32,909
5 MILES »	\$68,855	\$111,916	\$46,621



## Prime Location

- Less than three miles to Manhattan
- Easy access to the E or L subway line and B57 and B60 buses
- Walking distance from Morgan, Montrose and Flushing Avenues

# Brooklyn Logistics Center 1

450 Johnson Avenue, Brooklyn, NY 11237



 Morgan Avenue Subway  
4 minute walk



## Education (Population ages 25+)

AA Degree	BA/BS Degree	PhD Degree	H.S. Grad, GED or Alternative	MA/MS Degree	Professional School Degree	Some College, 1+ Yrs, No Degree	Some College, <1 Yr	Total Pop. 25+
3,878	20,115	221	21,934	6,828	849	9,120	2,837	93,140
44,232	170,946	5,941	188,695	72,644	15,095	76,744	28,916	753,765
131,056	624,373	40,540	540,589	301,655	99,532	224,656	74,291	2,426,105



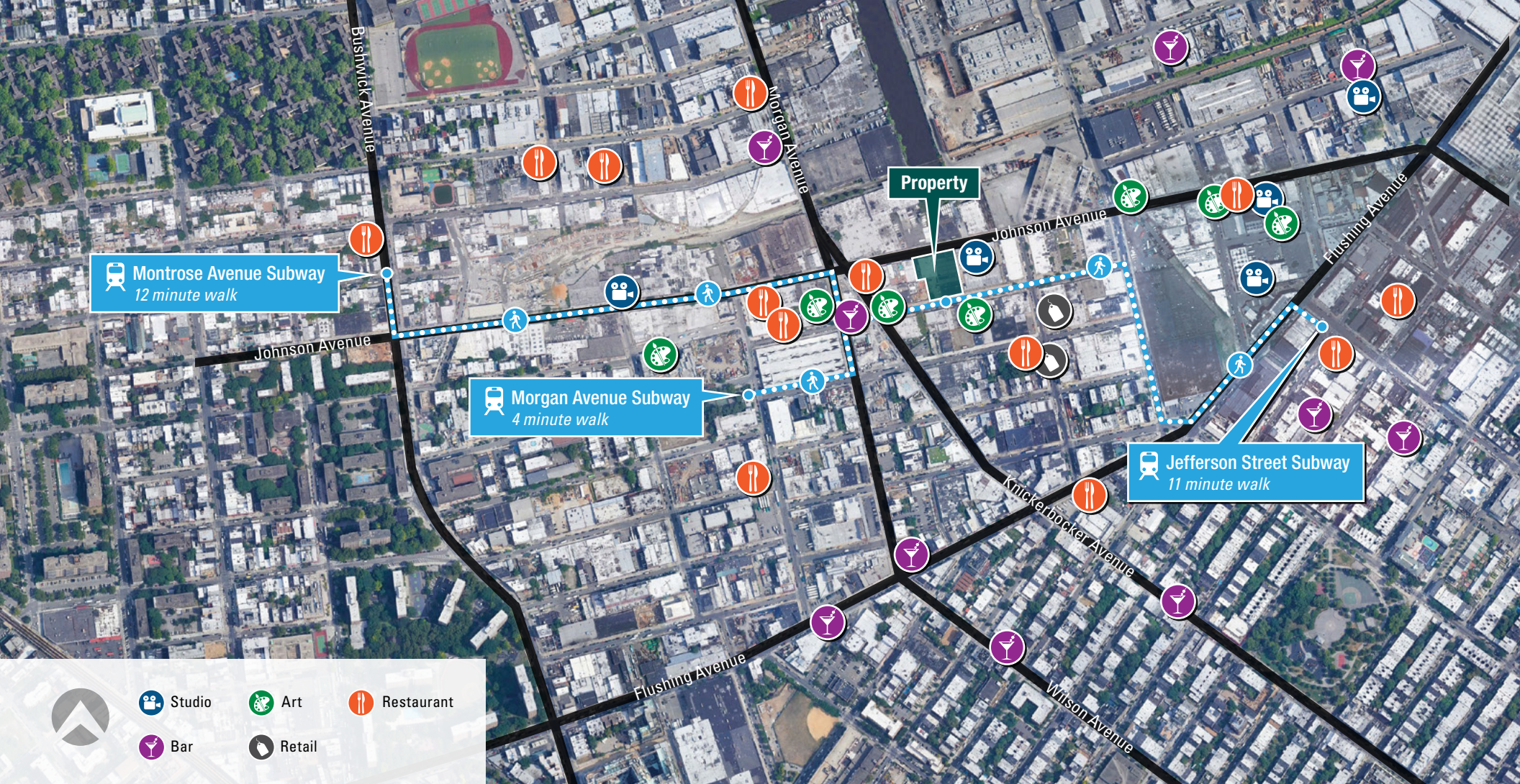

 Studio

 Art

 Restaurant

 Bar

 Retail



**Joseph B. Cirone**  
Executive Director  
+1 718 606 7038  
joseph.cirone@cushwake.com

**Gina Damond**  
Senior Associate  
+1 212 841 7536  
gina.damond@cushwake.com

**Rich Novak**  
Director  
+1 212 713 6858  
rich.novak@cushwake.com



**Andrew Forsyth**  
Director, Leasing  
aforsyth@prologis.com  
Direct: +1 201 528 9575

**Prologis – NY/NJ**  
1 Meadowlands Plaza  
Suite 100  
East Rutherford, NJ 07073  
Main: +1 201 635 6000

**Prologis Headquarters**  
Pier 1, Bay 1  
San Francisco, CA 94111  
Main: +1 415 394 9000  
info@prologis.com

www.prologis.com  
NYSE: PLD  
Twitter: @Prologis

Prologis is the global leader in logistics real estate with approximately 976 million square feet owned and under management in 19 countries on four continents.

Data as of September 30, 2020, for assets the company owned or had investments in, on a wholly owned basis or through co-investment ventures, properties and development projects.  
PLD\_PBLCB\_WB\_0121