

# SHOP SPACE AVAILABLE FOR LEASE



967 Kendall Drive, San Bernardino

## PROPERTY HIGHLIGHTS

- Shop Spaces from ±1,300 SF to ±4,354 SF
- Stater Bros. Anchored Center
- Captive Trade Area with Existing Residential Base
- Easy Access and Great Visibility
- High Population Demographics

## DEMOGRAPHICS

3-Mile Radius



Source: Regis Online 2019

## TRAFFIC COUNTS



Combined Count Source: Regis Online 2019

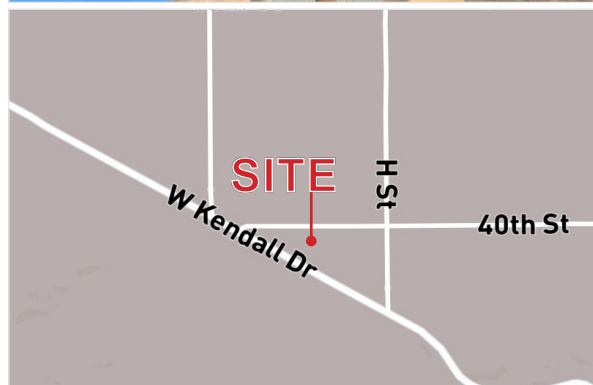

**JEFF STANLEY**

951.276.3612

[jstanley@leeriverside.com](mailto:jstanley@leeriverside.com)

DRE# 01016436

**CHRIS BEAUCHAMP**

951.276.3675

[cbeauchamp@leeriverside.com](mailto:cbeauchamp@leeriverside.com)

DRE# 01982753





# SHOP SPACE AVAILABLE FOR LEASE

SHANDIN HILLS DR

KENDALL DRIVE

SHANDIN HILLS CIRCLE DR

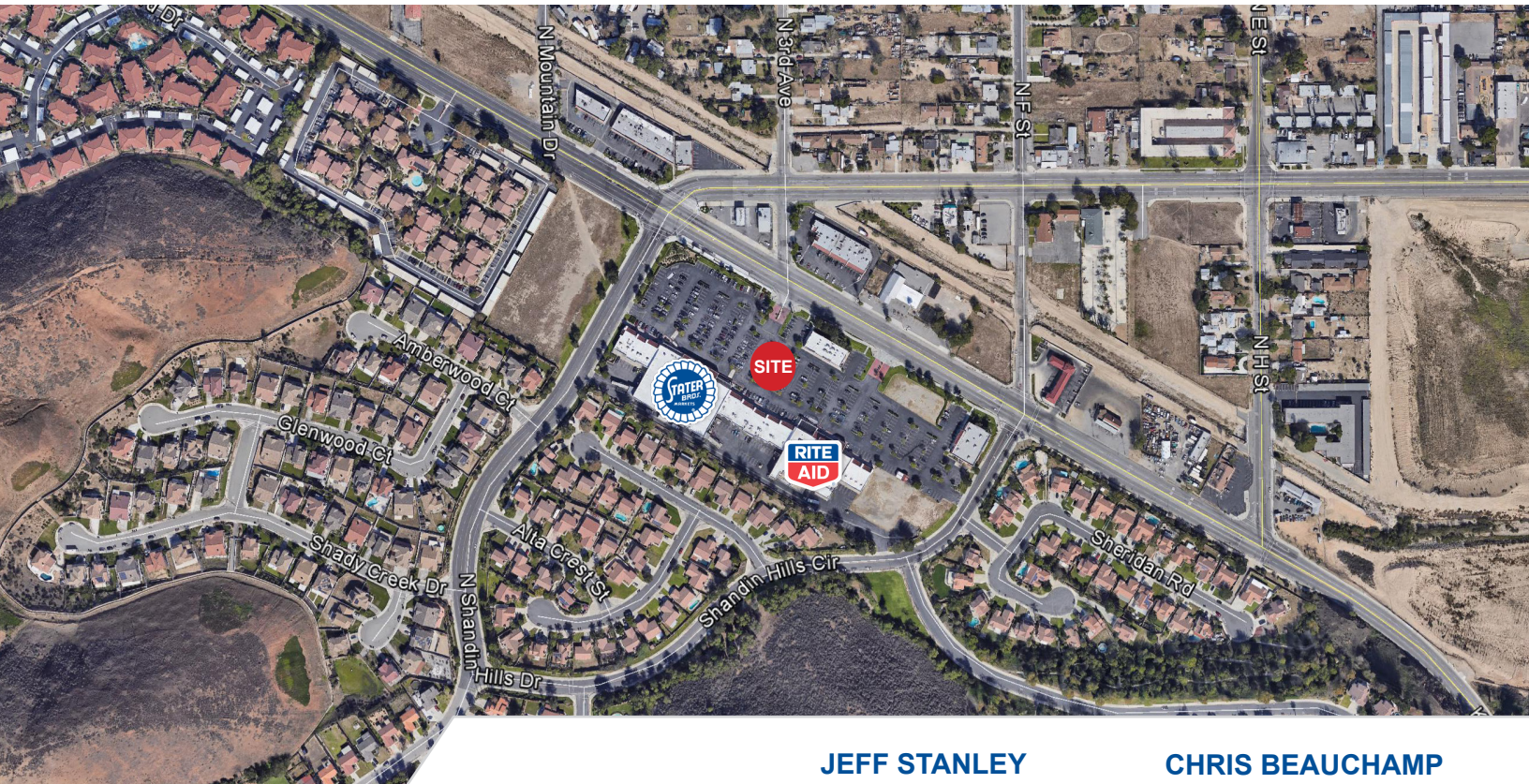
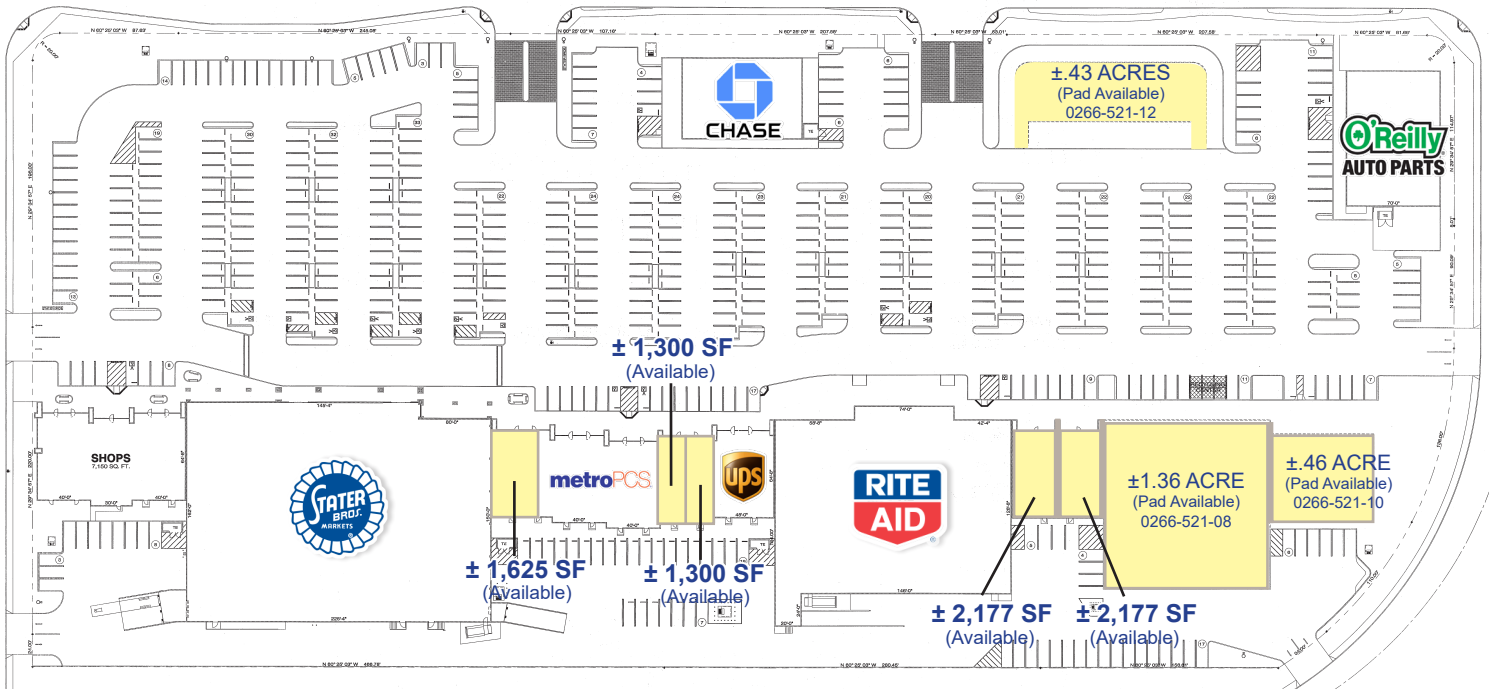

**JEFF STANLEY**  
951.276.3612

[jstanley@leeriverside.com](mailto:jstanley@leeriverside.com)  
DRE# 01016436

**CHRIS BEAUCHAMP**  
951.276.3675

[cbeauchamp@leeriverside.com](mailto:cbeauchamp@leeriverside.com)  
DRE# 01982753

No warranty or representation has been made to the accuracy of the foregoing information. Terms of sale or lease and availability are subject to change or withdrawal without notice.  
Lee & Associates Commercial Real Estate Services, Inc. - Riverside | 3240 Mission Inn Avenue, Riverside, CA 92507 | Corporate DRE# 01048055