

For Lease

5% SUMMER BONUS ON ALL DEALS SIGNED BY LABOR DAY



GLOBAL BUSINESS PARK C

1309 Rutherford Lane
Austin, Texas 78753

PROPERTY OVERVIEW

Space Available	Suite 100 61,440 SF
Rate	Negotiable
Operating Expenses	\$3.71 PSF Year EST.

Building features:

- 28' Clear Height
- +/- 15% Office
- 100% Climate Controlled
- Heavy Power
- Newly Renovated Office Area
- LED Lighting in Warehouse
- Sprinklered



FOR MORE INFORMATION

Ace Schlameus
512.225.2709

Ace.Schlameus@am.jll.com

Kyle McCulloch
512.225.2713

Kyle.McCulloch@am.jll.com

Dalfen
INDUSTRIAL

SUITE 100 | 61,440 SF
GLOBAL BUSINESS PARK C

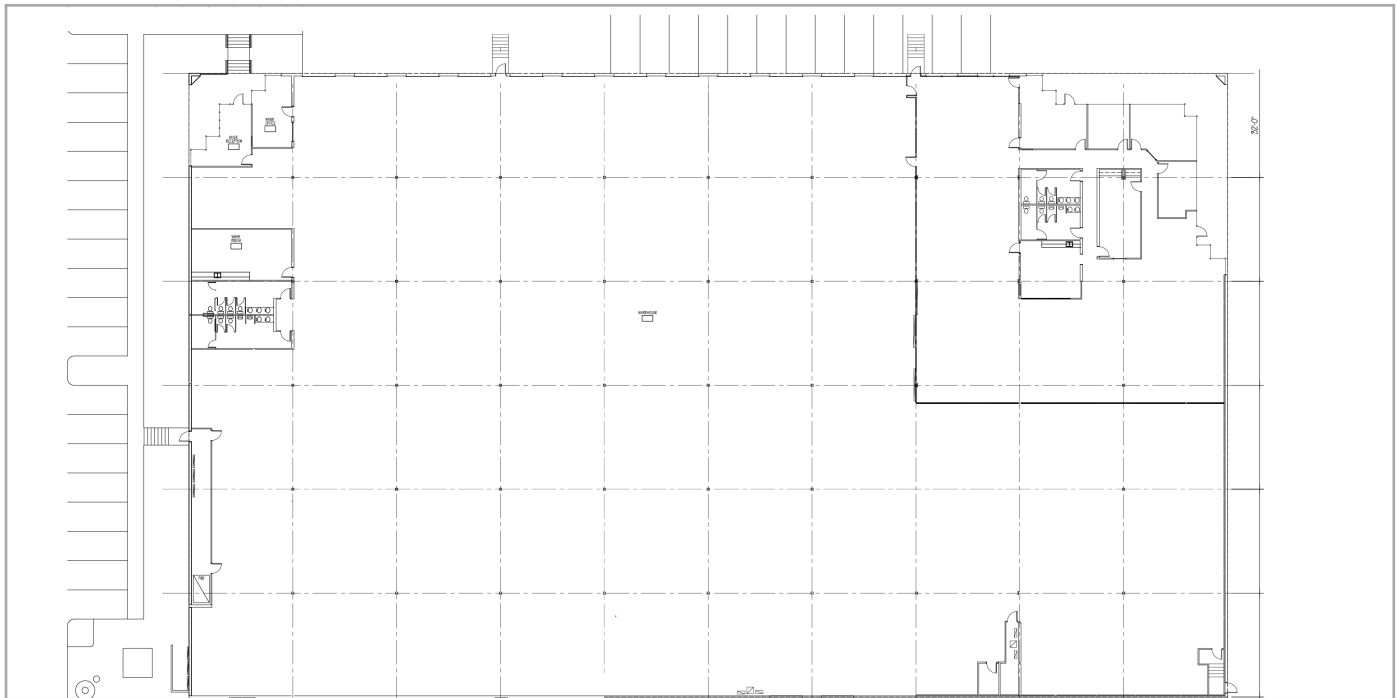

FOR MORE INFORMATION

Ace Schlameus
512.225.2709

Ace.Schlameus@am.jll.com

Kyle McCulloch
512.225.2713

Kyle.McCulloch@am.jll.com

Dalfen
INDUSTRIAL