

FOR LEASE

8133 - 8141 Engineer Road, San Diego, CA 92111

± 9,118 SF BUSINESS PARK IN KEARNY MESA

Voit

REAL ESTATE SERVICES



PROPERTY FEATURES

- ±2,148 Rentable Square Feet
- New Spec Suite
- Front Space
- 50% office
- 1 double door
- Operable windows
- 2.3/1,000 parking
- 100 amps
- 12'-14' clear height

LEASE RATE: \$1.15 Base Year Gross



RANDY LACHANCE

Senior Vice President

Lic #00969674

858.458.3374

rlachance@voitco.com

FOR LEASE

8133 - 8141 ENGINEER ROAD, SAN DIEGO, CA 92111

BUILDING PLANS

SITE PLAN

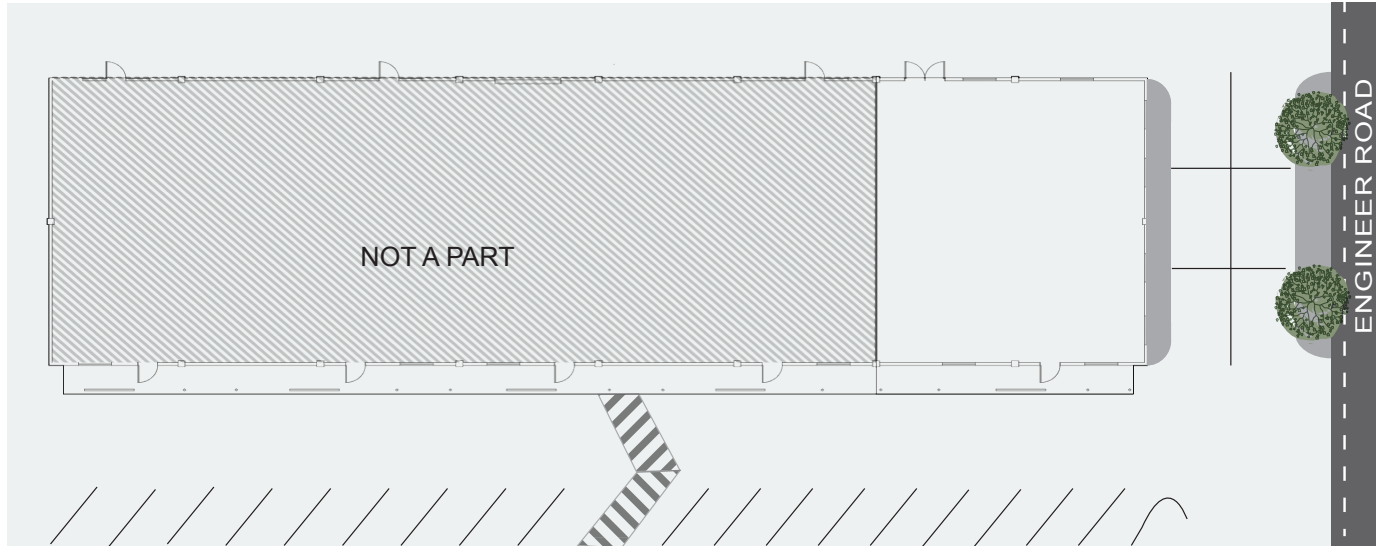

FLOOR PLAN

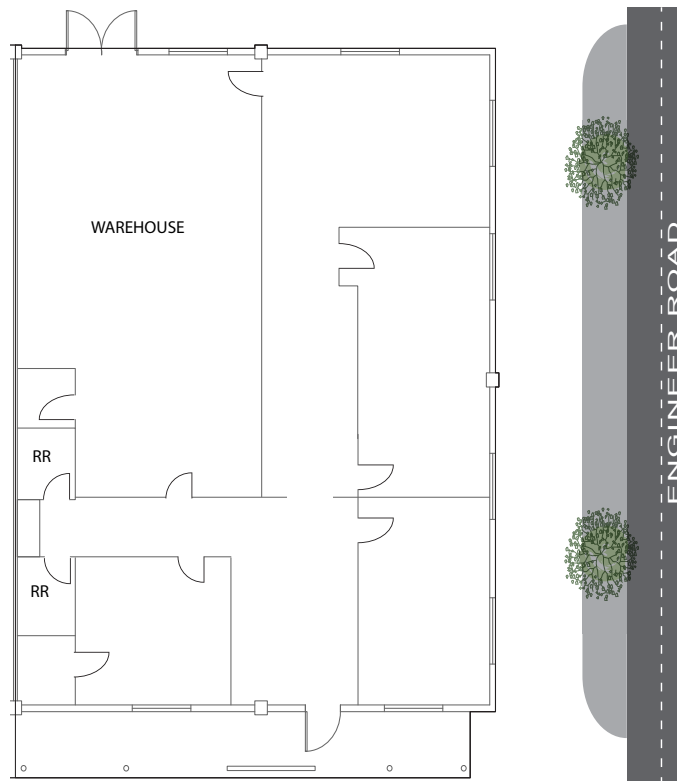

RANDY LACHANCE

Senior Vice President

Lic #00969674

858.458.3374

rlachance@voitco.com

Voit

REAL ESTATE SERVICES

4747 Executive Drive, Suite 800, San Diego, CA 92121 • 858.453.0505 • 858.408.3976 Fax • Lic #01333376 | www.voitco.com

Licensed as Real Estate Salesperson by the CA Bur of Real Estate. ©2015 Voit Real Estate Services, Inc. All Rights Reserved. Real People. Real Solutions.™ is a trademark of Voit Real Estate Services. The information contained herein has been obtained from sources we deem reliable. While we have no reason to doubt its accuracy, we do not guarantee it.