



AVAILABLE FOR SALE

For More Information Please Contact:

JODI V. MEADE, CRX, CSM

Principal & National Director
Automotive Properties Group
Lic. 01126082
213.471.1060
jodi.meade@avisonyoung .com

JAY SIMMERS

Associate
Automotive Properties Group
Lic. 02062448
213.618.3822
jay.simmers@avisonyoung .com



Avison Young's Automotive Properties Group is pleased to present an opportunity for sale in the highly constrained city of Indio, California. This 14,000 s.f. building is zoned RC, Regional Commercial, which allows for a multitude of uses and offers maximum exposure being located on Highway 111.

The property services nearly 162,450 people within a 5-mile radius with an average household income of over \$70,052.

For more information, please contact Avison Young's Automotive Properties Group to answer any questions and to schedule a site tour.





SITE PLAN

PROPERTY HIGHLIGHTS

Price: \$899,000

Land AC: 0.46

APN: 612-031-003

Size: 14,000 SF

Zoning: RC (Regional Commercial)

DEMOGRAPHICS

	3 Mile	5 Miles
Estimated Population:	101,502	162,450
Average Household Income:	\$462,305	\$70,052

TRAFFIC COUNT

Highway 111	20,444 Vehicles Per Day
Indio Blvd	13,742 Vehicles Per Day

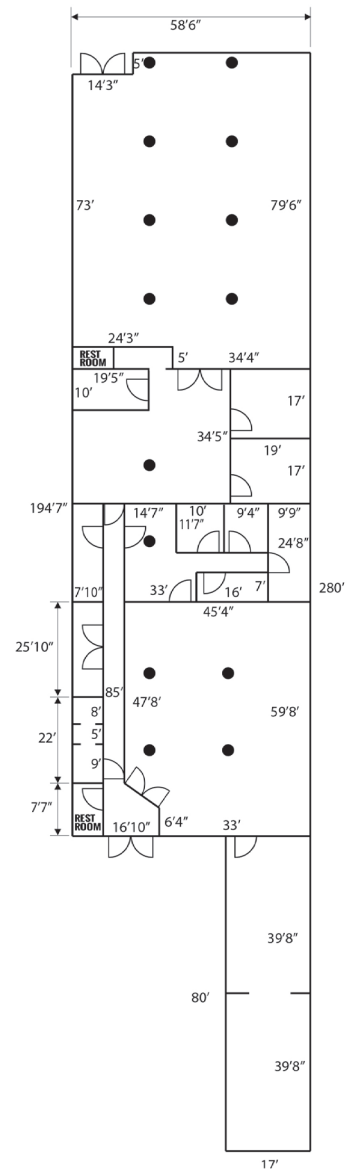



Avison Young's Automotive Properties Group (APG)

is a fully dedicated service line within Avison Young, Inc. that specializes in the automotive real estate needs of investors, developers, manufacturers, and franchisees. Headquartered in Los Angeles, California, APG provides automotive specific expert knowledge in marketing, research, investments, leasing, management, and valuation. APG consistently utilizes the global network and local marketing knowledge of Avison Young's dedicated real estate professionals to ensure our clients make informed, effective real estate decisions.

The above statement was made based upon information furnished to us by the owner or from sources we believe are reliable. While we do not doubt its accuracy, we have not verified it and we do not make any guarantee, warranty or representation about it. The property offered is subject to prior sale, lease, change of price or withdrawal from the market without notice.

For More Information Please Contact:

JODI V. MEADE, CRX, CSM

Principal & National Director
Automotive Properties Group
Lic. 01126082
213.471.1060
jodi.meade@avisonyoung .com

JAY SIMMERS

Associate
Automotive Properties Group
Lic. 02062448
213.18.3822
jay.simmers@avisonyoung .com