

Baton Rouge is the mirror image of this plan

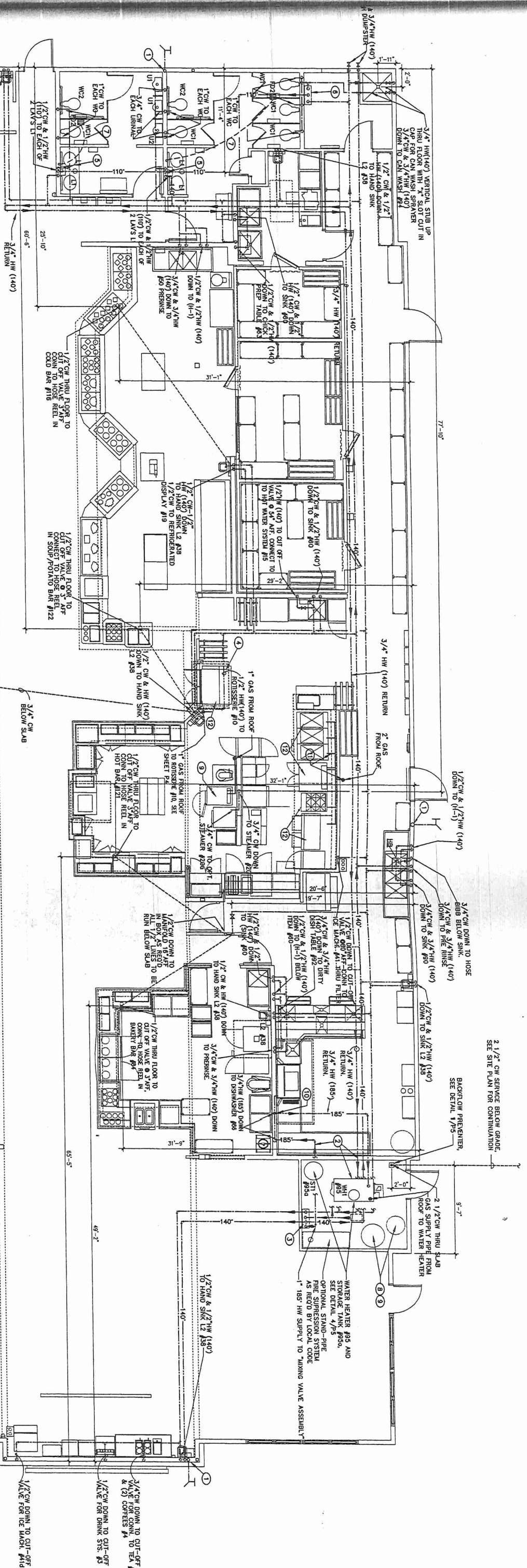

WATER SUPPLY PIPING PLAN

SCALE: 3/8" = 1'-0"

- NOTES:
1. ANALYZE FROM THE LOCAL WATER DISTRICT.
 2. SEEK P&E TOTAL LOADS FOR PEAK GPM DEMAND FOR THE BUILDING.
 3. PEAK WATER DEMAND EXCEEDS 7 MILLION.
 4. IF WATER SOFTENER IS NEEDED, P.C. SHALL USE THE FOLLOWING CHART BASED ON SITE CW WATER DEMAND FLOW IN GPM & LARGER UNITS PROVIDE LARGER PERIODS OF TIME. SHALL COORDINATE WITH OWNER FOR UNIT SELECTION.

PEAK WATER DEMAND (GPM)	CHILLER TYPE	NUMBER	SALT DOSEAGE (LB.) MIN-MAX	CHILLER CAPACITY (GRANS) @ 0-64
0-64	HI-FLO2	PV-158	90,000(20) - 135,000(75)	GRANS @ LB.
0-78	HI-FLO3	HC-150	100,000(20) - 150,000(75)	GRANS @ LB.
0-78	HI-FLO3	HC-210	140,000(42) - 210,000(100)	GRANS @ LB.

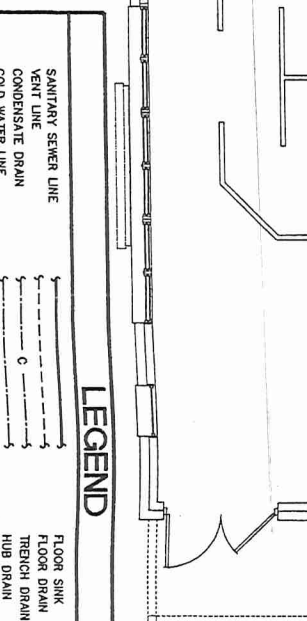

- GENERAL NOTES:
1. REFER TO SHEET P5 FOR GENERAL NOTES.
 2. REFER TO SHEET P7 FOR ALL ELEVATION ROUGH-INS. SEE THIS SHEET FOR SLAB PENETRATION ROUGH-INS.
- CONSTRUCTION NOTES:
1. CONNECT ALL FPHB (3/4") ON LAMB SPRINKLER PIPING. (IF APPLICABLE) SEE IRRIGATION PLAN BY OTHERS.
 2. P.C. SHALL PROVIDE APPROVED 2-1/8" FIRE STOP MATERIAL (BY 3M) FOR ANY PIPE PENETRATING UTILITY ROOM WALL.
 3. P.C. SHALL INSTALL MAKING VALVE ASSEMBLY ALONG THIS WALL IN UTILITY ROOM. SEE DETAIL 1/P4.
 4. P.C. SHALL PROVIDE/INSTALL 1/2" FLEXIBLE LINE WITH QUICK DISCONNECT FOR HW CONNECTION TO ROISSSENE.
 5. P.C. SHALL INSTALL A UTILITY FAUCET (H-1) BELOW VANITY @ 18" AFF.
 6. P.C. SHALL INSTALL MAKING VALVE ASSEMBLY ALONG THIS WALL IN COMPACTOR ROOM. SEE DETAIL 2/P4.
 7. 1/2" CW BELOW SLAB FROM TRAP PRIMER UNDER LAV DOWN TO FLOOR DRAIN. SCOPE TOWARD DRAIN.
 8. P.C. SHALL PUMP WATER SOFTENER #98 (OPTIONAL) INTO CW SYSTEM WHEN SOFTENER IS REQUIRED. ROUTE CW MAIN TO WATER SOFTENER #98 (OPTIONAL) INTO CW SYSTEM WHEN SOFTENER IS REQUIRED. WATER SOFTENER SHALL BE INSTALLED UPSTREAM FROM ANY WATER USAGE DEVICE. INSTALLATION WILL BE SUPPLIED BY THE PLUMBING CONTRACTOR. THIS INCLUDES INSTALLING THE INLET, DRAIN AND SERVICE PIPING TO AND FROM THE SOFTENER. THE LOCAL CHILLER CONTRACTOR SHALL PROVIDE THE WATER TANK AS PER THE ARCHITECT'S DRAWING.

golden corral
Steaks, Buffet & Bakery

Revisions
THRU ADDENDUM 7
8/7/98

GO-11M41 PROTOTYPE (MODIFIED)
LEFT-HAND
Location: **BATON ROUGE, LOUISIANA**
Sherwood Forest Boulevard
Drawing: PLUMBING HOT/COLD

THESE STANDARD DESIGN DOCUMENTS AND SPECIFICATIONS ARE OWNED AND CONTROLLED BY GOLDEN CORRAL CORPORATION AND ARE NOT TO BE USED, COPIED OR REPRODUCED WITHOUT WRITTEN CONSENT. ANY UNAUTHORIZED USE OR DISCLOSURE OF THE PROPRIETARY INFORMATION CONTAINED HEREIN MAY SUBJECT SUCH PERSONS TO CRIMINAL AND CIVIL PENALTIES AND DAMAGES.

GOLDEN CORRAL CORPORATION
5151 GLENWOOD AVENUE
RAIFORD, NC 27612

SEAL
MAUGHAN + RICHARD
An Architectural and Interior Design Company
7520 Parkers Road, Suite 170

MAUGHAN + RICHARD
An Architectural and Interior Design Company
7520 Parkers Road, Suite 170