

9796 S. DIXIE HIGHWAY
ERIE, MICHIGAN

RETAIL FOR SALE
1,788 Square Feet Available



**SIGNATURE
ASSOCIATES**
KNOW SIGNATURE | KNOW RESULTS

FORMER BANK



REDUCED PRICE

PROPERTY FEATURES

- 1,788 available square feet
- 0.32 acre
- Ample parking
- Sale Price: \$250,000 (\$139.82/sq.ft.)

Comments: Former bank branch with drive-thru. No deed restrictions against bank or financial institutions.



For more information, please contact:

JEFFREY TREPECK
(248) 359 0626
jtrepeck@signatureassociates.com

SIGNATURE ASSOCIATES
One Towne Square, Suite 1200
Southfield, MI 48076
www.signatureassociates.com

9796 S. Dixie Highway – Erie, Michigan

Retail For Sale

1,788
Square Feet
AVAILABLE



DEMOGRAPHICS

	POPULATION	MED. HH INCOME
1 MILE	779	\$44,469
3 MILE	4,308	\$67,247
5 MILE	22,457	\$68,643

TRAFFIC COUNTS (TWO-WAY)

2,564	Dixie Hwy. S. of Erie Rd.
2,764	Dixie Hwy. N. of Erie Rd.
1,009	Erie Rd. W. of Dixie Hwy.
875	Erie E. of Dixie Hwy.



For more information, please contact:

JEFFREY TREPECK
(248) 359 0626
jtrepeck@signatureassociates.com

SIGNATURE ASSOCIATES
One Towne Square, Suite 1200
Southfield, MI 48076
www.signatureassociates.com

9796 S. Dixie Highway – Erie, Michigan

Retail For Sale

1,788
Square Feet
AVAILABLE

Site Plan

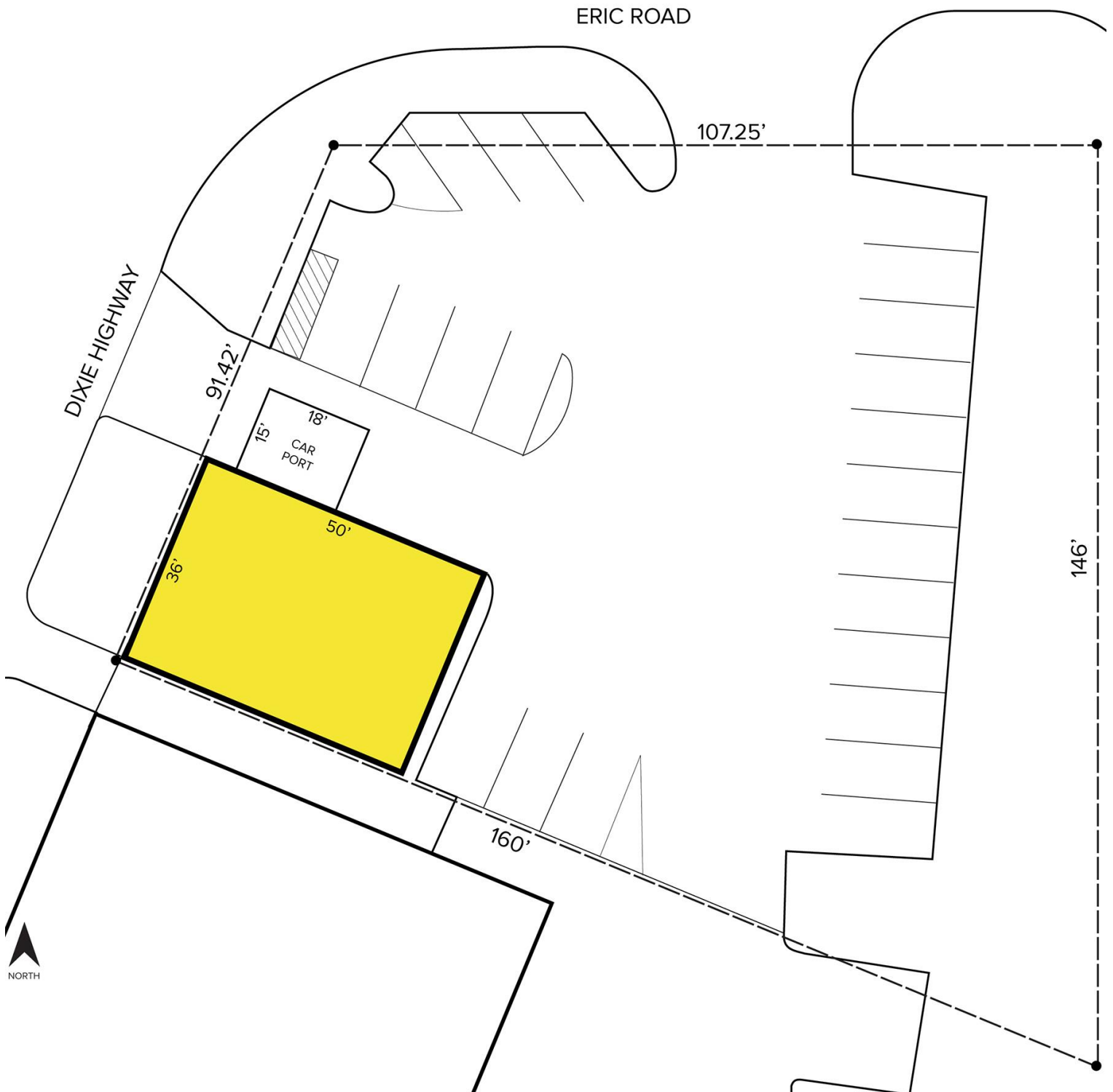

For more information, please contact:

JEFFREY TREPECK
(248) 359 0626
jtrepeck@signatureassociates.com

SIGNATURE ASSOCIATES
One Towne Square, Suite 1200
Southfield, MI 48076
www.signatureassociates.com