

The Shoppes and Residences at Renaissance Square Evesham (Marlton), New Jersey 08053



RD MANAGEMENT LLC

Evesham (Marlton), NJ The Shoppes and Residences at Renaissance Square



Location:

The Shoppes and Residences at Renaissance Square are located in Burlington County on State Highway 70 at the intersection of N. Locust Avenue in Evesham (Marlton), New Jersey 08053.

Type:

Community Strip Shopping Center and Luxury Rental Apartments

GLA:

127,926 sf

Traffic:

Two way average daily traffic
37,560 cars per day

Vital Statistics:

Major Renovation Underway

- Anchor, In-Line & Two Restaurant Pads available
- Proposed New Pylon/Monument Signs and Renovation of Existing Pylon will allow for multiple tenant sign panels
- 338 new Luxury Rental Apartments will be constructed alongside completely renovated shopping center offering prime retail opportunities
- Evesham Mortgage to have 40 employees in their 2nd floor office space
- The existing NJ State Right-of-Way will be transformed into an open space park complete with new jogging paths, walkways, bbq picnic section, children's play area, dog park and ponds

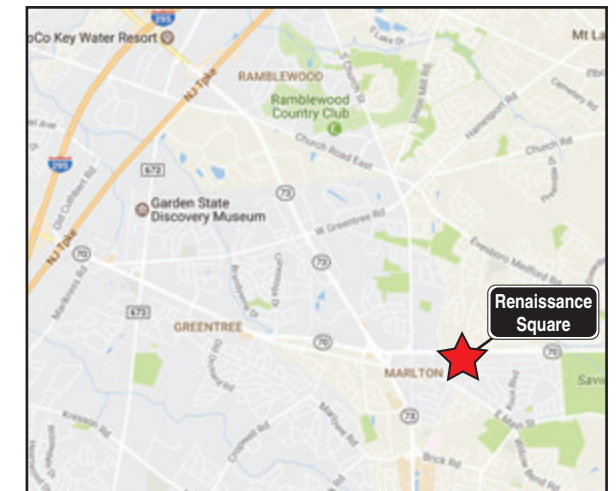

Demographics	1 mile	3 mile	5 mile	7 mile	10 mile
Population					
2024 (projection)	9,846	66,189	150,659	298,525	638,901
2019 (estimate)	9,869	66,516	151,306	300,640	643,283
2010 (census)	10,083	66,800	152,086	300,679	646,998
Number of HH					
2024 (projection)	4,144	27,393	62,387	125,321	261,644
2019 (estimate)	4,060	26,952	61,399	123,730	258,493
2010 (census)	3,896	25,657	58,549	117,422	246,724
Average HH Income					
2024 (projection)	\$145,729	\$160,051	\$164,592	\$150,989	\$128,960
2019 (estimate)	\$119,636	\$131,023	\$134,851	\$123,898	\$106,73
2010 (census)	\$88,896	\$102,384	\$109,125	\$100,287	\$87,633
Median Age					
2019 (estimate)	44.1	43.7	43.8	42.6	40.8
Daytime Population					
2019 (estimate)	12,244	65,835	153,169	298,106	507,080

RD Management LLC
Darren Sasso
212-265-6600 x354
dsasso@rdmanagement.com

810 Seventh Avenue, 10th floor
New York, NY 10019

RD Management LLC is ranked one of the Top 100 Retail Real Estate Owners in the U.S.

Information furnished is from sources deemed reliable, but is not guaranteed by RD Management and is subject to change in price, corrections, errors and omissions, prior sales or withdrawal without notice.

The Shoppes and Residences at Renaissance Square

State Highway 70 and N. Locust Avenue
Evesham (Marlton), New Jersey 08053



Darren Sasso
212-265-6600 x354
dsasso@rdmanagement.com
810 Seventh Avenue, 10th floor
New York, NY 10019

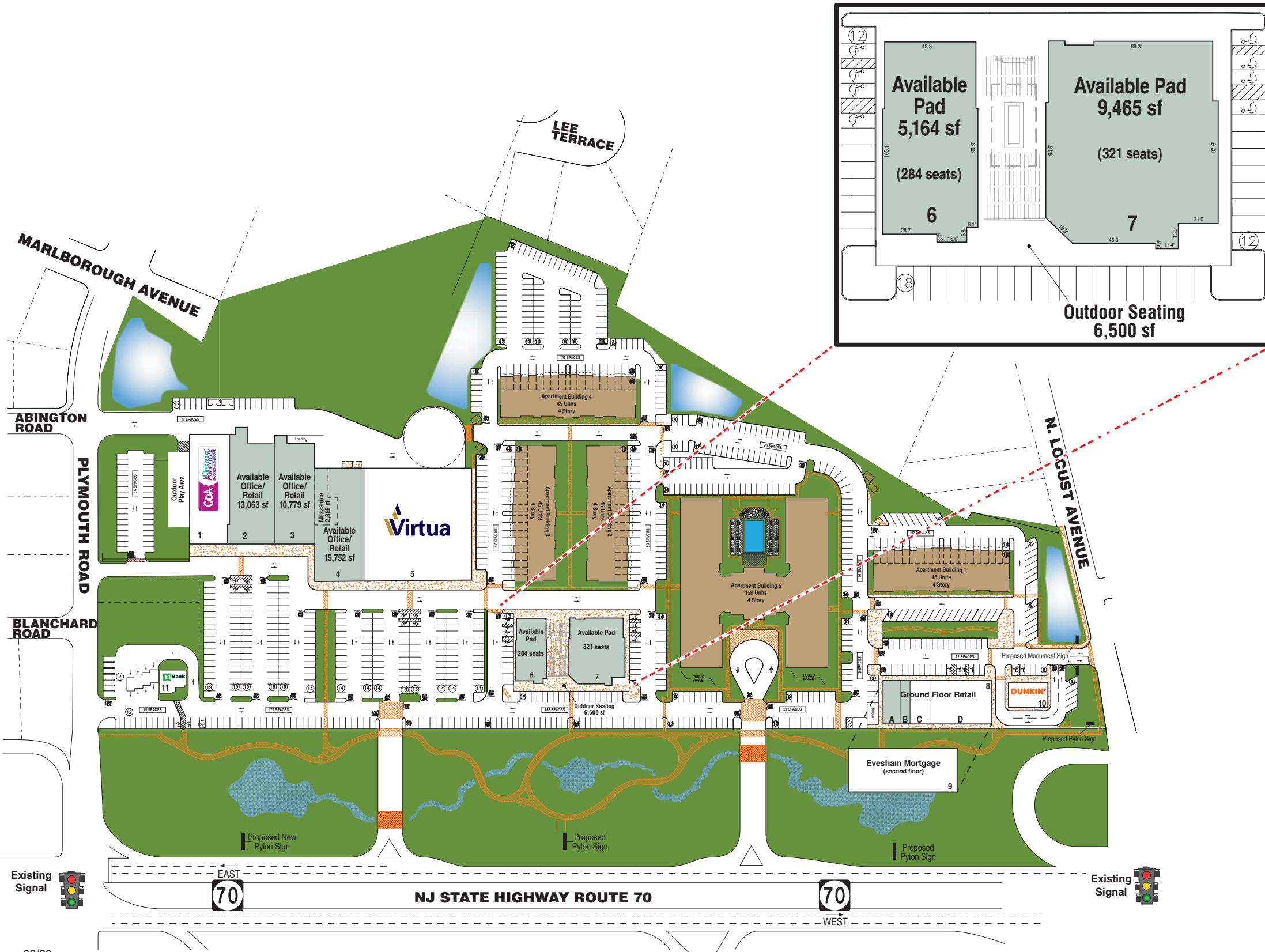

Tenant Key

1. Children of America		10,126 sf
2. Available Office/Retail	(84' x 165.5' irr.)	13,063 sf
3. Available Office/Retail	(65' x 165.5' irr.)	10,779 sf
4. Available Office/Retail	(84.5' x 185.5' irr.)	15,752 sf
Mezzanine		2,865 sf
5. Virtua Medical Group		32,568 sf
6. Available Restaurant Pad	(50.8' x 103.1' irr.)	5,164 sf
7. Available Restaurant Pad	(97' x 97.6' irr.)	9,465 sf
8. Ground Floor Retail Strip		
A. Available	(30' x 70')	2,070 sf
B. Available	(15' x 70')	1,050 sf
C. Pink Petal Mani		1,984 sf
D. Keller Williams Real Estate		6,387 sf
9. Evesham Mortgage		12,753 sf
10. Dunkin Donuts		2,600 sf
11. TD Bank (Existing)		1,300 sf

RESIDENTIAL KEY

Apartment Building 1	45 Units
Apartment Building 2	45 Units
Apartment Building 3	45 Units
Apartment Building 4	45 Units
Apartment Building 5	158 Units
Total Apartments	338 Units

