

# Kearny Villa Commerce Center

9103-9195 Chesapeake Drive  
San Diego, California 92123

# Voit

REAL ESTATE SERVICES



- 83,768 SF Multi-Tenant Industrial Park
- Sizes Available from 600 SF and Up
- Great Street Exposures
- 14 ½' Clearance
- 100 Amps/3 Phase Power per Suite
- 10'x10' Ground Level Truck Doors
- HVAC Offices
- Locally Managed
- Excellent Freeway Access to I-15, Hwy 163, and Hwy 52

## Availabilities

Address	Size	Rent	Comments	Available	To Show
9133 Chesapeake Dr.	1,600 SF	\$1.05/SF MG (CAM=\$0.11)	80% office; multiple privates; kitchenette	Now	KAB-1
9155 Chesapeake Dr.	1,600 SF	\$1.05/SF MG (CAM=\$0.11)	30% office; multiple offices; open area	Now	KAB-1
9165 Chesapeake Dr.	1,552 SF	\$1.05/SF MG (CAM=\$0.11)	85% office; multiple offices; open area	Nov 15, 2012	Appointment
9176 Chesapeake Dr.	2,400 SF	\$1.05/SF MG (CAM=\$0.11)	60% office; multiple offices	Now	KAB-1

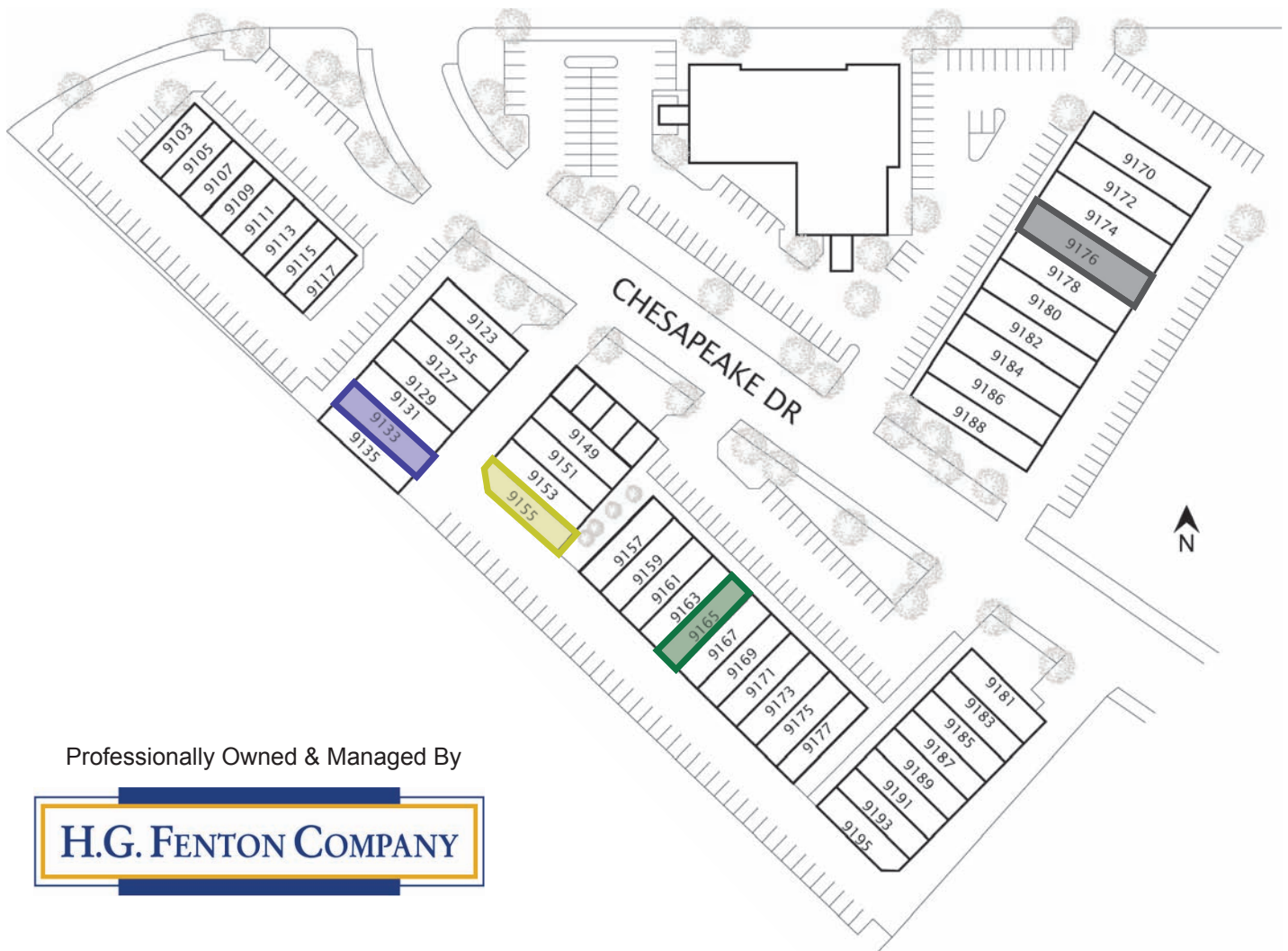

Professionally Owned & Managed By



**Jonathan Danton**  
Associate  
Lic #01800488  
858.458.3376  
jdanton@voitco.com

**Glen Volk, SIOR**  
Senior Vice President  
Lic #00859621  
858.458.3370  
gvolk@voitco.com

**Randy LaChance, SIOR**  
Senior Vice President  
Lic #00969674  
858.458.3374  
rlchance@voitco.com

**Voit**  
REAL ESTATE SERVICES

**Floor Plans**

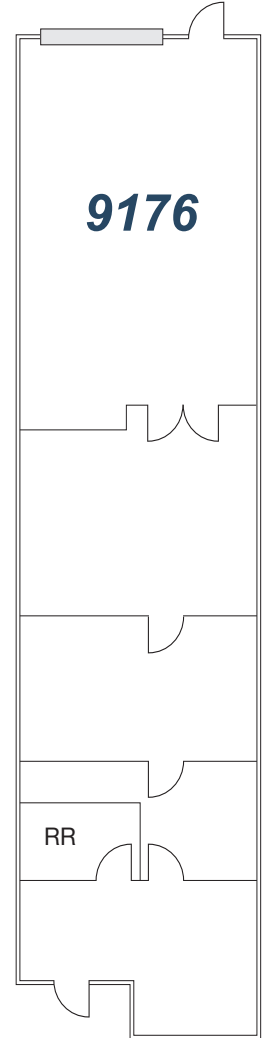
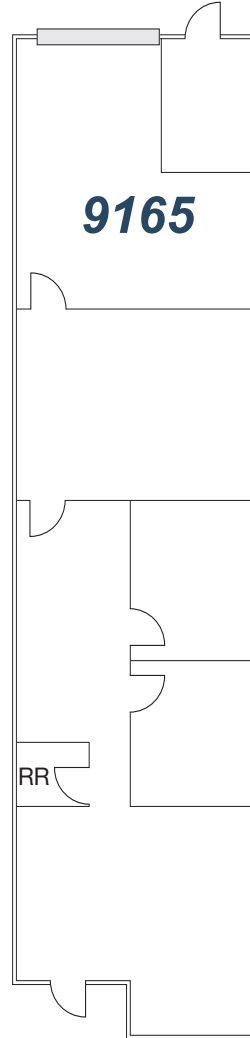
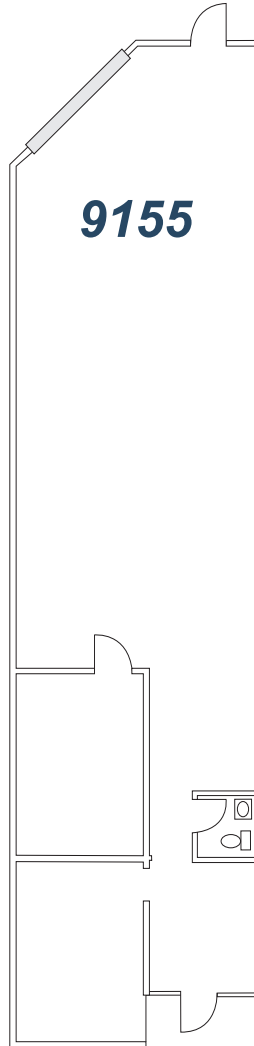
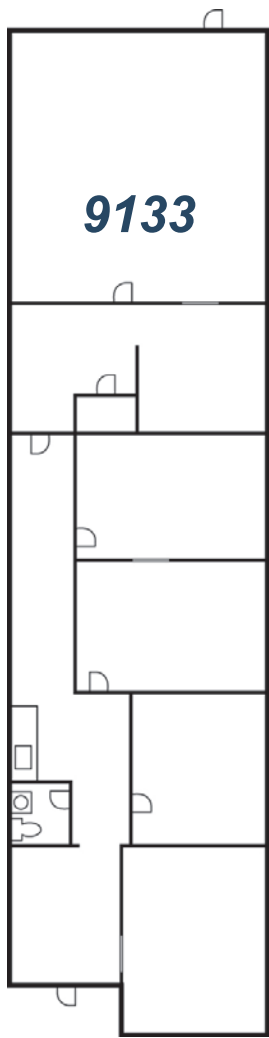

**Jonathan Danton**  
Associate  
Lic #01800488  
858.458.3376  
jdanton@voitco.com

**Glen Volk, SIOR**  
Senior Vice President  
Lic #00859621  
858.458.3370  
gvolk@voitco.com

**Randy LaChance, SIOR**  
Senior Vice President  
Lic #00969674  
858.458.3374  
rlachance@voitco.com

**Voit**  
REAL ESTATE SERVICES