

### HIGHLIGHTS

- New construction retail center approximately 11,800 SF
- Anchored by Panera Bread; plus Pearle Vision, Sprint and 2,951SF available for lease
- Located 400 yards west of I-71-75 Buttermilk Pike exit
- High traffic counts: in excess of 35,000 VPD on Buttermilk Pike
- Timing: Approximate delivery March, 2019

### DEMOGRAPHICS

2018 Estimate	1 Mile	3 Miles	5 Miles
Population	9,986	57,351	196,538
Households	4,409	24,579	82,693
Average HH Income	\$92,858	\$86,803	\$69,396
Daytime Employees	7,391	47,004	149,406

### CONTACT:

Scott Mitchell • smitchell@anchor-associates.com

Office Phone • 513.784.1106

Cell Phone • 513.349.1201

Website • www.anchor-associates.com

### ANCHOR ASSOCIATES

3825 Edwards Road, Suite 630

Cincinnati, OH 45209

513.784.1106



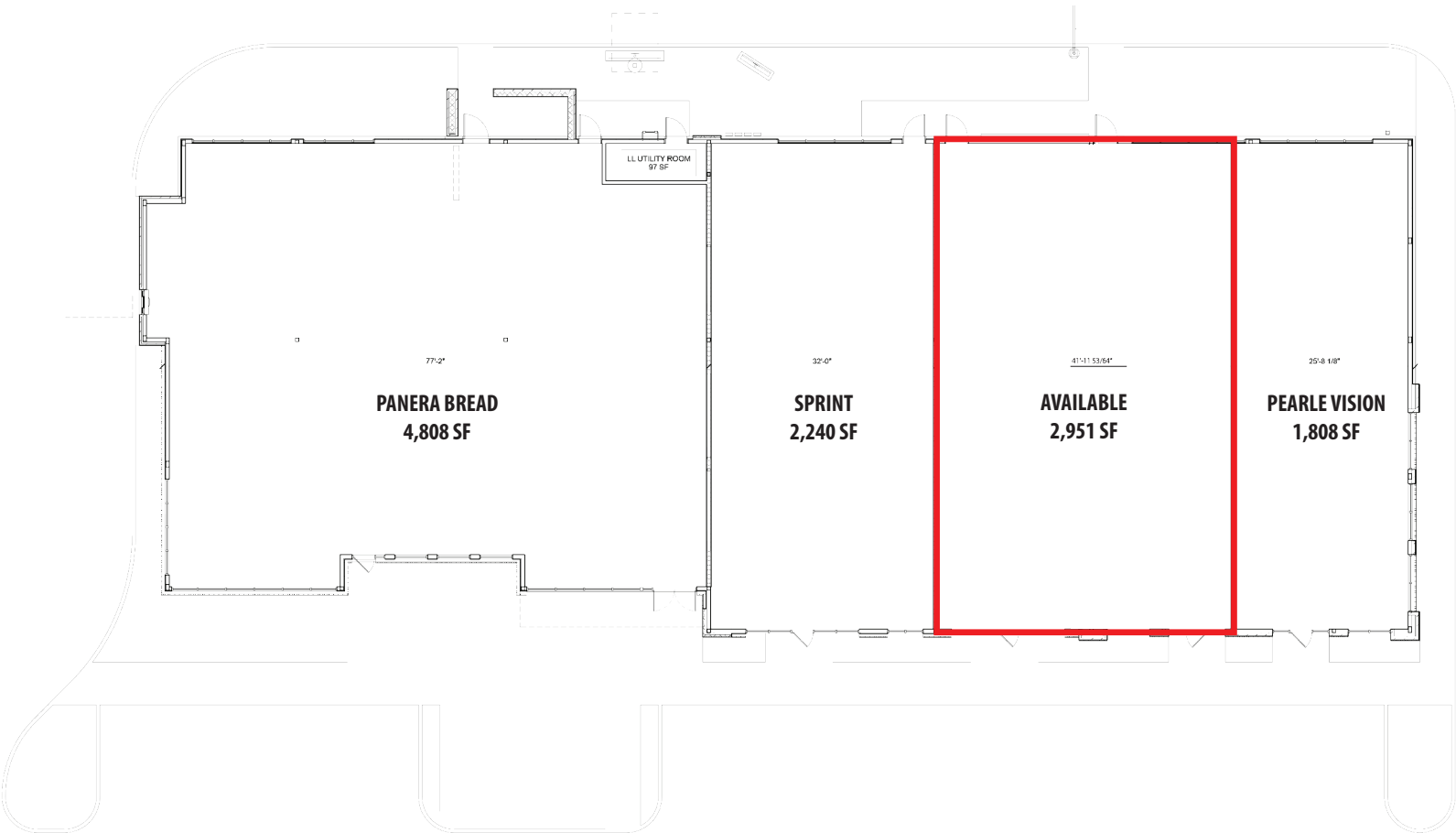

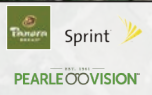

Crescent Springs Pike

371



149,506 VPD



35,995 VPD



Buttermilk Pike

