

PRIME RETAIL SPACE ADJACENT TO KOHL'S

Macon, GA 31210 | 6275 Zebulon Road | Zebulon Rd & Peake Rd | #992



AVAILABLE SF:
24,200 SF

FRONTAGE:
APPROX. 98'2"

ZONING:
COMMERCIAL

RATES:
CALL FOR DETAILS

AREA ANCHORS



- 24,200 SF junior anchor end cap available
- Adjacent retailers include Lowe's, Walmart and Kroger
- Numerous access points via Zebulon Rd and Peake Rd

DEMOGRAPHICS	1 MILE	3 MILES	5 MILES	TRAFFIC COUNTS	
2018 POPULATION	3,204	19,614	49,546	Zebulon Road	26,800 AADT
2018 DAYTIME POPULATION	4,314	14,354	46,052	I-475	53,100 AADT
2018 AVERAGE HH INCOME	117,878	105,753	90,691		
2018 MEDIAN HH INCOME	82,366	75,878	63,437		



FOR MORE INFORMATION, CONTACT EXCLUSIVE AGENT(S):
PATRICK BENTLEY • patrick.bentley@tscg.com • 770.955.2434

Demographics: Esri 2018 No warranty expressed or implied has been made as to the accuracy of the information provided herein, no liability assumed for error or omissions.



PRIME RETAIL SPACE ADJACENT TO KOHL'S

Macon, GA 31210 | 6275 Zebulon Road | Zebulon Rd & Peake Rd | #992



FOR MORE INFORMATION, CONTACT EXCLUSIVE AGENT(S):
 PATRICK BENTLEY • patrick.bentley@tscg.com • 770.955.2434



Demographics: Esri 2018 No warranty expressed or implied has been made as to the accuracy of the information provided herein, no liability assumed for error or omissions.

PRIME RETAIL SPACE ADJACENT TO KOHL'S

Macon, GA 31210 | 6275 Zebulon Road | Zebulon Rd & Peake Rd | #992



FOR MORE INFORMATION, CONTACT EXCLUSIVE AGENT(S):
PATRICK BENTLEY • patrick.bentley@tscg.com • 770.955.2434

TSCG

Stan Johnson Co.
THE NET LEASE AUTHORITY®

CHAINLINKS
RETAIL ADVISORS

Demographics: Esri 2018 No warranty expressed or implied has been made as to the accuracy of the information provided herein, no liability assumed for error or omissions.

PRIME RETAIL SPACE ADJACENT TO KOHL'S

Macon, GA 31210 | 6275 Zebulon Road | Zebulon Rd & Peake Rd | #992

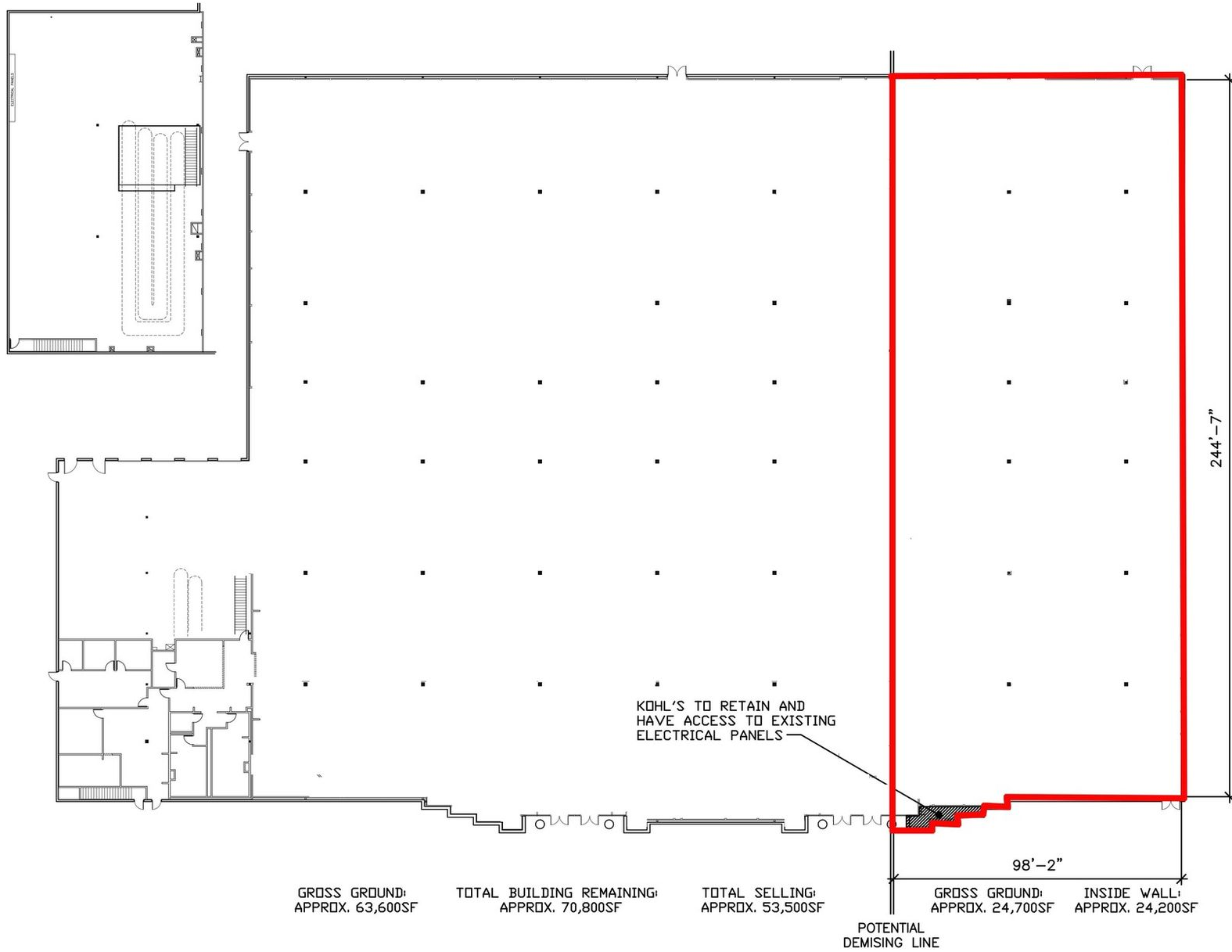

#10992 Macon, GA
Updated: 3/6/18



FOR MORE INFORMATION, CONTACT EXCLUSIVE AGENT(S):
PATRICK BENTLEY • patrick.bentley@tscg.com • 770.955.2434

