

1100 TECHNOLOGY PARK DRIVE

Billerica, MA

FIRST FLOOR: 32,000 SF

DEDICATED
ENTRANCE

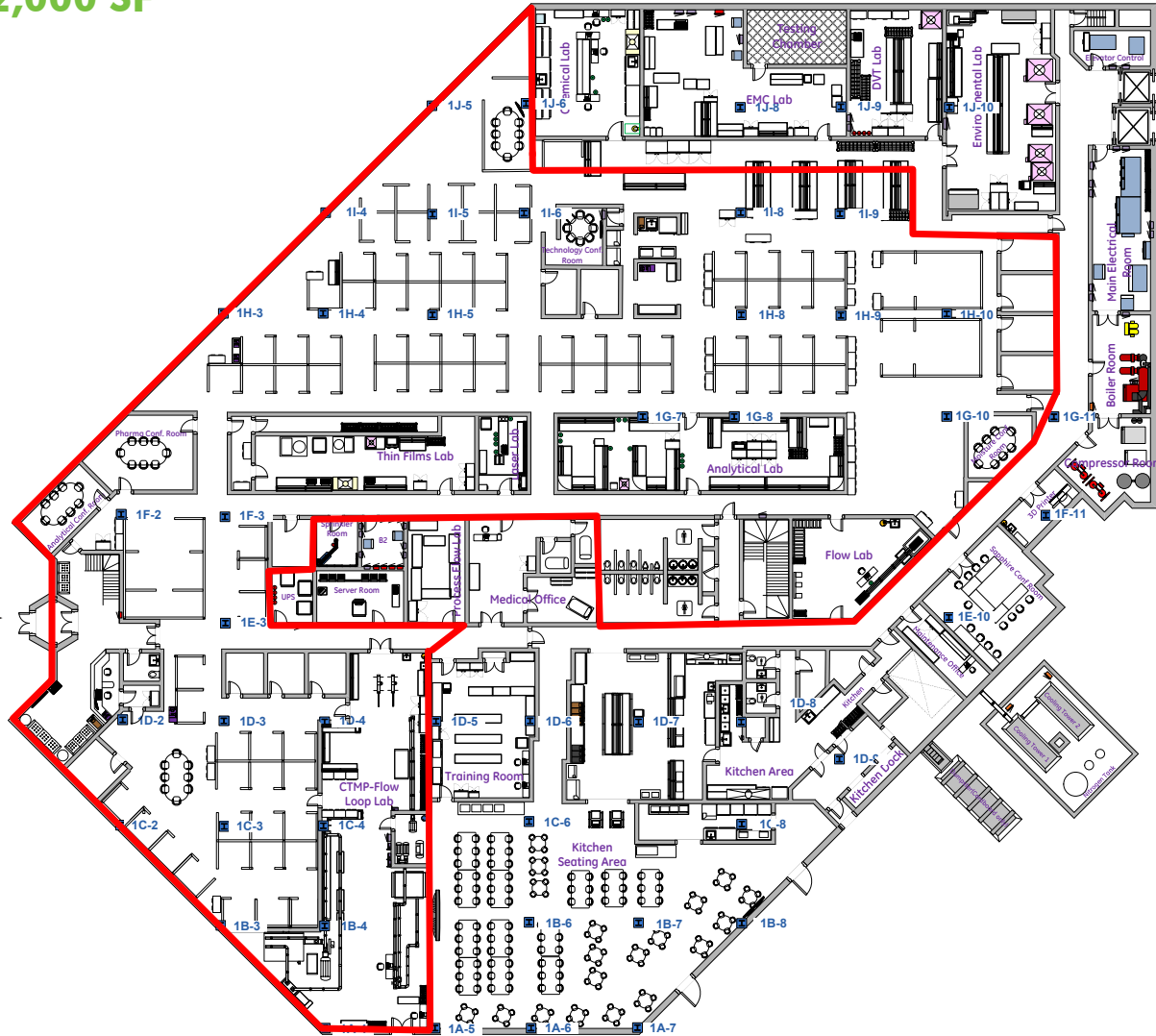

1100 TECHNOLOGY PARK DRIVE

Billerica, MA

SECOND FLOOR: 20,500 SF

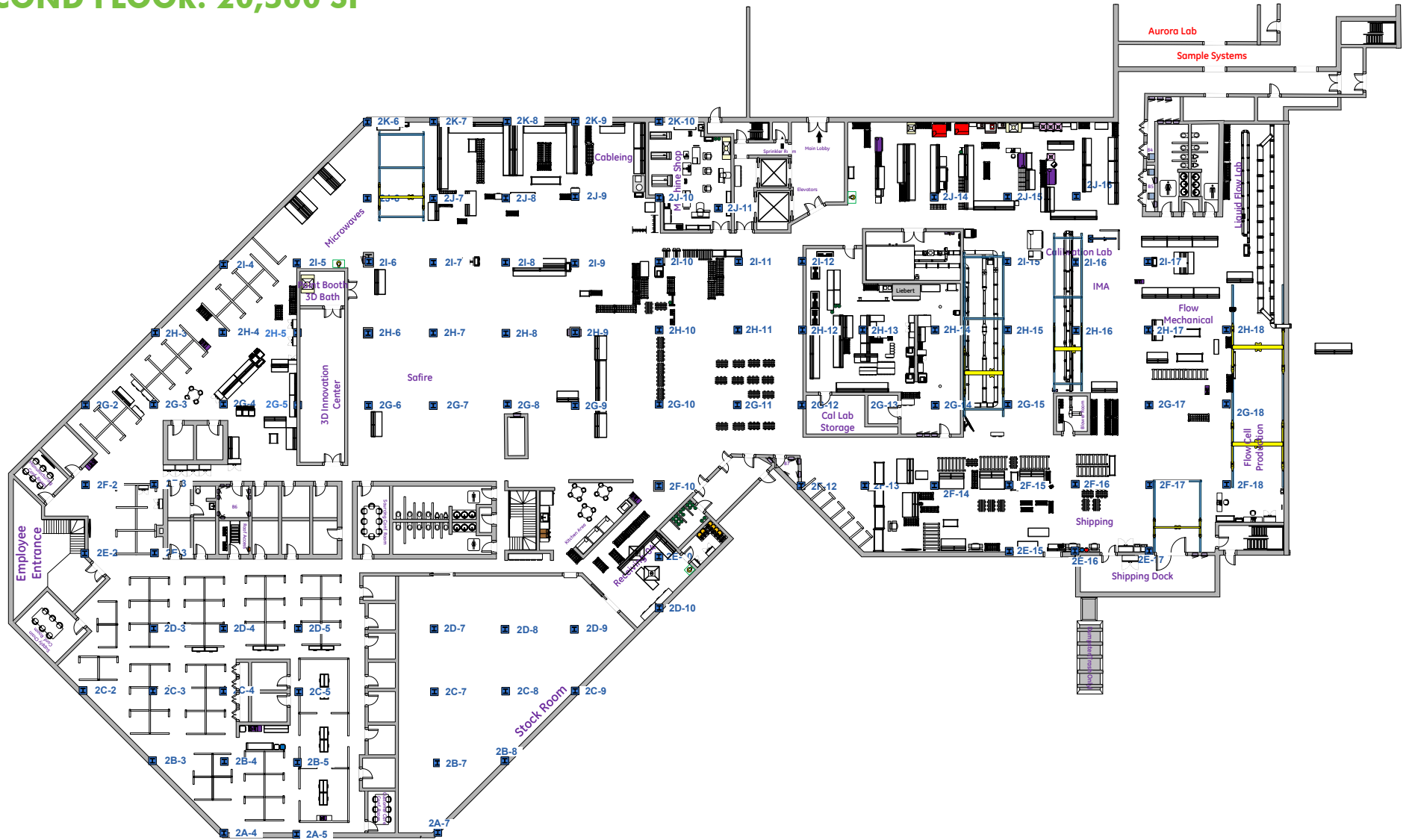

1100 TECHNOLOGY PARK DRIVE

Billerica, MA

THIRD FLOOR: 6,600 SF

