1620 Fulton Street Retail/Restaurant Spaces for Lease

BED-STUY
BROOKLYN, NY



NEWMARK

1620 Fulton Street

Location

South block between Albany and Troy Avenue

Approximate Size

Ground Floor 7,565 SF (divisible)

Basement 2,275 SF

Ceiling Height

Ground Floor 15 FT

Frontage

Up to 75 FT

Possession

Immediate

Site Status

New Construction

Neighbors

Super Foodtown, Interfaith Medical Center, Fine Fare Supermarket, United States Postal Service, Mercy College, Fulton Bikes, Popeye's, Applebee's Grill & Bar, McDonald's, Fulton Park, St. Andrew's Playground and Dollar Tree

Comments

Brand new retail space at the base of The Garnet, a 130-unit residential development in historic Bed-Stuy.

All uses considered.

Easy venting ability for cooking.

Ground Floor (Proposed Divisions)

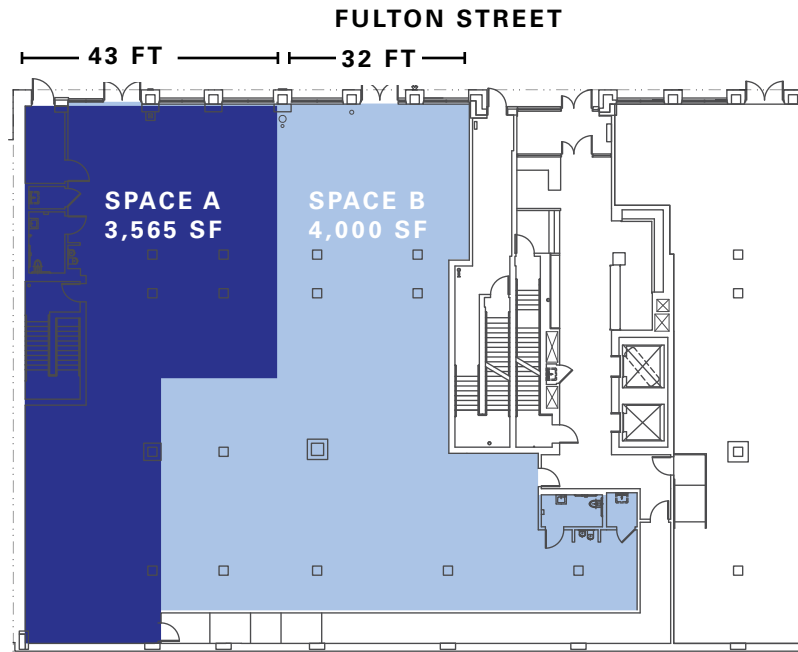

Basement

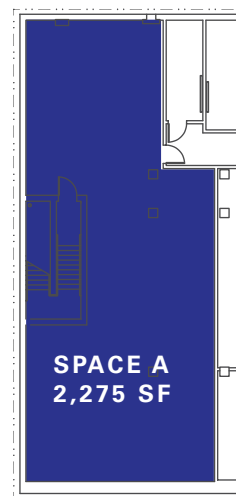

STOREFRONT RENDERINGS AND PHOTOS



AREA MAP



CONTACT

Marc Frankel
t 212-372-2240
mfrankel@ngkf.com

Aric Trakhtenberg
t 212-916-3386
aric.trakhtenberg@ngkf.com

Jeffrey D Roseman
t 212-372-2430
jroseman@ngkf.com

nmrk.com