



236 St. George Ave.

Jefferson, Louisiana 70121

Property Highlights

- ± 9,450 SF total warehouse
- 12' eave, 14' peak
- Two (2) dock high doors 8'x10'
- ± 1,545 SF air conditioned office
- Two (2) baths
- One (1) kitchenette
- M-1 zoning
- Located near US-90, US-61 and I-10

Lease Rate

\$5.50 SF/yr (NNN)

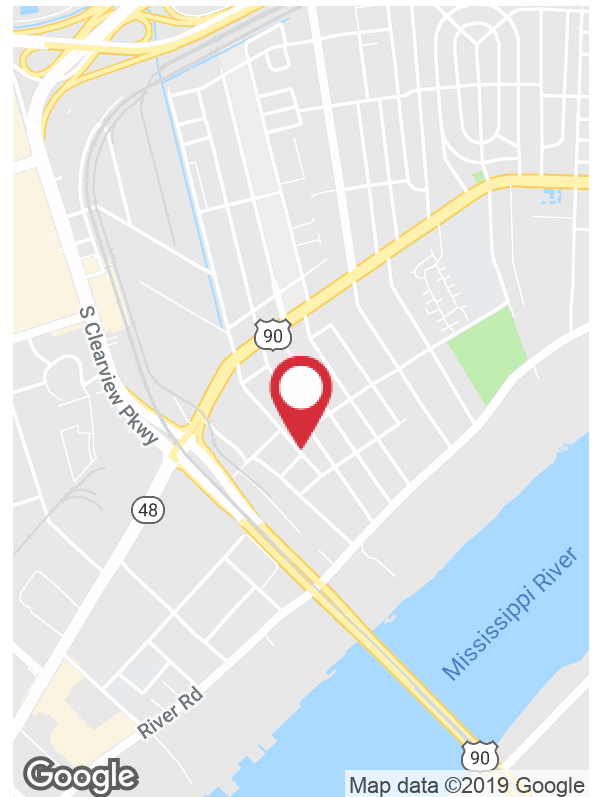

For more information

Duff Friend, SIOR

O: 504 569 9351 | C: 504 909 7351
dfriend@latterblum.com

430 Notre Dame Street
New Orleans, LA 70130
504 525 1311 tel
latterblum.com

NO WARRANTY OR REPRESENTATION, EXPRESS OR IMPLIED, IS MADE AS TO THE ACCURACY OF THE INFORMATION CONTAINED HEREIN, AND THE SAME IS SUBMITTED SUBJECT TO ERRORS, OMISSIONS, CHANGE OF PRICE, RENTAL OR OTHER CONDITIONS, PRIOR SALE, LEASE OR FINANCING, OR WITHDRAWAL WITHOUT NOTICE, AND OF ANY SPECIAL LISTING CONDITIONS IMPOSED BY OUR PRINCIPALS NO WARRANTIES OR REPRESENTATIONS ARE MADE AS TO THE CONDITION OF THE PROPERTY OR ANY HAZARDS CONTAINED THEREIN ARE ANY TO BE IMPLIED. LICENSED IN LOUISIANA.

Warehouse Photos



Office Photos



Location Maps

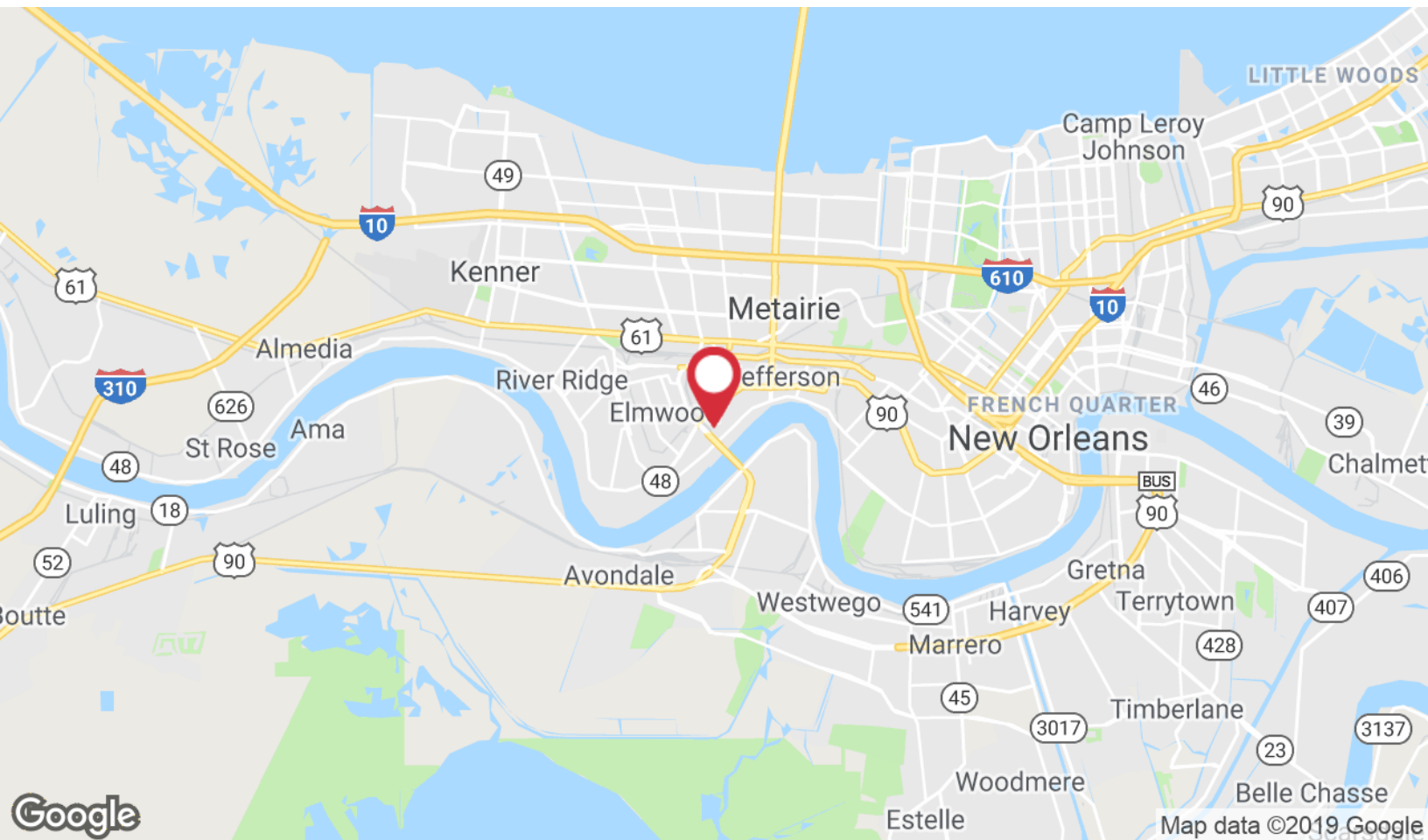

430 Notre Dame Street
New Orleans, LA 70130
504 525 1311 tel
latterblum.com

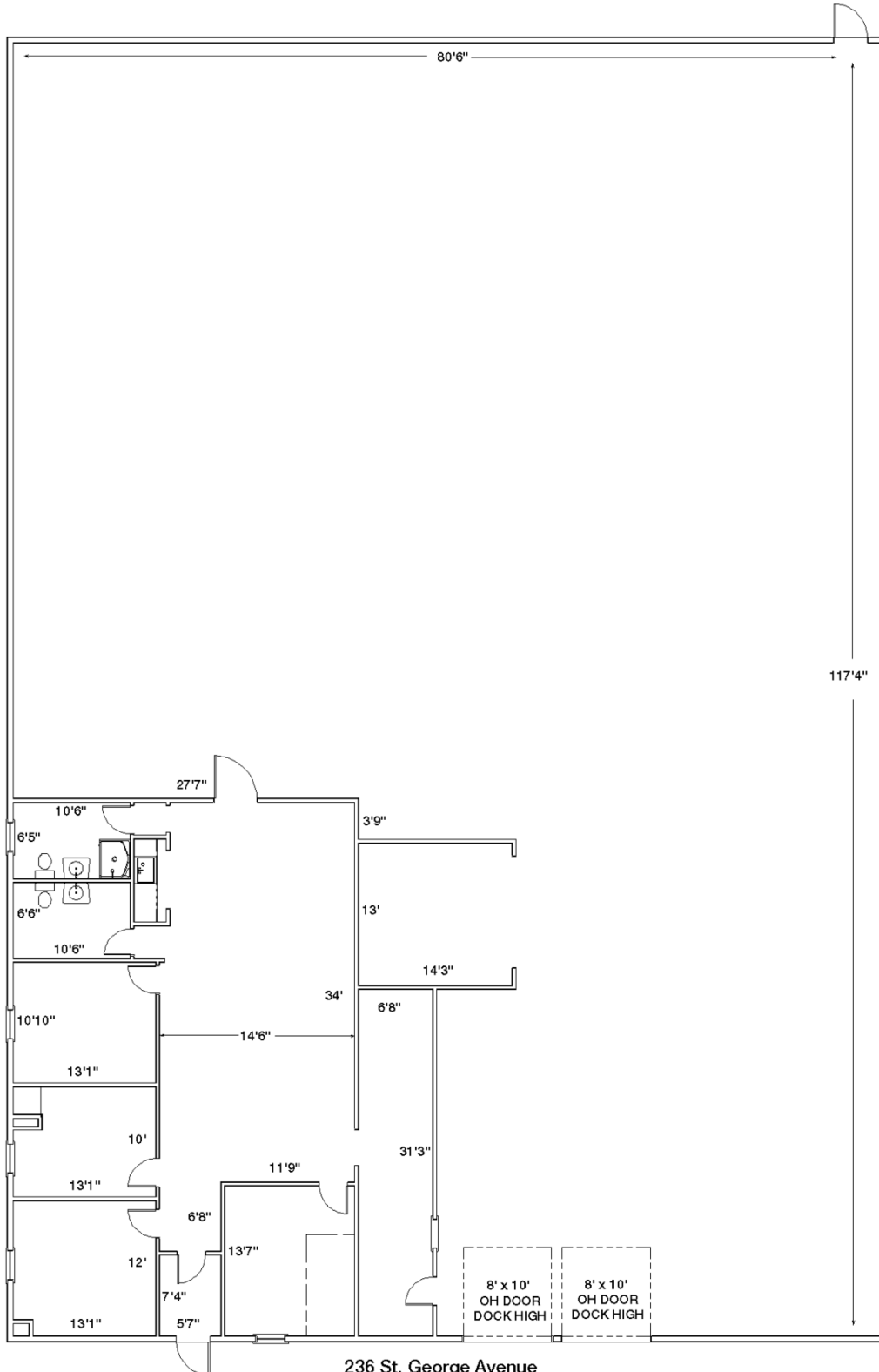

236 St. George Avenue
Elmwood, LA

*Not drawn to scale, for illustration purposes only

Total ± 9,450 SF
Office ± 1,545 SF