

Port 106 Bldg

FOR LEASE - 4,800 SF Total



4746 Ohio Ave S Seattle, WA 98134

4,800 Total SF/ 800 SF of Office

Paint booth available

Located just south of downtown Seattle and minutes from the Port of Seattle

Adjacent to East Marginal Way with convenient I-5 access via S Spokane & Michigan St

Located on city bus routes

Space has been off market for years & available now

CH: approx. 18', Zoning: M-1, Seattle

Dock high loading door and drive-in ramps

Heavy 3 phase power

Call Broker for Rates



BRUCE CLARKSON

206-399-6218

bclarkson@andoverco.com

**THE ANDOVER
COMPANY, INC.**
CORFAC INTERNATIONAL

The information contained herein has been obtained from reliable sources, but is not guaranteed. A prospective buyer/tenant should verify each item relating to this property and all information contained herein.

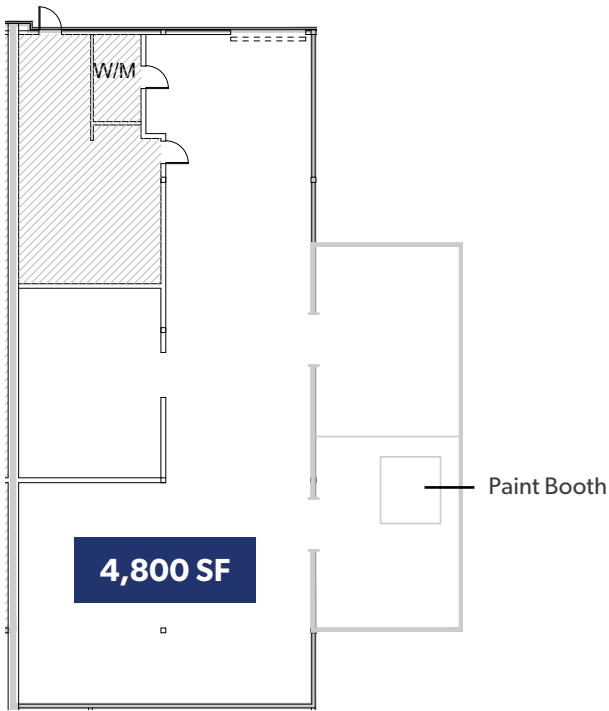

BRUCE CLARKSON
206-399-6218
bclarkson@andoverco.com

**THE ANDOVER
COMPANY, INC.**
CORFAC INTERNATIONAL

The information contained herein has been obtained from reliable sources, but is not guaranteed. A prospective buyer/tenant should verify each item relating to this property and all information contained herein.