



11949 Bricksome Ave

Baton Rouge, Louisiana 70816

Property Highlights

- ± 2,950 SF Office Space Available
- Comprised of Four ± 725 - 750 SF Suites
- Owner Occupies Suite A & B, Suite C & D are Currently Leased
- Current Owner Willing to Rent in Regard to Sale
- Investment Opportunity
- Located on Bricksome Ave off S Sherwood Forest Blvd

Sale Price

\$230,000



For more information

Austin Bain

O: 225 295 0800 | C: 225 978 9966
austinbain@latterblum.com

Will Watson

O: 225 295 0800 | C: 318 914 1576
willwatson@latterblum.com

CALL OR EMAIL FOR MORE INFORMATION

NO WARRANTY OR REPRESENTATION, EXPRESS OR IMPLIED, IS MADE AS TO THE ACCURACY OF THE INFORMATION CONTAINED HEREIN, AND THE SAME IS SUBMITTED SUBJECT TO ERRORS, OMISSIONS, CHANGE OF PRICE, RENTAL OR OTHER CONDITIONS, PRIOR SALE, LEASE OR FINANCING, OR WITHDRAWAL WITHOUT NOTICE, AND OF ANY SPECIAL LISTING CONDITIONS IMPOSED BY OUR PRINCIPALS NO WARRANTIES OR REPRESENTATIONS ARE MADE AS TO THE CONDITION OF THE PROPERTY OR ANY HAZARDS CONTAINED THEREIN ARE ANY TO BE IMPLIED. LICENSED IN LOUISIANA.

1700 City Farm Drive
Baton Rouge, LA 70806
225 295 0800 tel
latterblum.com

Additional Photos



Subject Property

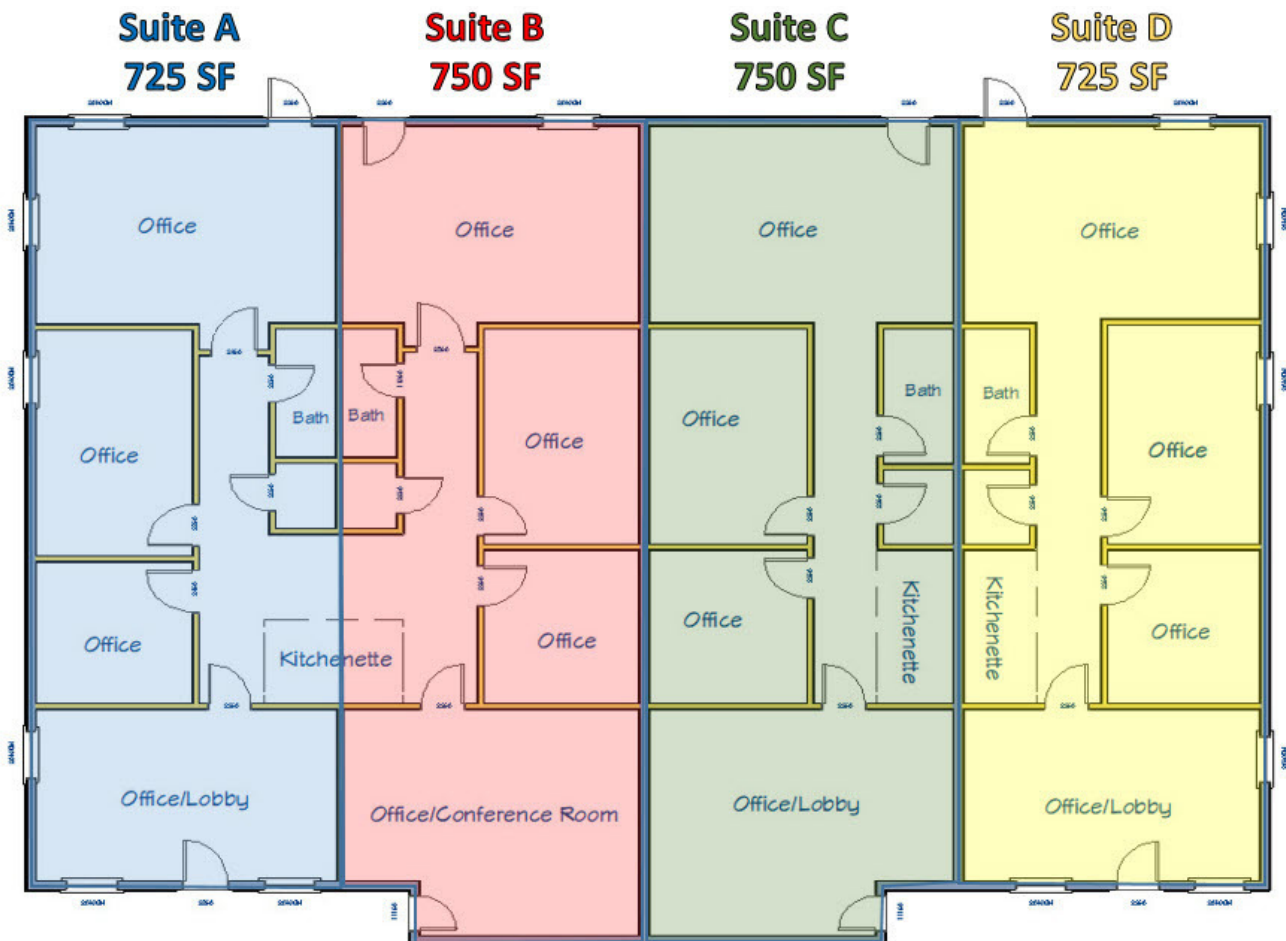

1700 City Farm Drive
Baton Rouge, LA 70806
225 295 0800 tel
latterblum.com

Location Maps

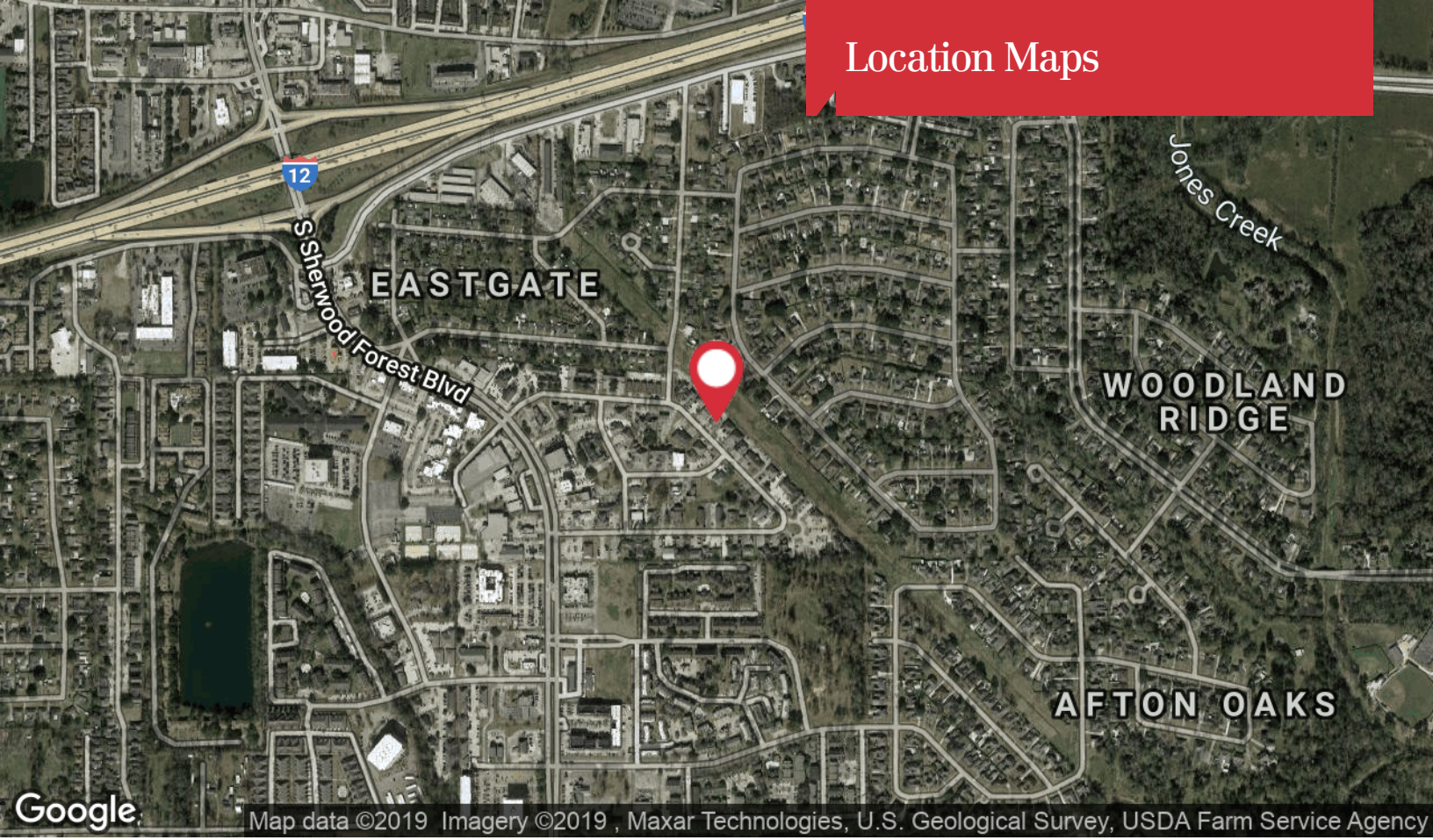

Map data ©2019 Imagery ©2019, Maxar Technologies, U.S. Geological Survey, USDA Farm Service Agency



Map data ©2019