



Retail For Sale or Lease

Property Name:
Location: 19218 Eureka Road
City, State: Southgate, MI
Cross Streets: Allen Road
County: Wayne
Zoning: C-2
Year Built: N/A

Total Building Sq. Ft.:	3,680	Property Type:	General Retail-Commercial
Available Sq. Ft.:	3,680	Bldg. Dimensions:	N/A
Min Cont. Sq. Ft.:	3,680	Total Acreage:	0.31
Max Cont. Sq. Ft.:	3,680	Land Dimensions:	N/A
Ceiling Height:	N/A	Parking:	Ample
Overhead Door(s) / Height:	0	Curb Cuts:	2
Exterior Construction:	Masonry	Power:	N/A
Structural System:	N/A	Restrooms:	Yes
Heating:	Yes	Sprinklers:	No
Air-Conditioning:	N/A	Signage:	Building & Pylon
Basement:	No	Roof:	Flat/Truss
Number of Stories:	0	Floors:	N/A
Condition:	N/A	Delivery Area:	N/A

Population:	Median HH Income:	Traffic:	Yr: 2020	Count: 23,150	Eureka Rd. W. of Allen Rd. 2-Way
1 Mile: 6,506	1 Mile: \$54,449	Yr: 2020	Count: 39,904	Eureka Rd. E. of Allen Rd. 2-Way	
3 Miles: 83,286	3 Miles: \$62,636	Yr: 2020	Count: 35,781	Allen Rd. N. of Eureka Rd. 2-Way	
5 Miles: 223,856	5 Miles: \$61,568	Yr: 2020	Count: 20,189	Allen Rd. S. of Eureka Rd. 2-Way	

Current Tenant(s): N/A **Major Tenants:** N/A

Lease Rate:	TBD	Improvement Allowance:	N/A
Lease Type:	TBD	Options:	N/A
Monthly Rate:	TBD	Taxes:	
Lease Term:	N/A	TD:	N/A
Security Deposit:	N/A	Parcel #:	53-015-02-005-6000
Sale Price:	\$500,000 (\$135.87/sqft)	Assessor #:	N/A
Sale Terms:	N/A	Date Available:	Immediately

Utilities	Electric: Yes
Sanitary Sewer: No	Gas: No
Storm Sewer: No	Water: Yes

Tenant Responsibilities: N/A

Comments: Corner lot can be combined with adjacent parcel to form over 1.24 acres, 2 buildings, 240' feet of frontage on Eureka Road. Heavily traveled retail corridor near I-75, Southland Mall, and Detroit Metro Airport.

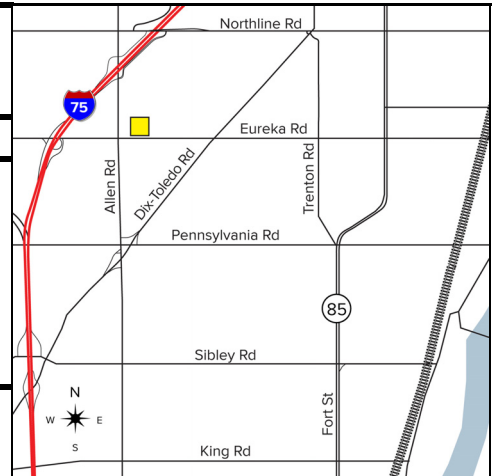

Broker: SIGNATURE ASSOCIATES

Agent(s):
Justin Gaffrey, (248) 799-3143, jgaffrey@signatureassociates.com