

# MARCOS DE NIZA PLAZA

T E M P E • A R I Z O N A



## 705 East Guadalupe Road • Tempe, Arizona 85283

For further information, please contact:

**Michael A. Pollack**  
(480) 888-0888

**Size:** 66,600 Square Feet    **Spaces Starting From:** 1,200 Sq. Ft.

**Zoning:** C-2, City of Tempe

**Traffic Counts:** Corner Total: 51,376  
Guadalupe Rd: 21,981 cars/day • Rural Road: 29,395 cars/day  
(2009: City of Tempe)

**Demographics:**

(2010: Applied Geographic Solutions / TIGER Geography)

	1 mile radius	3 mile radius	5 mile radius
Population:	13,830	124,220	369,787
Households:	5,266	45,747	136,083
Median Household Income:	\$ 70,579	\$ 68,677	\$ 60,372
Median Age:	36	34	32

For leasing plans, availability and rates, visit us at:

[www.pollackinvestments.com/marcos](http://www.pollackinvestments.com/marcos)



*Michael A. Pollack*  
**REAL ESTATE INVESTMENTS**

The information contained herein are estimates obtained from sources we deem reliable. While we have no reason to doubt its accuracy, we do not guarantee it.

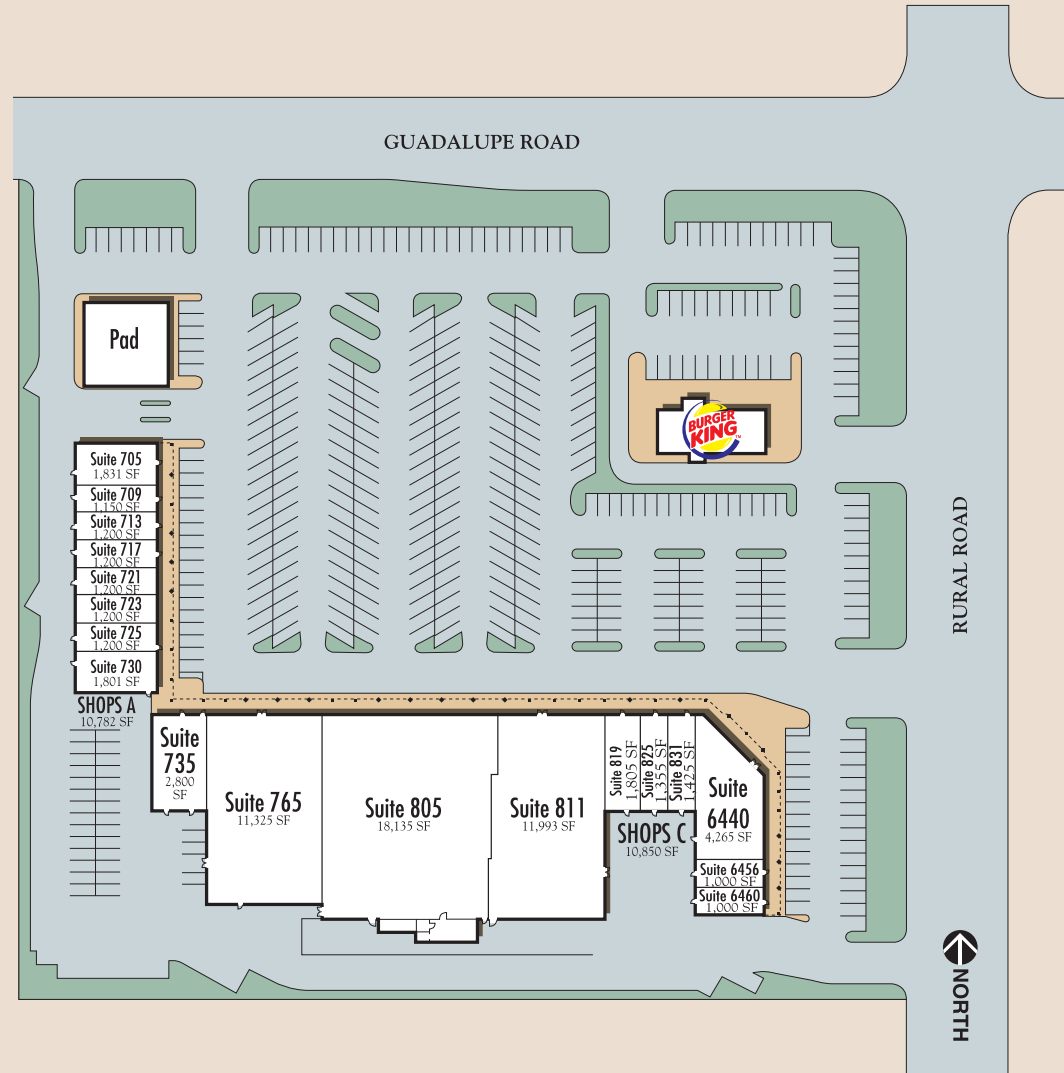

For further information, please contact:  
**Michael A. Pollack**  
 (480) 888-0888

*Michael A. Pollack*  
**REAL ESTATE INVESTMENTS**

\* Square foot indications are approximate

1136 West Baseline Road • Mesa, Arizona 85210 • (480) 888-0888 • fax (480) 814-7741 • www.pollackinvestments.com