

Aeroterm Building II

5337 NE Courier Court
Suite 200 C
Portland, OR 97218

3,855 SF Available

Suite 200 C: 3,855 SF with
553 SF office

22' clear height

2 dock high loading doors

1 grade level loading door

Potential for additional
trailer storage

Call for pricing



Location



Contact

Tony Reser, SIOR

503.221.2271

treser@kiddermathews.com

Tom Talbot, SIOR

503.221.2270

ttalbot@kiddermathews.com

Scott Murphy

503.221.2287

smurphy@kiddermathews.com

Aeroterm Building II

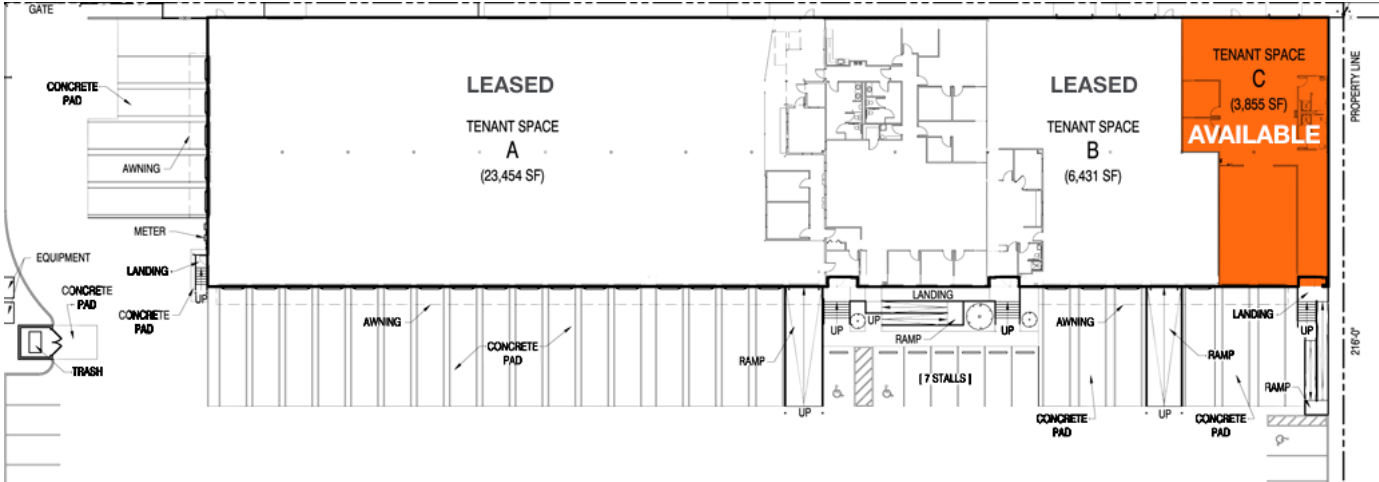

Contact

Tony Reser, SIOR
 503.221.2271
 treser@kiddermathews.com

Tom Talbot, SIOR
 503.221.2270
 ttalbot@kiddermathews.com

Scott Murphy
 503.221.2287
 smurphy@kiddermathews.com

Aeroterm Building II

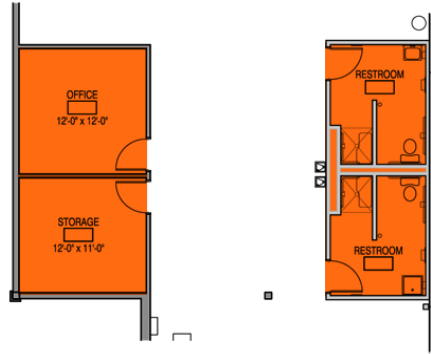

6 TENANT SPACE C - OFFICE SPACE
A-201 1/8" = 1'-0" 

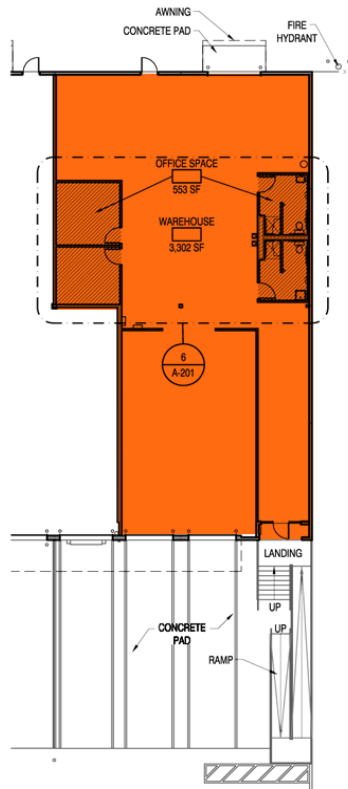

3 TENANT SPACE C OVERALL
A-201 1/16" = 1'-0" 

Contact

Tony Reser, SIOR
503.221.2271
treser@kiddermathews.com

Tom Talbot, SIOR
503.221.2270
ttalbot@kiddermathews.com

Scott Murphy
503.221.2287
smurphy@kiddermathews.com