



WOODCREST

CORPORATE CENTER



101 and 111 Woodcrest Road, Cherry Hill, NJ 08003

Prime leasing opportunity in one of Southern New Jersey's most sought after office locations.

- Two Class A office buildings totaling 385,923 SF
- Availabilities from 2,000 SF to 159,000 SF
- Open floor plates to maximize flexibility and space planning options
- Light filled spaces with 22' ceilings, oversized windows, and skylights
- Desirable creative space built out with exposed ceilings, raised flooring, and collaborative areas
- Completely renovated in 2004 with top of the line finishes and thoroughly upgraded building systems
- Independent HVAC controls and dedicated backup generator allow 24/7 operations
- Ideal transit-oriented location immediately off I-295
- Adjacent to PATCO High Speed Rail Line's Woodcrest Station, less than 15 minute ride from Center City Philadelphia
- Close proximity to an amenity rich environment in Cherry Hill and the recently re-developed Voorhees Town Center
- Generous parking with 4.75 space per 1,000 SF ratio (1,835 spaces total)





WOODCREST
CORPORATE CENTER



Woodcrest offers an unbeatable opportunity to attract best-in-class talent with a highly accessible location, a light-filled creative office environment, and close proximity to top area amenities.

Available: Suite 131
92,506 SF divisible

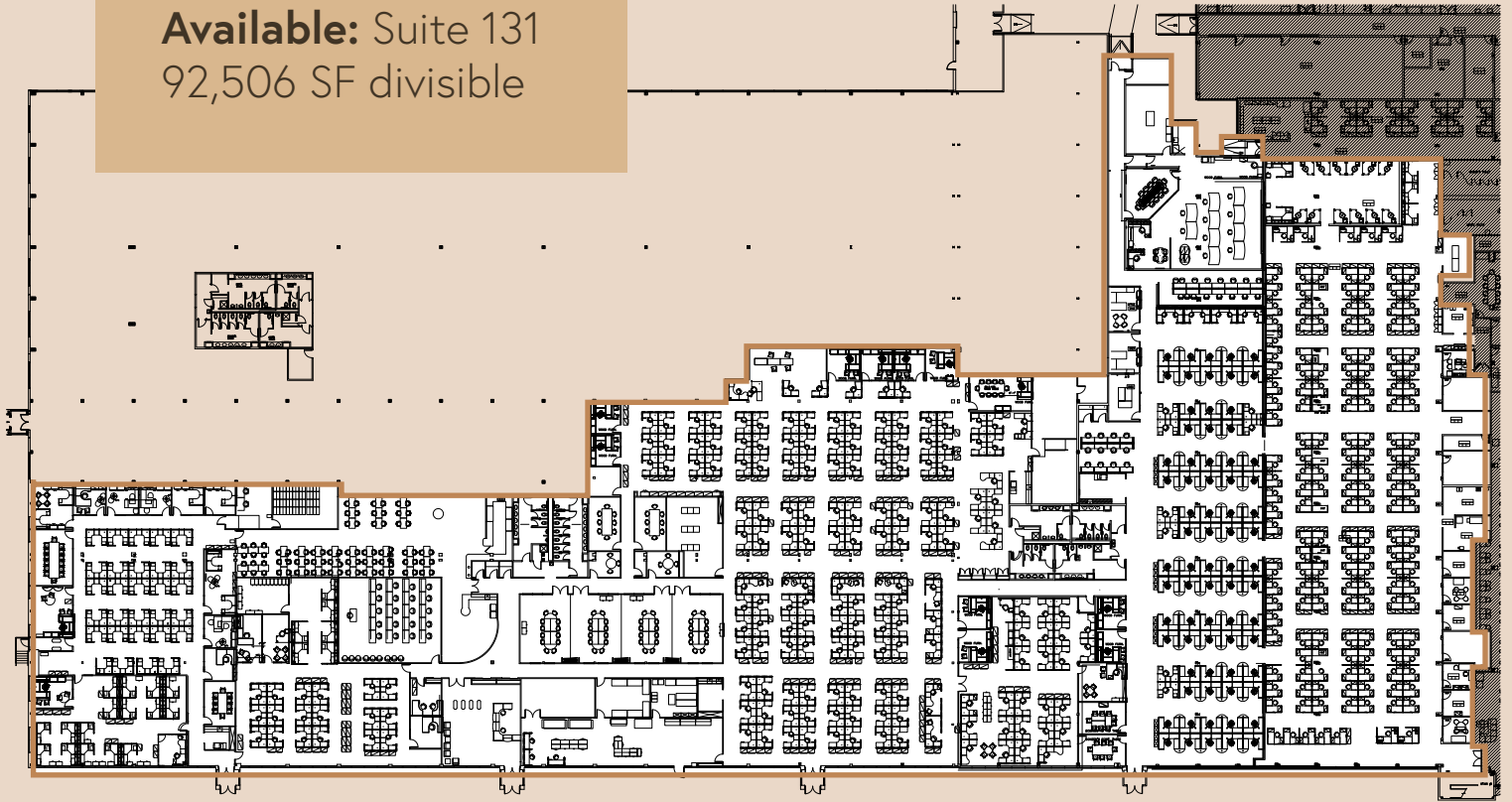

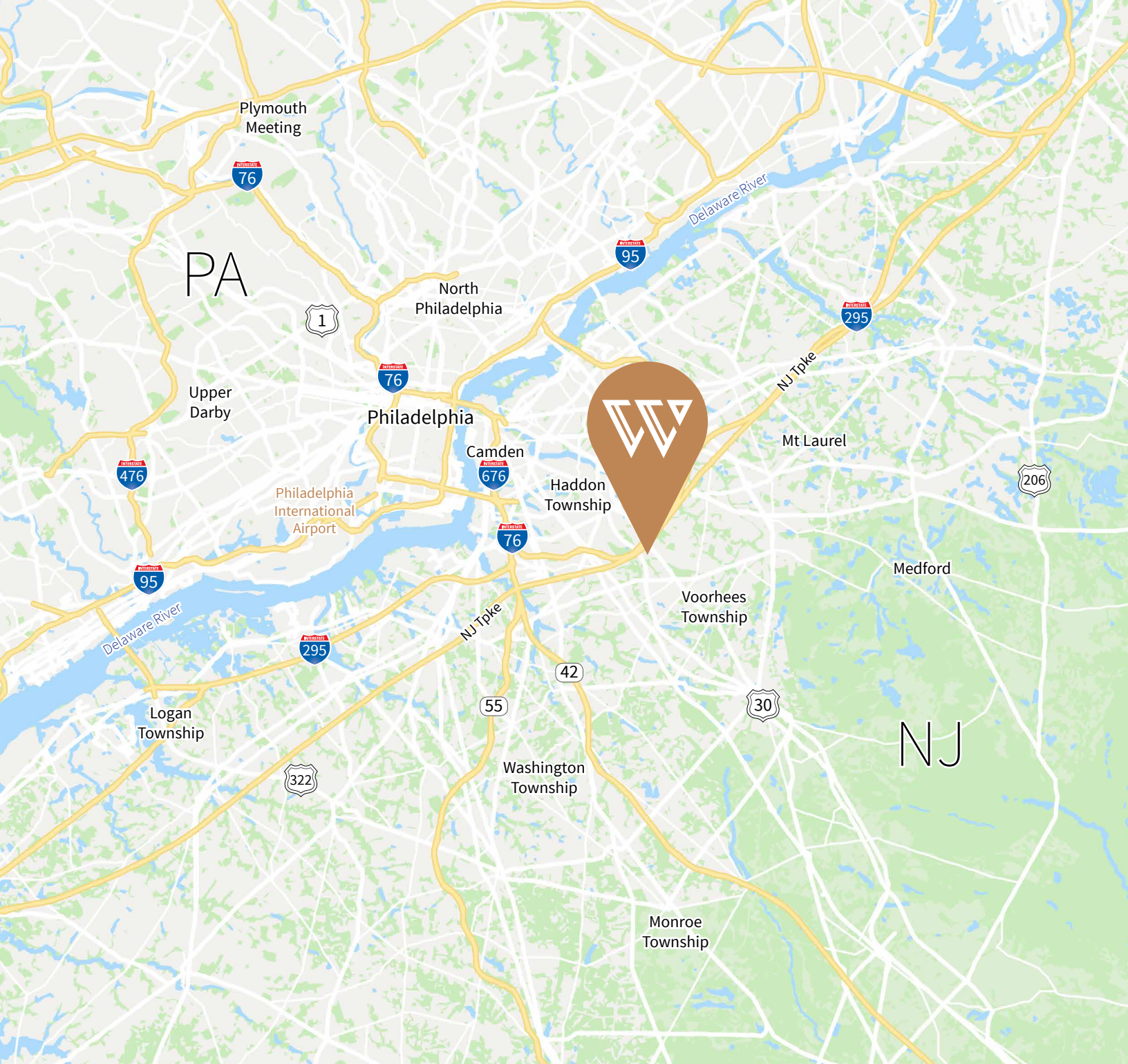

WOODCREST
CORPORATE CENTER

TIER REIT



Leasing information:

C. Andrew McGowan
Executive Vice President
+1 215 988 5566
drew.mcgowan@am.jll.com

Dan Close
Vice President
+1 856 324 5306
dan.close@am.jll.com

JLL | Jones Lang LaSalle
1650 Arch Street, suite 2500
Philadelphia PA 19103
+1 215 988 5500

Although information has been obtained from sources deemed reliable, Owner, Jones Lang LaSalle, and/or their representatives, brokers or agents make no guarantees as to the accuracy of the information contained herein, and offer the Property without express or implied warranties of any kind. The Property may be withdrawn without notice. ©2018. Jones Lang LaSalle. All rights reserved.