

49,300 SF

Industrial Space For Lease



Prologis Portview Commerce Center 2

560 Bercik Street
Elizabeth, NJ 07201 USA

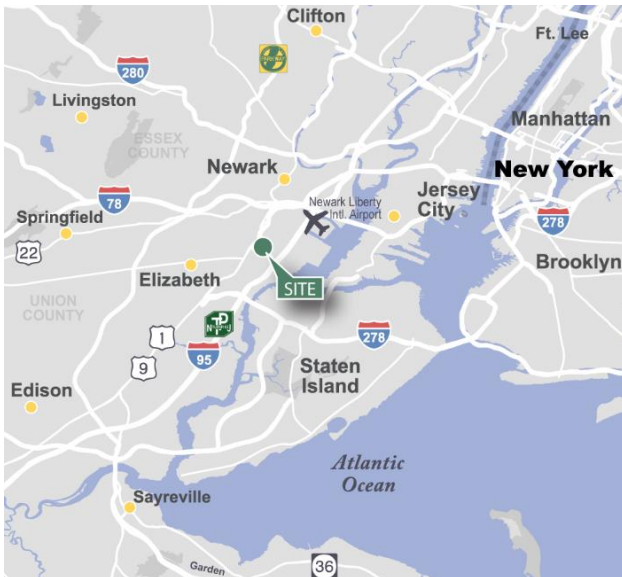

LOCATION

- Immediate access to NJ Turnpike Exit 13A and Routes 1 & 9
- ± 2 miles from Newark Liberty International Airport
- ± 5 miles from Port Newark-Elizabeth
- ± 15 miles to New York City via Holland Tunnel and Verrazzano-Narrows Bridge

FACILITY

- Available March 1, 2021
- 143,756 SF total building size
- 49,300 SF available space
- 5,135 SF office space
- 30' ceiling height
- 52' x 60' column spacing
- 105' truck court depth
- 9 dock doors
- 1 drive-in door
- 27 car parking spaces
- Power: 1,000 amps, 277/208 volts
- ESFR sprinkler system
- LED Lighting

49,300 SF

Industrial Space For Lease

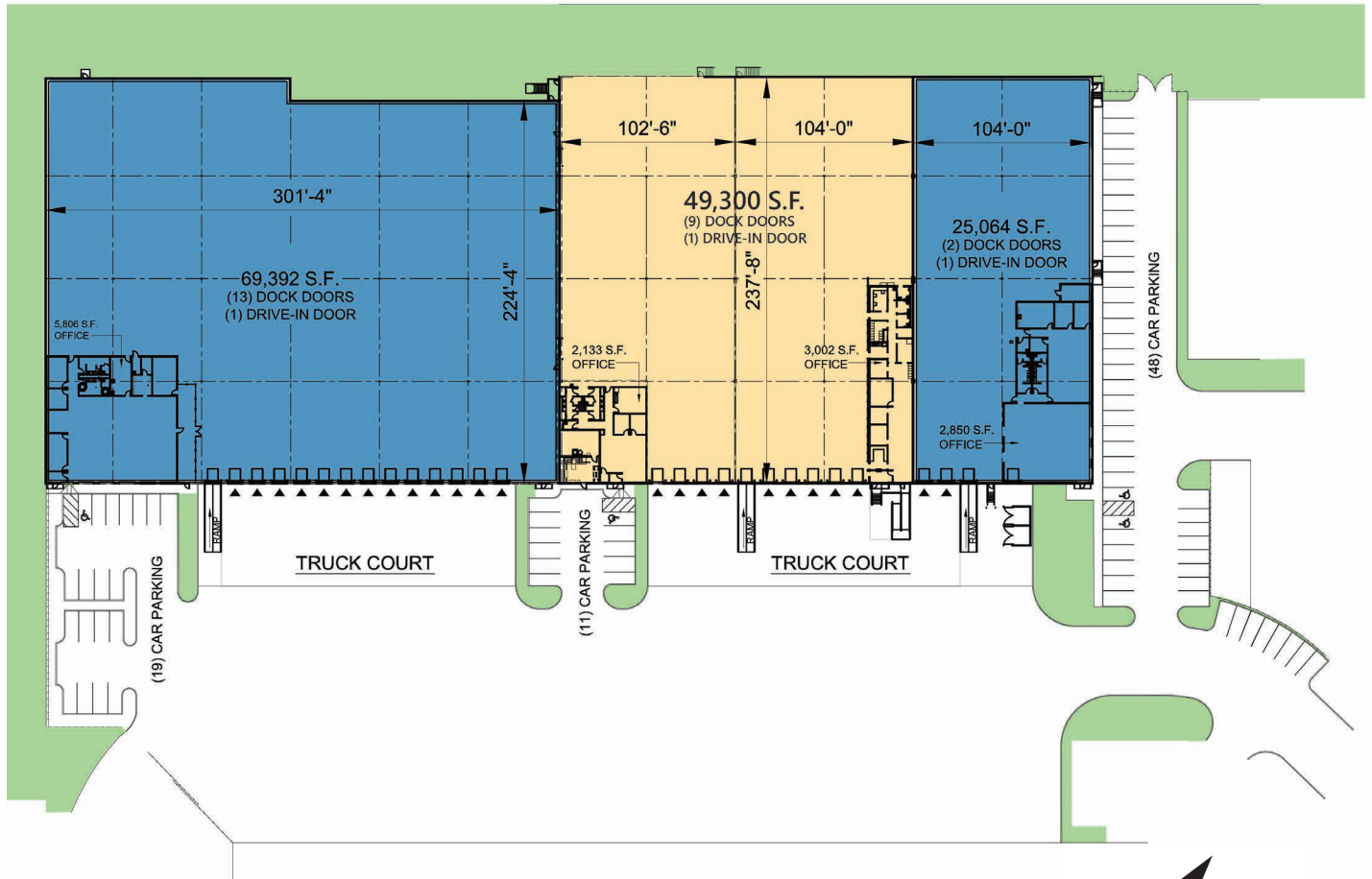

www.PrologisPortview.com



CBRE, Inc.

Thomas F. Monahan
thomas.monahan@cbre.com
ph +1 201 712 5610
cell +1 973 568 6614
Park 80 West
Plaza Two
Saddle Brook, NJ 07663 USA

CBRE, Inc.

Stephen D'Amato
stephen.damato@cbre.com
ph +1 201 712 5616
cell +1 201 306 3788
Park 80 West
Plaza Two
Saddle Brook, NJ 07663 USA

CBRE, Inc.

Larry Schiftenhaus
larry.schiftenhaus@cbre.com
ph +1 201 712 5809
cell +1 201 532 5092
Park 80 West
Plaza Two
Saddle Brook, NJ 07663 USA

Prologis

Andrew Forsyth
aforsyth@prologis.com
ph +1 201 528 9575
cell +1 201 424 6289
One Meadowlands Plaza
Suite 100
East Rutherford, NJ 07073 USA

© 2018 CBRE, Inc. All rights reserved. This information has been obtained from sources believed reliable, but has not been verified for accuracy or completeness. You should conduct a careful, independent investigation of the property and verify all information. Any reliance on this information is solely at your own risk. Photos herein are the property of their respective owners. CBRE and the CBRE logo are service marks of CBRE, Inc. All other marks displayed on this document are the property of their respective owners. Use of these images without the express written consent of the owner is prohibited.

No warranty or representation, expressed or implied, is made as to the accuracy of the information contained herein, and same is submitted subject to error and omissions.

www.prologis.com