

SUB \$10 SPACE IN
GREENWOOD PLAZA

TRIAD SOUTH

5680 GREENWOOD PLAZA BLVD :: GREENWOOD VILLAGE, CO

AVAILABLE NOW



LOCATION MAP

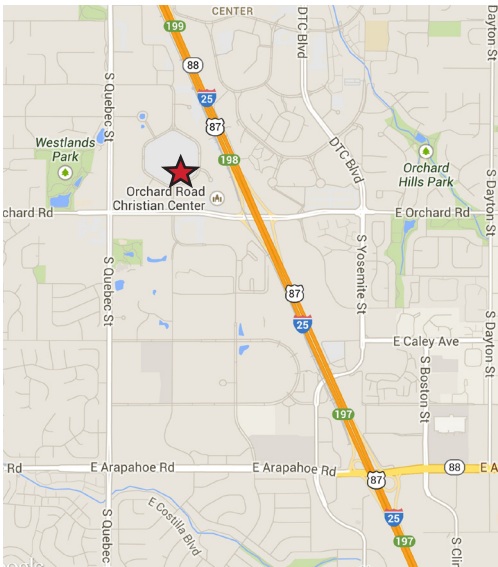

AVAILABLE:	Suite 400S - 23,459 SF
SUBLEASE TERM:	Through November 2017
RATE:	\$9.95
FURNITURE/PHONES:	Partially furnished with phones

HIGHLIGHTS

- :: Outstanding western views
- :: Class B building in the heart of Greenwood Plaza
- :: On-site management office, deli, fitness center
- :: Located on the Orchard Light rail station stop
- :: Large bullpen, training room, conference room, break room

FOR MORE
INFORMATION
PLEASE
CONTACT

Ryan Link
Associate
T 720.528.6303
ryan.link@cbre.com

John Marold
Senior Vice President
T 720.528.6355
john.marold@cbre.com

CBRE

TRIAD SOUTH

5680 GREENWOOD PLAZA BLVD :: GREENWOOD VILLAGE, CO



Suite 400S
23,459 SF

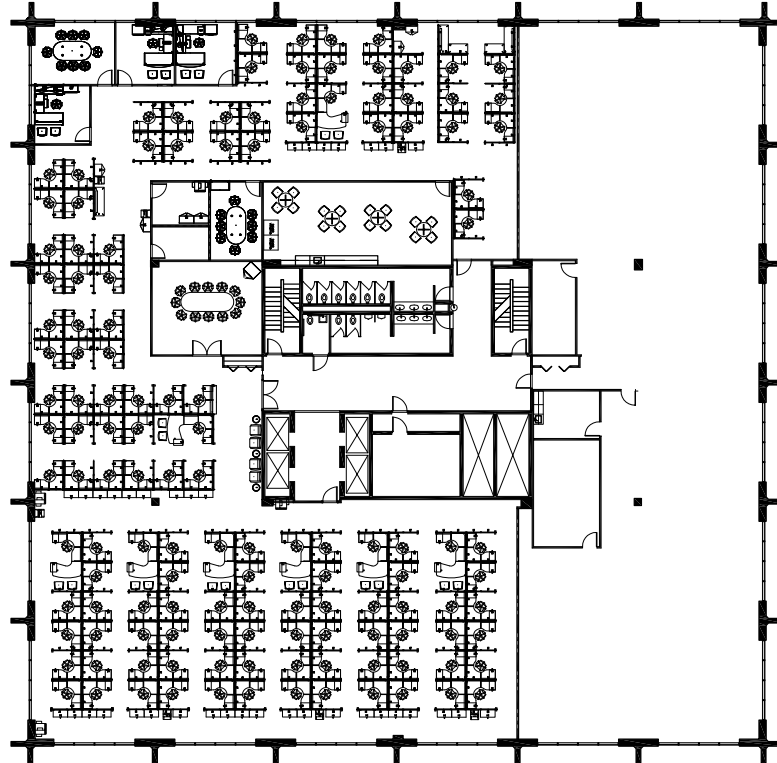

**FOR MORE
INFORMATION
PLEASE
CONTACT**

Ryan Link

Associate
T 720.528.6303
ryan.link@cbre.com

John Marold

Senior Vice President
T 720.528.6355
john.marold@cbre.com

CBRE, Inc. | 8390 E. Crescent Parkway | Suite 300 | Greenwood Village, CO 80111 | www.cbre.com/denver

© 2015 CBRE, Inc. This information has been obtained from sources believed reliable. We have not verified it and make no guarantee, warranty or representation about it. Any projections, opinions, assumptions or estimates used are for example only and do not represent the current or future performance of the property. You and your advisors should conduct a careful, independent investigation of the property to determine to your satisfaction the suitability of the property for your needs. Photos herein are the property of their respective owners and use of these images without the express written content of the owner is prohibited.

