

FOR LEASE

OFFICE SPACE

2,304 SF/2,100 SF/800 SF

1781 HIGHLAND AVENUE

Cheshire, CT



PROPERTY HIGHLIGHTS

CBRE is pleased to offer approximately 2,304 SF, the 2,100 SF and 800 SF units can be combined available for lease on the second floor at 1781 Highland Avenue in Cheshire. Currently the building is occupied by other complimentary office and medical groups including: Hartford Healthcare, Oppenheimer, Hobson Associates, Wonneberger Business Solutions, Connecticut Dermatology, Affinity Health Care Management, Future Benefits, The Dodd Law Firm, and Lighttower.

1781 Highland Avenue is located at Exit 3 off Interstate 691 on the corner of Route 10 and West Johnson Avenue. The property is within close proximity to Interstates 84 and 91, and Route 15 within Central Connecticut.

- + Located on the second floor 2,304 SF, 2,100 SF & 800 SF is built-out including private offices, open area, kitchen and conference room
- + \$20.00/SF full service gross

www.cbre.us/hartford

CBRE

2,304 SF/2,100 SF/800 SF
OFFICE SPACE

FOR LEASE
1781 HIGHLAND AVENUE
Cheshire, CT



FLOOR PLAN

2,304 SF/2,100 SF/800 SF - SECOND FLOOR

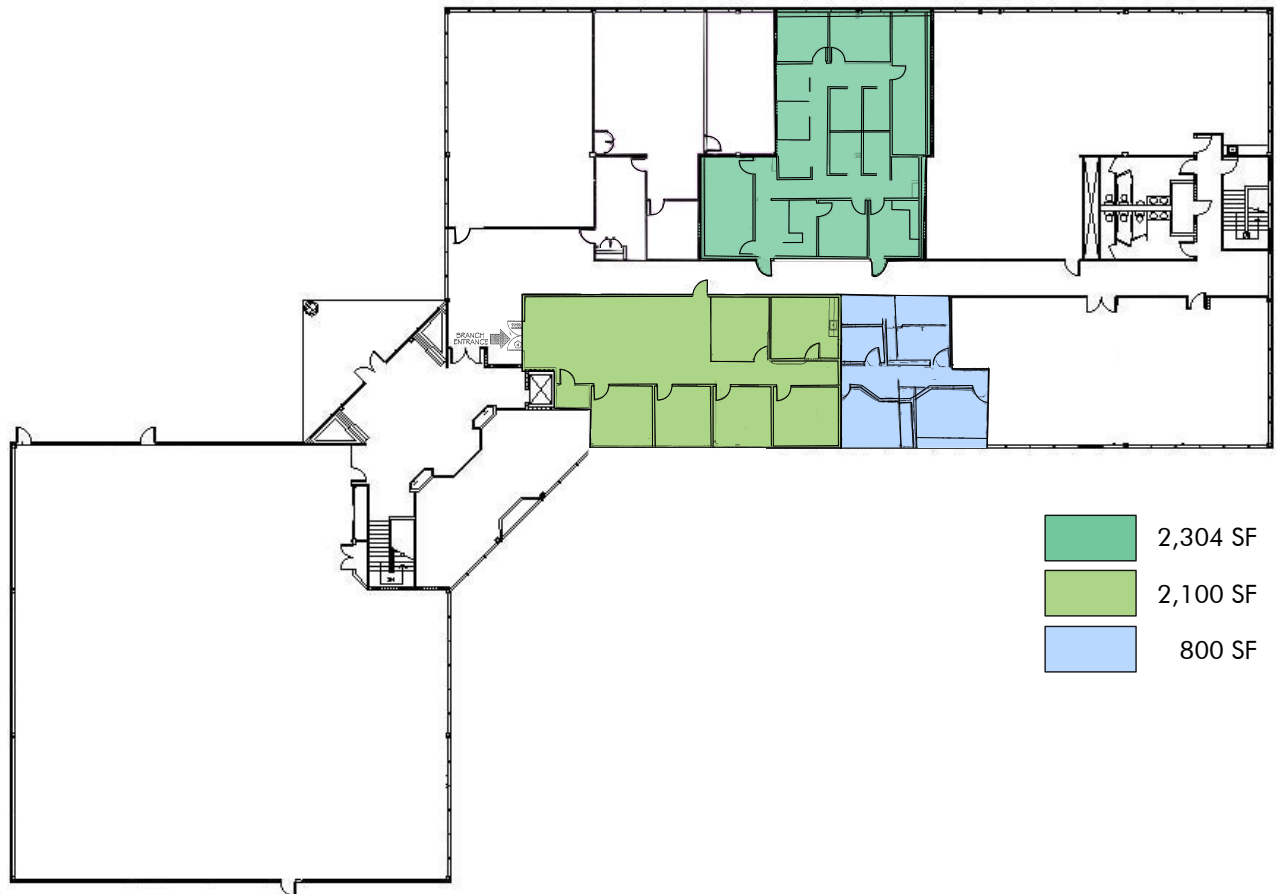

2,304 SF/2,100 SF/800 SF
OFFICE SPACE

FOR LEASE
1781 HIGHLAND AVENUE
Cheshire, CT

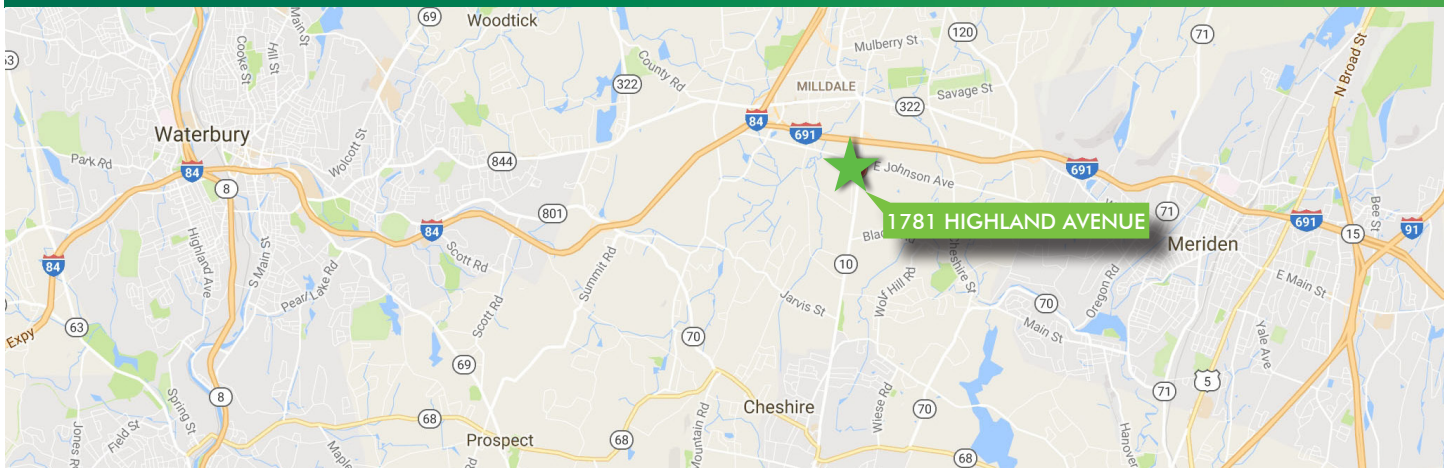

INTERIOR PHOTOS

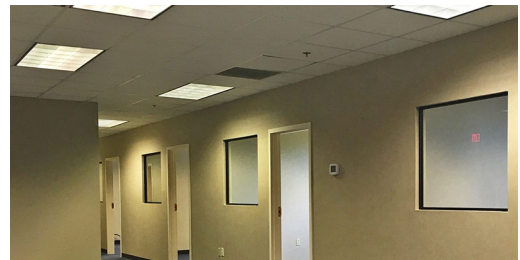

CONTACT US

JENNIFER GOSSELIN

Vice President
+1 860 987 4734
jennifer.gosselin@cbre.com

DAVID BARNES

Senior Vice President
+1 860 987 4782
david.barnes@cbre.com

© 2020 CBRE, Inc. This information has been obtained from sources believed reliable. We have not verified it and make no guarantee, warranty or representation about it. Any projections, opinions, assumptions or estimates used are for example only and do not represent the current or future performance of the property. You and your advisors should conduct a careful, independent investigation of the property to determine to your satisfaction the suitability of the property for your needs. Photos herein are the property of their respective owners and use of these images without the express written consent of the owner is prohibited.