

For Lease

35 Waterview Boulevard Parsippany, NJ

- Office suites from 2,313 SF to 12,090 SF available for lease
- New Conference Center
- Newly renovated on-site cafeteria with corporate catering
- Restrooms newly renovated
- On-site owner representation/property management
- Corporate campus setting
- Exceptional access to I-287, I-80, and Routes 10, 46 & 202
- Amenity rich location
 - Situated on the Route 46 corridor surrounded by an abundance of restaurants, banks, retail stores, hotels and daycare facilities.
 - Adjacent to Waterview Marketplace, featuring Whole Foods, HomeSense, Shake Shack and other new restaurants and retailers.

Lobby Renovations Complete

For more information or to
arrange tour, please contact:

Susan Mason
+1 973 829 4697
susan.mason@am.jll.com

Property Website:
<https://www.35waterviewblvd.com>



Lobby Renovations



On-Site Amenities



Floor plans

First Floor

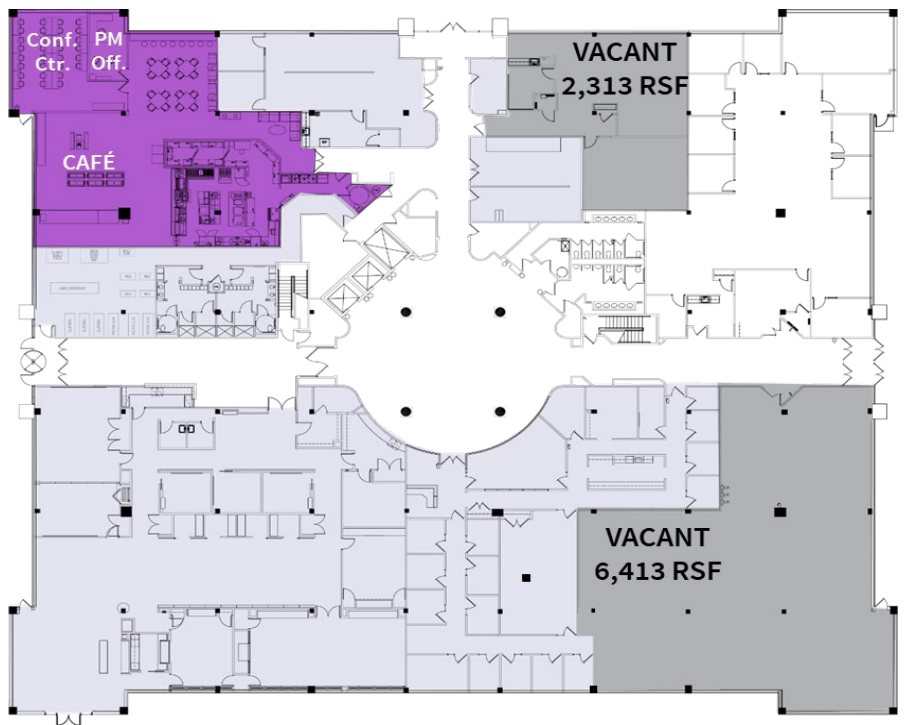

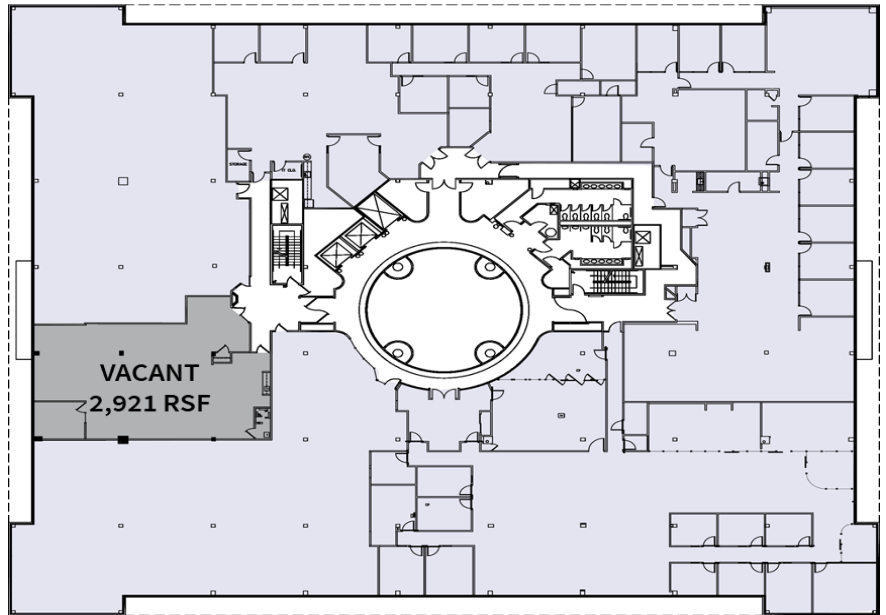

Second Floor

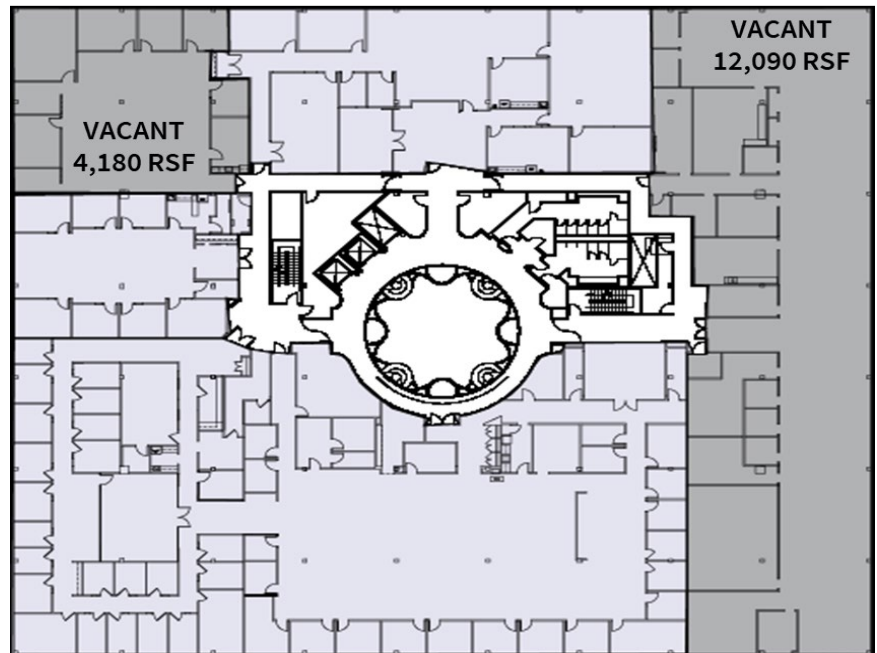

Third Floor



Key:

-  Vacant
-  Occupied
-  Amenity

Local Amenities

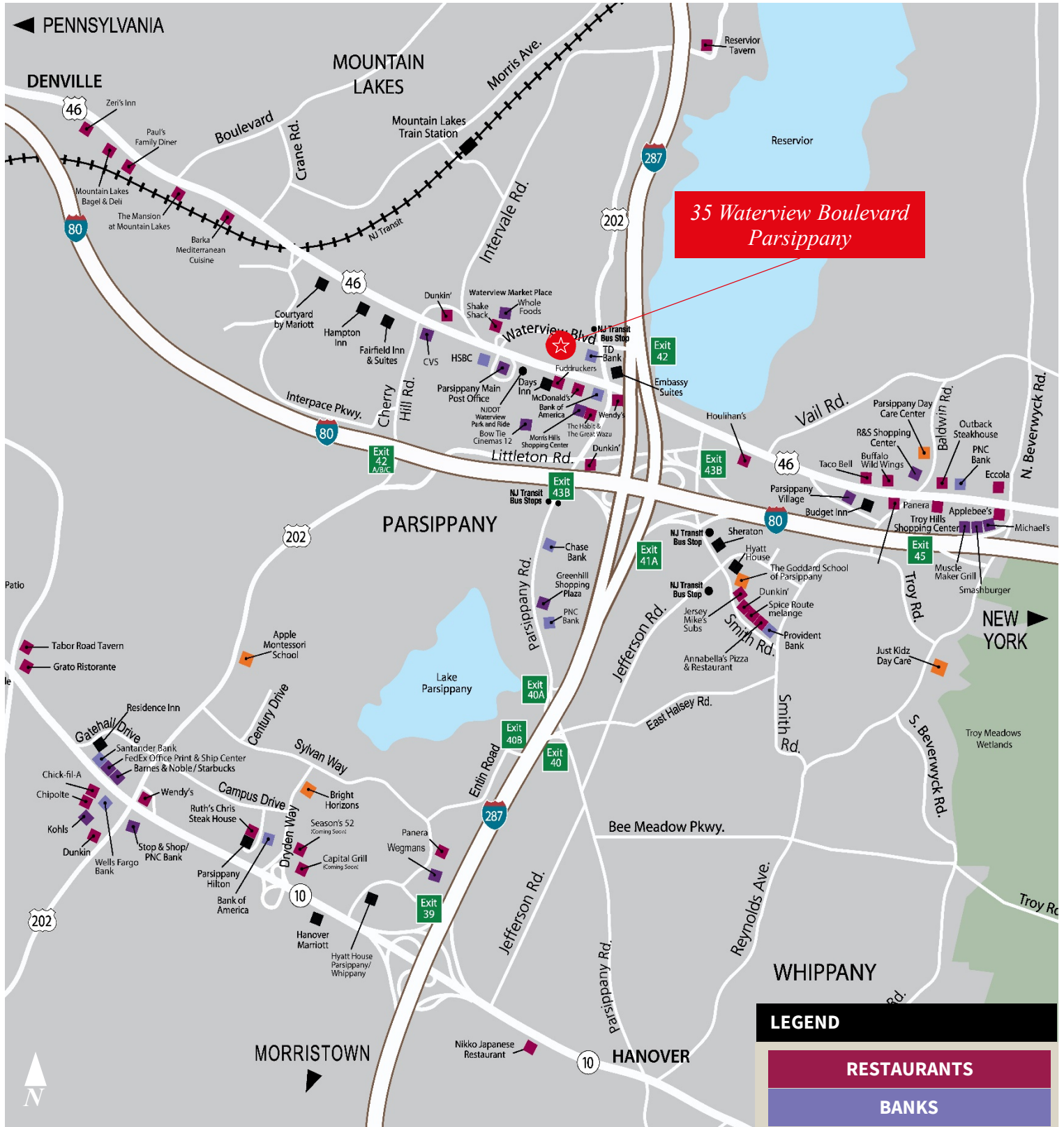

LEGEND

- RESTAURANTS
- BANKS
- RETAIL
- DAYCARE
- HOTELS

Aerial and Location Map

