

Harbor Place

Haverhill Waterfront: Live, Work, Play



Call for an appointment:
Tom Caldarone 978.397.4227
John Amaral 978.835.0629

Omni Properties, LLC
6 Liberty Way, Suite 203, Westford, MA
www.omniproperties.com
978.369.4884

Disclaimer: The Evaluation Material contains information provided by the Owner and obtained by the Broker. While the information is believed to be accurate, Receiving Party should independently evaluate its completeness and accuracy before making an offer. This Evaluation Material is subject to prior placement, errors, omissions, changes or withdrawal without notice and does not constitute a recommendation, endorsement or advice as to the value of the Property by Disclosing Party.

Harbor Place

Live



Cutting edge community on the boardwalk of the Merrimack River. Spectacular ambiance is captured in these mid rise apartment homes. 80 Units 100% occupied.



The Commons



Kitchen and Dining



Living Space

Work



Premier mid-sized public research university. This Haverhill School offers curriculum for full Bachelors, Masters, and Doctoral Degrees.



Pentucket has created its headquarters at Harbor Place, growing to 6 locations and boasting an A+ Bank rating.



Premiere service based independent insurance agency dedicated to providing clients with 30 years of superior service. "Trusted choice" Independent insurance Agency Award 10 years in a row!

"Our beautiful river view offices at Harbor Place inspire both the MTM Team and our valued clients."
-Laurie Mancinelli, Managing Member

Play



Build your own tacos', plus cocktails, in a hip and casual atmosphere. Harbor Place is the most recent Barrio location.



Fitness center where mind and muscle are united. Family managed and committed to EACH members success. The COMPOUND Effect!



Harbor Place



Retail Floor Plans

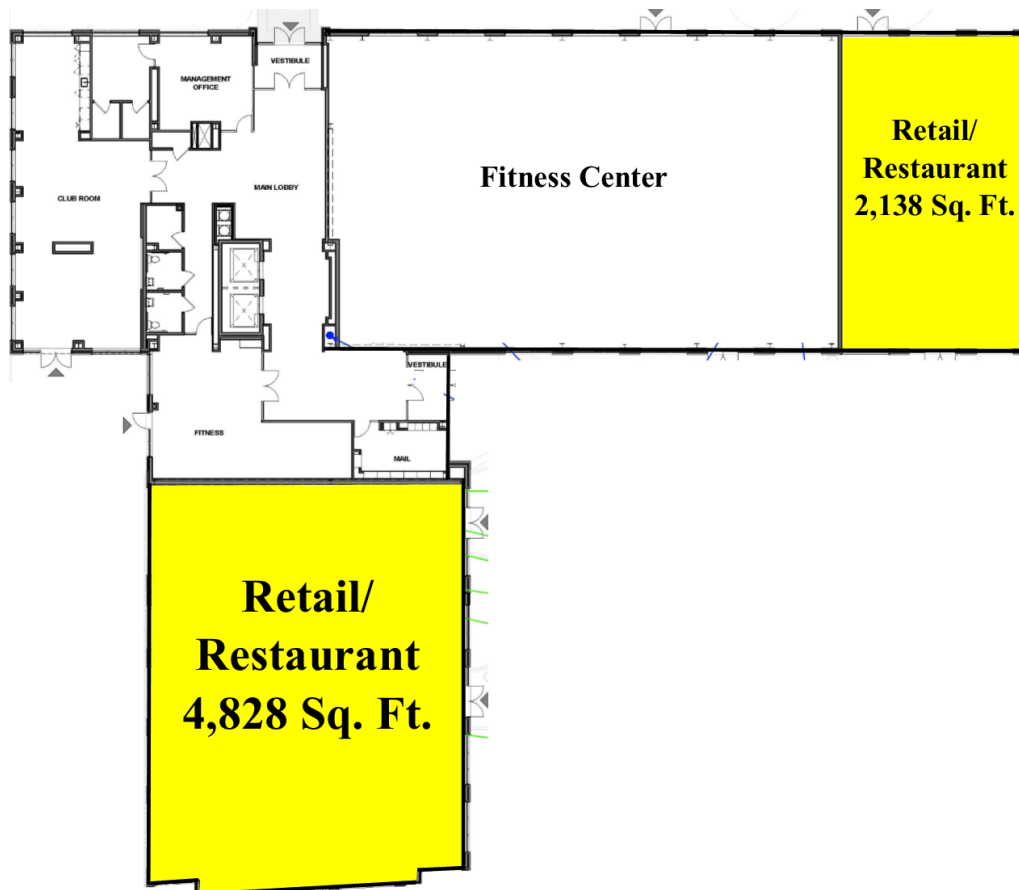

Office Floor Plans Top Floor

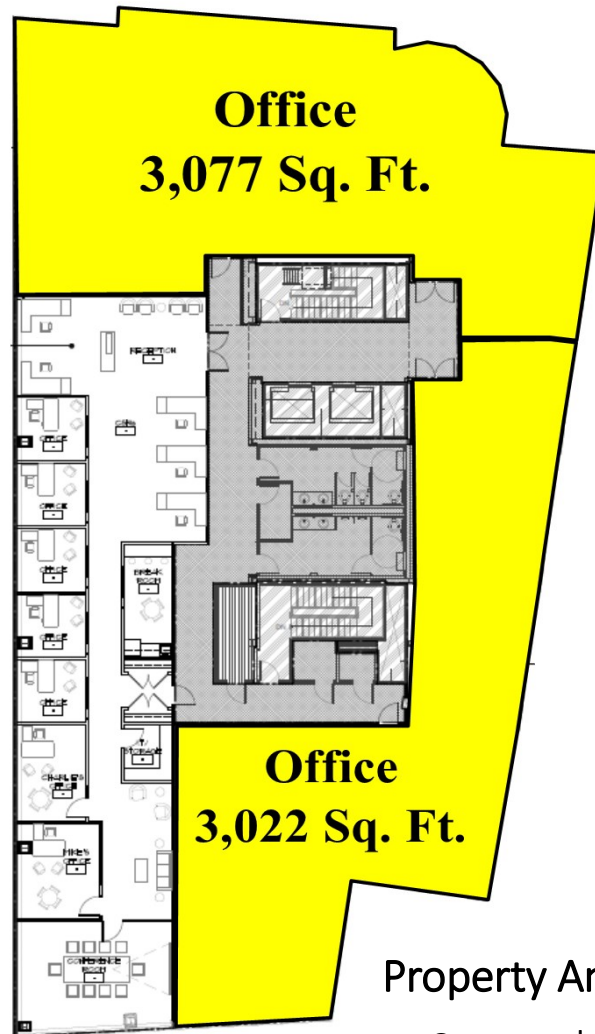

Property Amenities:

- Secured Underground Parking Available
- Adjacent Public Parking
- Al Fresco Dining
- Panoramic River Frontage
- Direct Access to Boardwalk
- Water Sewer and Gas
- Grease Traps, Ducts , and Exhaust Shafts Installed
- Elevator/Handicap Accessibility