

# RETAIL SUITE FOR LEASE

## SUNROCK CENTER

3054-3068 Sunrise Blvd  
Rancho Cordova, CA 95742  
2,407 SF

**ETHAN CONRAD**  
PROPERTIES INC.



**916.779.1000**

**CHASE BURKE**

Vice President | Retail Properties  
CalDRE #01879336  
chase@ethanconradprop.com

**ANDY JONSSON**

Retail Specialist | Retail Properties  
CalDRE #2076108  
andy@ethanconradprop.com

**ETHAN CONRAD**

CEO  
CalDRE #01298662  
ethan@ethanconradprop.com

**ETHAN CONRAD PROPERTIES**

1300 National Drive, Suite 100 | Sacramento, CA | 916.779.1000  
www.ethanconradprop.com

The information contained herein has been obtained from sources we believe to be reliable. We cannot, however, guarantee, warrant or represent its accuracy and all information is subject to error, change or withdrawal. Any interested party and their advisors should conduct an independent investigation of the property to determine to your satisfaction the suitability of the property for your needs.

## RETAIL PROPERTY FOR LEASE



### PROPERTY DESCRIPTION

Conveniently located on Sunrise Blvd. which is one of Rancho Cordova's busiest thoroughfares and has excellent retail exposure for more than 30k cars per day.

### PROPERTY HIGHLIGHTS

- Traffic Count: 30k per day
- High visibility on Sunrise Blvd
- Monument and building signage available
- Strong traffic counts
- Easy access to Hwy 50
- NNN Rate: \$0.26

### OFFERING SUMMARY

Lease Rate:	\$0.67 - 0.94 SF/month (NNN)
Available SF:	2,407 SF
Building Size:	32,880 SF

DEMOGRAPHICS	1 MILE	3 MILES	5 MILES
Total Households	1,699	21,919	58,863
Total Population	4,227	58,343	152,240
Average HH Income	\$71,933	\$73,275	\$82,376

#### CHASE BURKE

Vice President | Retail Properties  
CalDRE #01879336  
chase@ethanconradprop.com

#### ANDY JONSSON

Retail Specialist | Retail Properties  
CalDRE #2076108  
andy@ethanconradprop.com

#### ETHAN CONRAD

CEO  
CalDRE #01298662  
ethan@ethanconradprop.com

#### ETHAN CONRAD PROPERTIES

1300 National Drive, Suite 100 | Sacramento, CA | 916.779.1000  
www.ethanconradprop.com

The information contained herein has been obtained from sources we believe to be reliable. We cannot, however, guarantee, warrant or represent its accuracy and all information is subject to error, change or withdrawal. Any interested party and their advisors should conduct an independent investigation of the property to determine to your satisfaction the suitability of the property for your needs.

**RETAIL PROPERTY FOR LEASE**

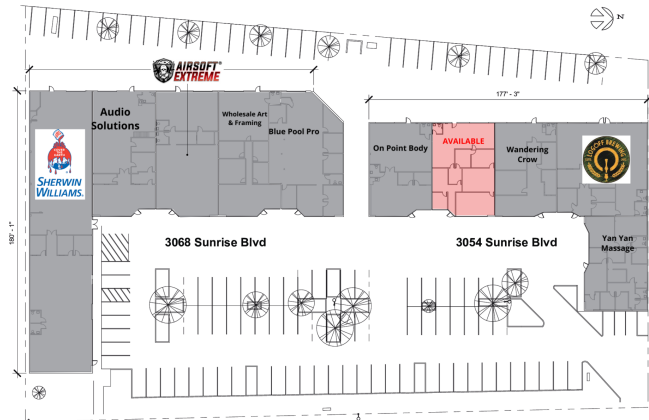

UNAVAILABLE  AVAILABLE

LEASE TYPE NNN | TOTAL SPACE 2,407 SF | LEASE TERM NEGOTIABLE | LEASE RATE \$0.67 - \$0.94 SF/MONTH

SUITE	TENANT	SIZE	TYPE	RATE	DESCRIPTION
3054-H	Available	2,407 SF	NNN	\$0.67 - \$0.94 SF/month	Office/Showroom: 1,557 SF (\$0.94 PSF), Warehouse: 850 SF (\$0.67 PSF)

**CHASE BURKE**  
Vice President | Retail Properties  
CalDRE #01879336  
chase@ethanconradprop.com

**ANDY JONSSON**  
Retail Specialist | Retail Properties  
CalDRE #2076108  
andy@ethanconradprop.com

**ETHAN CONRAD**  
CEO  
CalDRE #01298662  
ethan@ethanconradprop.com

**ETHAN CONRAD PROPERTIES**  
1300 National Drive, Suite 100 | Sacramento, CA | 916.779.1000  
www.ethanconradprop.com

The information contained herein has been obtained from sources we believe to be reliable. We cannot, however, guarantee, warrant or represent its accuracy and all information is subject to error, change or withdrawal. Any interested party and their advisors should conduct an independent investigation of the property to determine to your satisfaction the suitability of the property for your needs.

**RETAIL PROPERTY FOR LEASE**

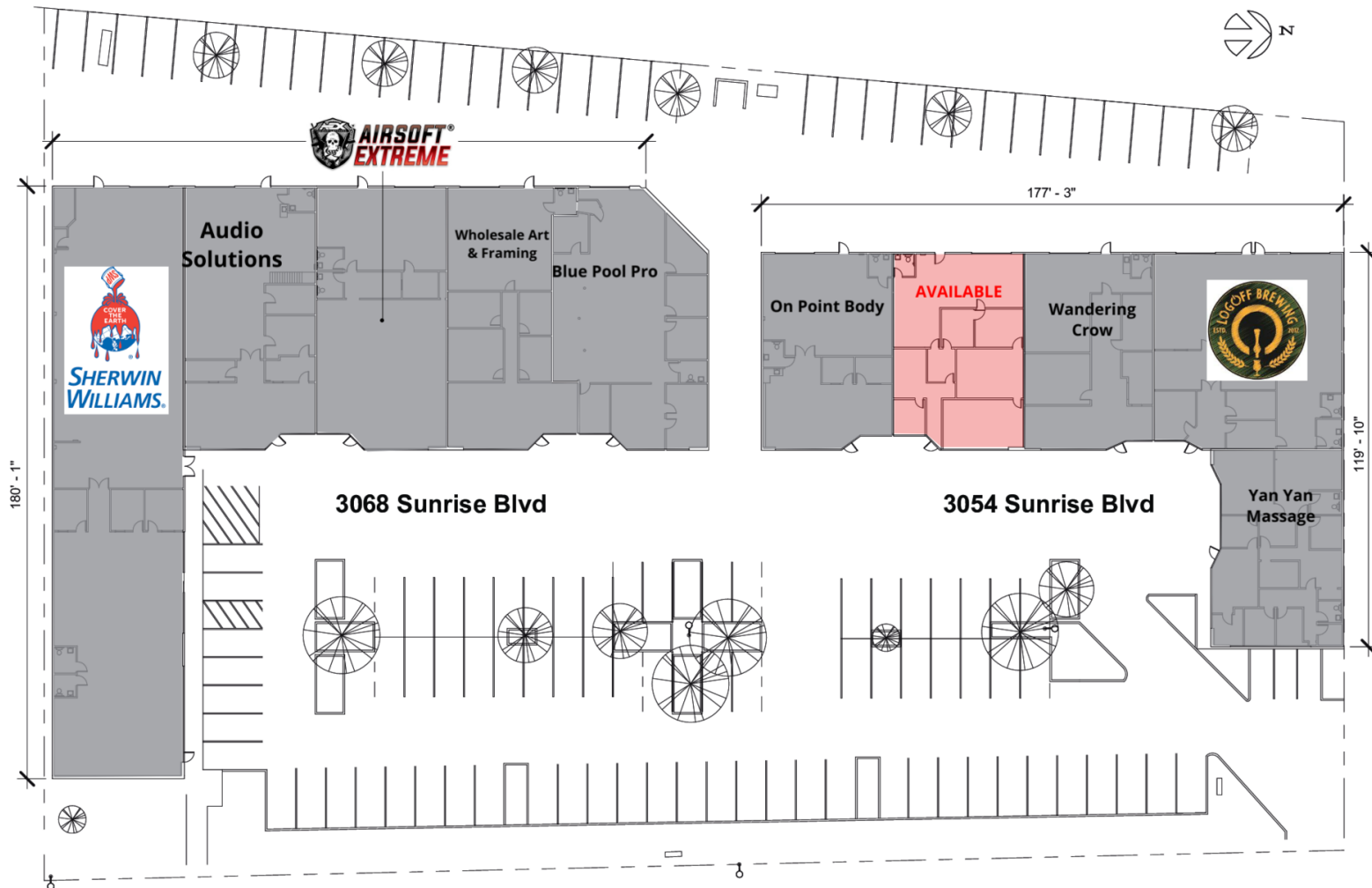

**CHASE BURKE**  
Vice President | Retail Properties  
CalDRE #01879336  
chase@ethanconradprop.com

**ANDY JONSSON**  
Retail Specialist | Retail Properties  
CalDRE #2076108  
andy@ethanconradprop.com

**ETHAN CONRAD**  
CEO  
CalDRE #01298662  
ethan@ethanconradprop.com

**ETHAN CONRAD PROPERTIES**  
1300 National Drive, Suite 100 | Sacramento, CA | 916.779.1000  
www.ethanconradprop.com

The information contained herein has been obtained from sources we believe to be reliable. We cannot, however, guarantee, warrant or represent its accuracy and all information is subject to error, change or withdrawal. Any interested party and their advisors should conduct an independent investigation of the property to determine to your satisfaction the suitability of the property for your needs.

**RETAIL PROPERTY FOR LEASE**

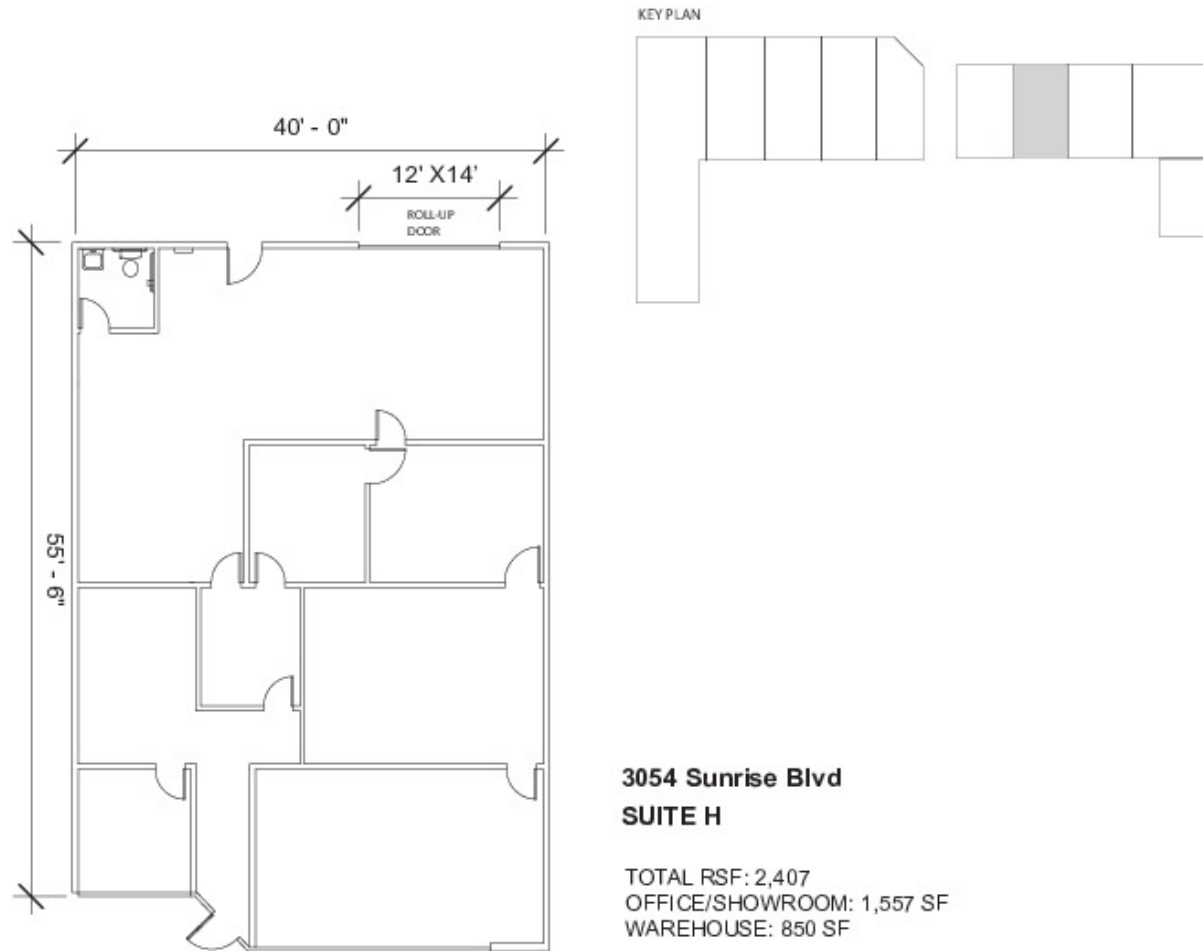

**CHASE BURKE**

Vice President | Retail Properties  
CalDRE #01879336  
chase@ethanconradprop.com

**ANDY JONSSON**

Retail Specialist | Retail Properties  
CalDRE #2076108  
andy@ethanconradprop.com

**ETHAN CONRAD**

CEO  
CalDRE #01298662  
ethan@ethanconradprop.com

**ETHAN CONRAD PROPERTIES**

1300 National Drive, Suite 100 | Sacramento, CA | 916.779.1000  
www.ethanconradprop.com

**RETAIL PROPERTY FOR LEASE**



**CHASE BURKE**  
Vice President | Retail Properties  
CalDRE #01879336  
chase@ethanconradprop.com

**ANDY JONSSON**  
Retail Specialist | Retail Properties  
CalDRE #2076108  
andy@ethanconradprop.com

**ETHAN CONRAD**  
CEO  
CalDRE #01298662  
ethan@ethanconradprop.com

**ETHAN CONRAD PROPERTIES**  
1300 National Drive, Suite 100 | Sacramento, CA | 916.779.1000  
www.ethanconradprop.com

The information contained herein has been obtained from sources we believe to be reliable. We cannot, however, guarantee, warrant or represent its accuracy and all information is subject to error, change or withdrawal. Any interested party and their advisors should conduct an independent investigation of the property to determine to your satisfaction the suitability of the property for your needs.

**RETAIL PROPERTY FOR LEASE**



**CHASE BURKE**  
Vice President | Retail Properties  
CalDRE #01879336  
chase@ethanconradprop.com

**ANDY JONSSON**  
Retail Specialist | Retail Properties  
CalDRE #2076108  
andy@ethanconradprop.com

**ETHAN CONRAD**  
CEO  
CalDRE #01298662  
ethan@ethanconradprop.com

**ETHAN CONRAD PROPERTIES**  
1300 National Drive, Suite 100 | Sacramento, CA | 916.779.1000  
www.ethanconradprop.com

The information contained herein has been obtained from sources we believe to be reliable. We cannot, however, guarantee, warrant or represent its accuracy and all information is subject to error, change or withdrawal. Any interested party and their advisors should conduct an independent investigation of the property to determine to your satisfaction the suitability of the property for your needs.