

# Kai Nani Village Kihei Restaurant

## 2511 South Kihei Road

### FOR LEASE

Unit A: 2,376 Sq.Ft.  
Base Rent: \$2.50 psf  
Percentage Rent: 7%  
Net Operating Exp: \$1.42 psf

Grease trap & vent hood in place  
Walk-in refrigerator/freezer  
Private Restrooms  
Street visibility on South Kihei Road  
Great foot traffic



**Exclusively Offered By:**

**Scott Kenar, R(S)**

808.250.2291  
[skenar@mauibiz.com](mailto:skenar@mauibiz.com)

**Grant E. Howe, CCCM R(B)**

808.250.4864  
[ghowe@mauibiz.com](mailto:ghowe@mauibiz.com)



COMMERCIAL PROPERTIES  
OF MAUI

444 Hana Highway  
Suite C  
Kahului, HI 96732-2315  
[mauibiz.com](http://mauibiz.com)  
808.244.2200

# Kai Nani Village Kihei Restaurant Site Plan

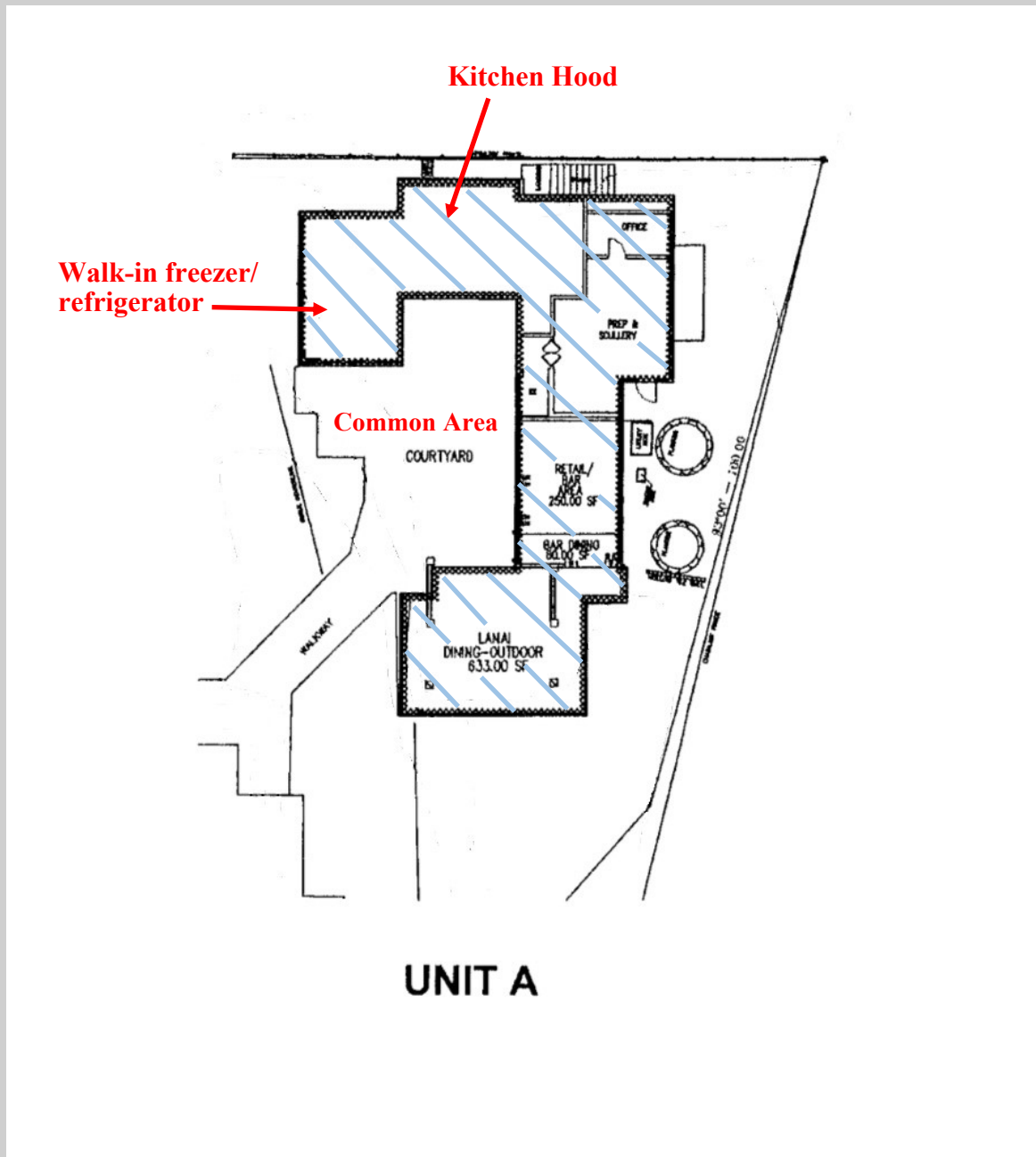

**Exclusively Offered By:**

**Scott Kenar, R(S)**

808.250.2291  
[skenar@mauibiz.com](mailto:skenar@mauibiz.com)

**Grant E. Howe, CCCM R(B)**

808.250.4864  
[ghowe@mauibiz.com](mailto:ghowe@mauibiz.com)



COMMERCIAL PROPERTIES  
OF MAUI

444 Hana Highway  
Suite C  
Kahului, HI 96732-2315  
[mauibiz.com](http://mauibiz.com)

808.244.2200



# Kai Nani Village Kihei Restaurant

## 2511 South Kihei Road



***Exclusively Offered By:***

**Scott Kenar, R(S)**

808.250.2291  
[skenar@mauibiz.com](mailto:skenar@mauibiz.com)

**Grant E. Howe, CCM R(B)**

808.250.4864  
[ghowe@mauibiz.com](mailto:ghowe@mauibiz.com)



COMMERCIAL PROPERTIES  
OF MAUI

444 Hana Highway  
Suite C  
Kahului, HI 96732-2315  
[mauibiz.com](http://mauibiz.com)

808.244.2200