

# PRIME RETAIL SPACE ADJACENT TO KOHL'S

Kernersville, NC 27284 | 224 Harmon Creek Rd | S Main St & Harmon Creek Rd | #432



- 59,000 AADT on Business I-40 interchange
- Located between Lowes Hardware and Wal-Mart
- Other retailers in sub-market include Target, Lowes Foods, Planet Fitness, Harris Teeter, Panera Bread, Starbucks, Chipotle, and others

DEMOGRAPHICS	1 MILE	3 MILES	5 MILES	TRAFFIC COUNTS	
2018 Population Density	4,961	36,784	68,838	S Main Street	26,000 AADT
2018 Daytime Population	3,674	18,040	23,420		
2018 Average HH Income	\$79,131	\$74,866	\$75,212		
2018 Median HH Income	\$56,623	\$57,259	\$58,378		

AVAILABLE SF:  
24,553 SF

FRONTAGE:  
APPROX 98'8"

ZONING:  
COMMERCIAL

RATES:  
CALL FOR DETAILS

## AREA ANCHORS



### FOR MORE INFORMATION, CONTACT EXCLUSIVE AGENT(S):

JEFF NIMMER, CCIM • jeff.nimmer@tscg.com • 919.380.8041

TYLER QUINN • tyler.quinn@tscg.com • 919.380.8041

TAYLOR DROUILLARD • taylor.drouillard@tscg.com • 919.380.8041

Demographics: Esri 2018 No warranty expressed or implied has been made as to the accuracy of the information provided herein, no liability assumed for error or omissions.



# PRIME RETAIL SPACE ADJACENT TO KOHL'S

Kernersville, NC 27284 | 224 Harmon Creek Rd | S Main St & Harmon Creek Rd | #432



FOR MORE INFORMATION, CONTACT EXCLUSIVE AGENT(S):

JEFF NIMMER, CCIM • jeff.nimmer@tscg.com • 919.380.8041

TYLER QUINN • tyler.quinn@tscg.com • 919.380.8041

TAYLOR DROUILLARD • taylor.drouillard@tscg.com • 919.380.8041



Demographics: Esri 2018 No warranty expressed or implied has been made as to the accuracy of the information provided herein, no liability assumed for error or omissions.

# PRIME RETAIL SPACE ADJACENT TO KOHL'S

Kernersville, NC 27284 | 224 Harmon Creek Rd | S Main St & Harmon Creek Rd | #432



FOR MORE INFORMATION, CONTACT EXCLUSIVE AGENT(S):

JEFF NIMMER, CCIM • [jeff.nimmer@tscg.com](mailto:jeff.nimmer@tscg.com) • 919.380.8041

TYLER QUINN • [tyler.quinn@tscg.com](mailto:tyler.quinn@tscg.com) • 919.380.8041

TAYLOR DROUILLARD • [taylor.drouillard@tscg.com](mailto:taylor.drouillard@tscg.com) • 919.380.8041

Demographics: Esri 2018 No warranty expressed or implied has been made as to the accuracy of the information provided herein, no liability assumed for error or omissions.

TSCG

Stan Johnson Co.  
THE NET LEASE AUTHORITY®

CHAINLINKS  
RETAIL ADVISORS

# PRIME RETAIL SPACE ADJACENT TO KOHL'S

Kernersville, NC 27284 | 224 Harmon Creek Rd | S Main St & Harmon Creek Rd | #432

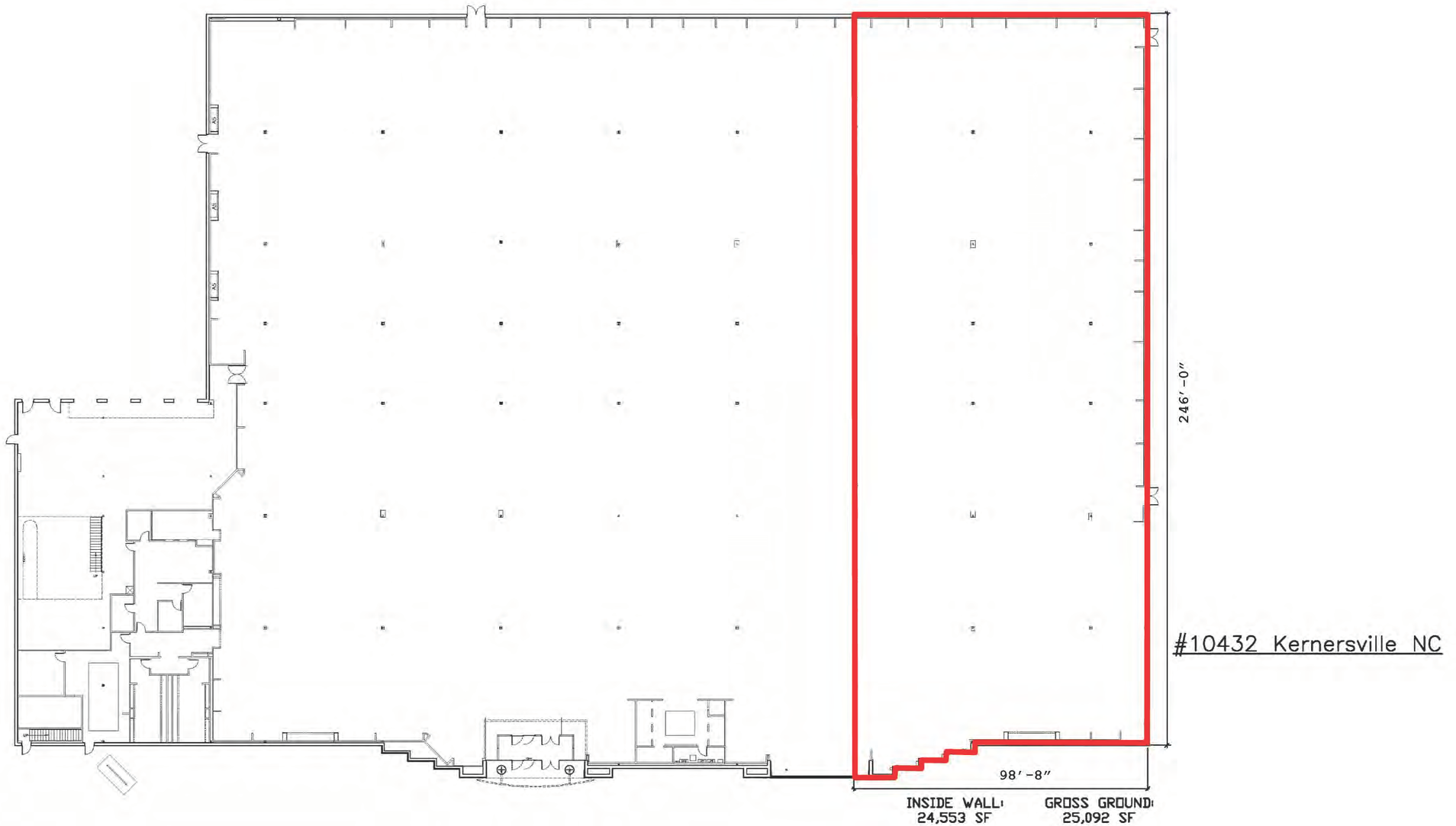

FOR MORE INFORMATION, CONTACT EXCLUSIVE AGENT(S):

JEFF NIMMER, CCIM • [jeff.nimmer@tscg.com](mailto:jeff.nimmer@tscg.com) • 919.380.8041

TYLER QUINN • [tyler.quinn@tscg.com](mailto:tyler.quinn@tscg.com) • 919.380.8041

TAYLOR DROUILLARD • [taylor.drouillard@tscg.com](mailto:taylor.drouillard@tscg.com) • 919.380.8041

Demographics: Esri 2018 No warranty expressed or implied has been made as to the accuracy of the information provided herein, no liability assumed for error or omissions.

