

Easily Accessible Suites

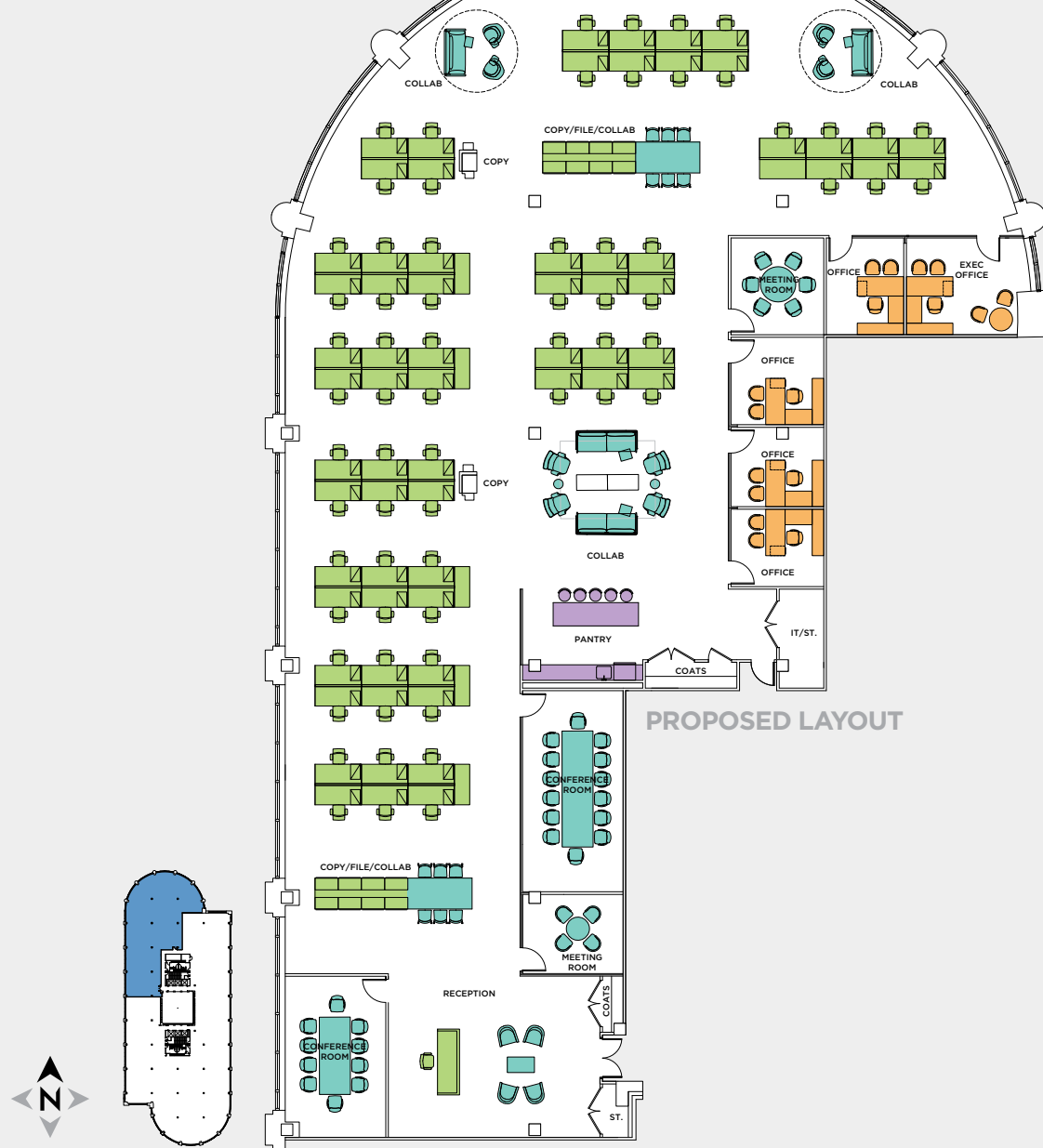

Artist's Rendering



Click Here for a Tour!

SUITE 460 — 13,435 SQ.FT.

5 offices, 4 conference/meeting rooms, 68 workstations

Northern views of Downtown Stamford on curvature of building

Extensive window line with abundance of natural light

Direct entrance off elevator

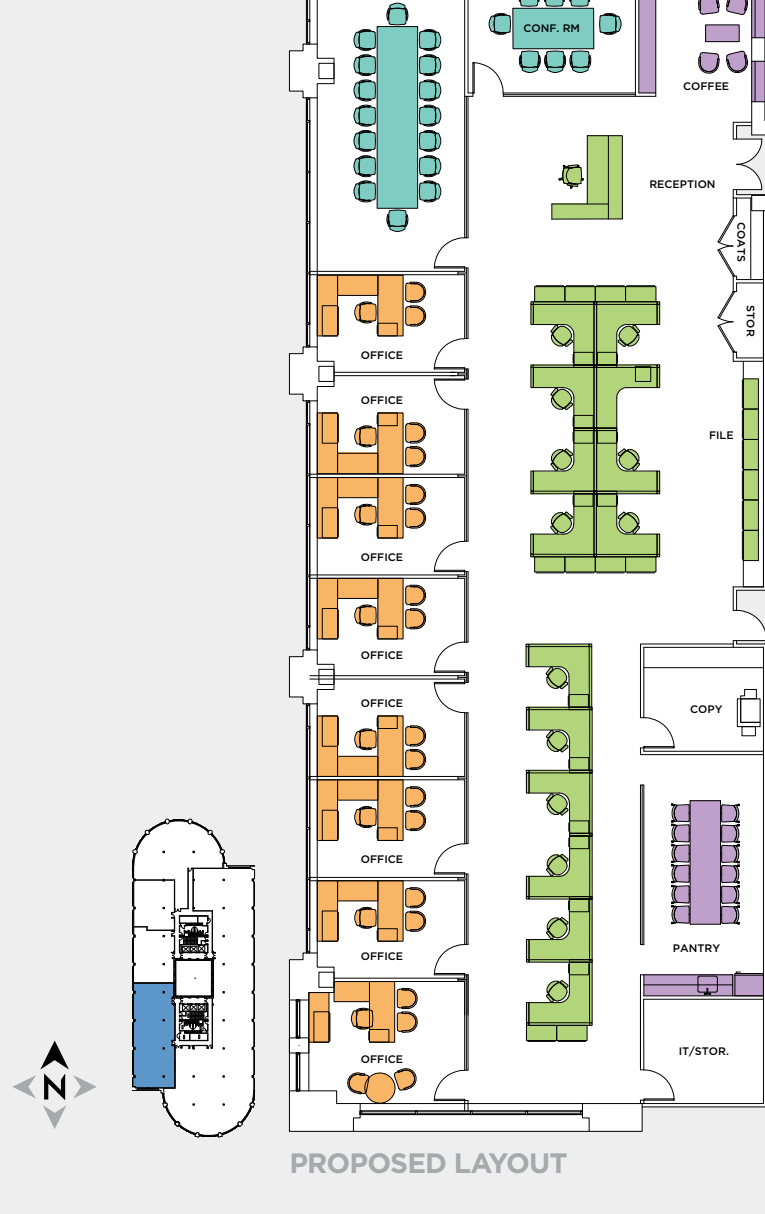

Click Here for a Tour!

SUITE 503 — 6,988 SQ.FT.

8 offices, 2 conference rooms, 14 workstations

Efficient corner suite

Views of Harbor Point with abundance of natural light

Direct entrance off elevator

Contact us to learn more

BE SMART • BE SAFE

Tenant Services & Safety

ESRT Turnkey Suites:

- Fully furnished • IT wiring and support
- Move coordination • Full floors to smaller suites
- High performance air filtration
- Deep cleaning & disinfectant services

Property Health & Wellness

- Temperature scan for your employees' health and safety
- Frequent cleaning of high touch points
- Outdoor green spaces

Healthy and safe food choices:

- Outdoor dining • Food delivery • Grab-and-go service

Choose your commute:

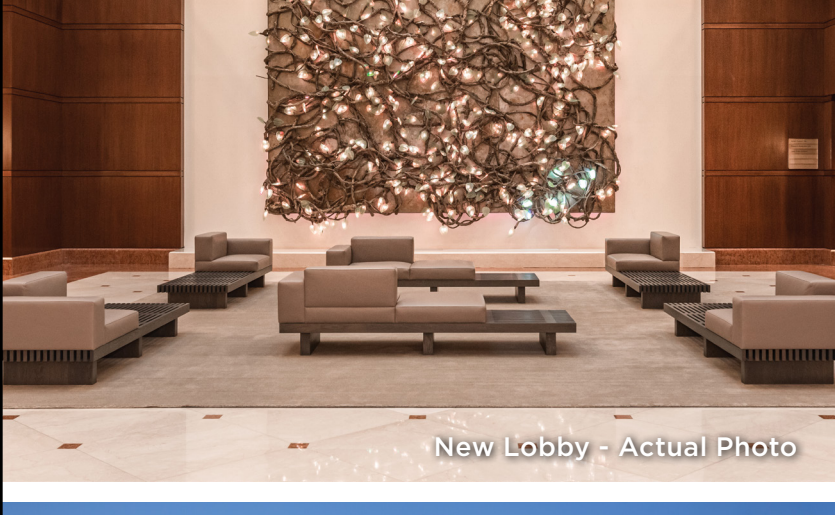

New Lobby - Actual Photo



New Fitness Center - Actual Photo



New Café - Actual Photo

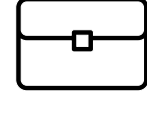

Tenants include Columbus Circle Investors, Olympus Growth Fund VI, Tweedy, Browne Company, Jefferies Group and Zimmer Biomet



Located at the Stamford, CT Transportation Center

Thank you for the opportunity to compete for your business.

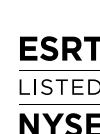

Jeffrey H. Newman 203-353-5200 • jnewman@empirestaterealtytrust.com
Kimberly A. Zaccagnino 203-353-5241 • kzaccagnino@empirestaterealtytrust.com
Kristin Dermer 203-353-5234 • kdermer@empirestaterealtytrust.com



James Ritman 203-531-3606 • jritman@ngkf.com
Greg Frisoli 203-531-3605 • gfrisoli@ngkf.com
Torey Walsh 203-531-3633 • twalsh@ngkf.com
Janey Steinmetz 203-531-3603 • janey.steinmetz@ngkf.com
Benjamin Goldstein 203-705-3295 • ben.goldstein@ngkf.com

