

29,304 SF

Industrial Space For Lease



Prologis Park SeaTac, Bldg F

18850 8th Avenue South, Suite 800
SeaTac, WA 98148 USA

LOCATION

- Located in Prologis Park SeaTac
- Located within 5 minutes of cargo entrance to SeaTac International Airport

FACILITY

- 29,304 square feet (6,117 SF 1st floor office & 5,621 SF mezzanine)
- 12 dock high loading doors (4 dock levelers)
- 2 grade level doors
- 24' clear height
- Concrete apron, dock canopy, dock levelers
- Excellent truck maneuvering
- 170'6" truck court depth
- 48'w x 49'6" d column spacing
- Ample parking
- Available April 1, 2018

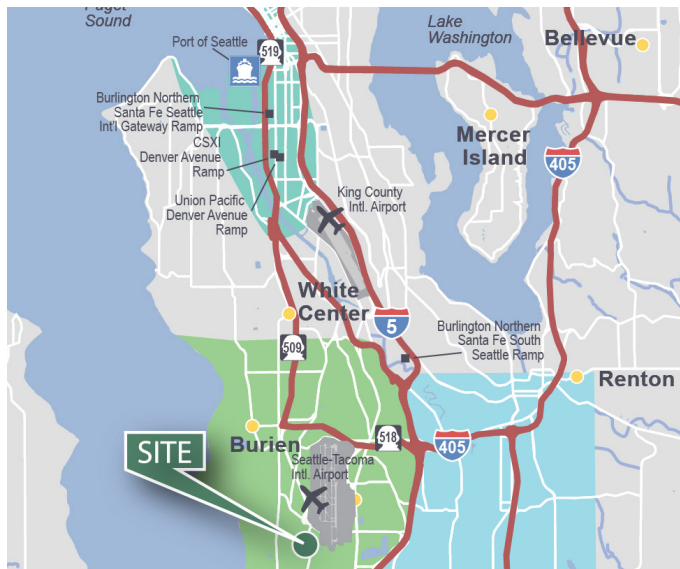

29,304 SF

Industrial Space For Lease

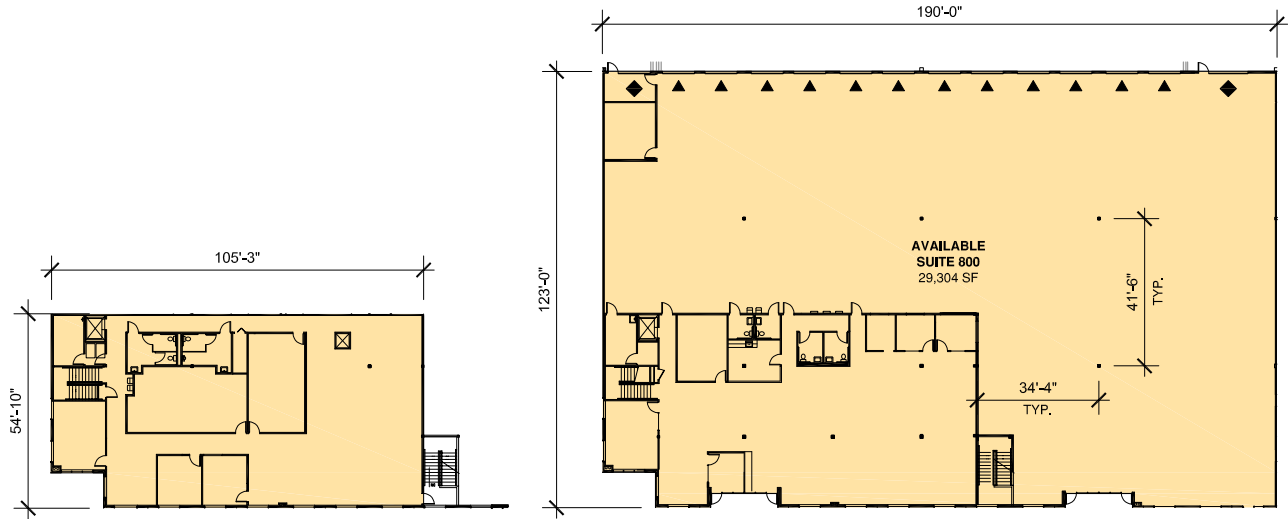

MEZZANINE
3' 12' 30'
0 6' 18'

SUITE 800
3' 12' 30'
0 6' 18'

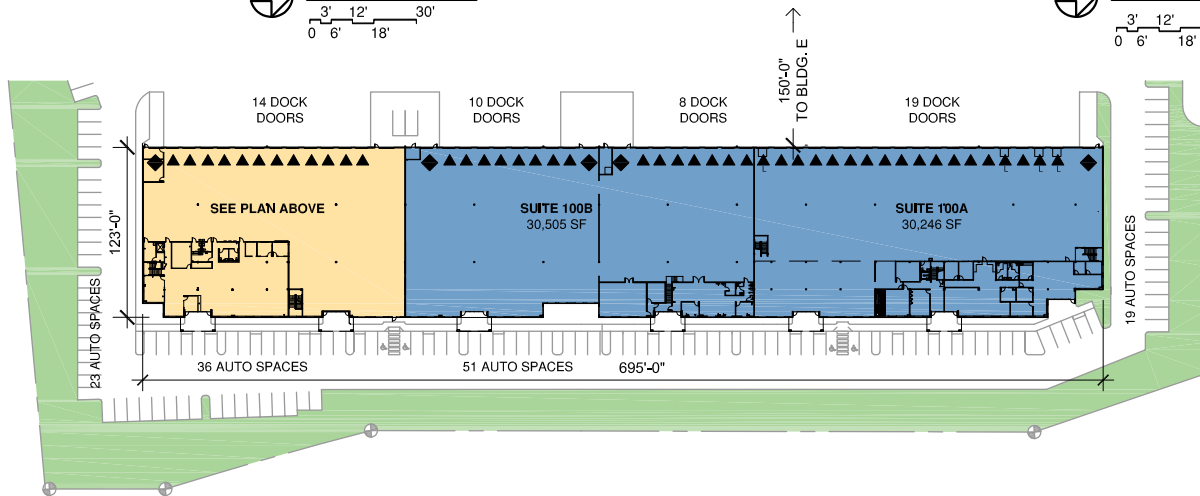

SITE PLAN
NOT TO SCALE



NAI Puget Sound Properties

Arie Salomon, SIOR, CCIM
asalomon@nai-psp.com
ph +1 425.586.5636
fax +1 425.455.9138
600 108th Avenue NE, Suite 340
Bellevue, WA 98004 USA

NAI Puget Sound Properties

Connor Powell
cpowell@nai-psp.com
ph +1 425.586.5642
fax +1 425.455.9138
600 108th Avenue NE, Suite 340
Bellevue, WA 98004 USA

Prologis

Rick Kolpa
rkolpa@prologis.com
ph +1 206.414.7610
fax +1 206.424.7601
12720 Gateway Drive, Suite 110
Tukwila, WA 98168 USA