



WOODLAND

B U S I N E S S P A R K

INDUSTRIAL SPACE AVAILABLE FOR LEASE - 11,520 SF

3800-C Woodpark Boulevard | Charlotte, North Carolina 28206



Christopher Skibinski, SIOR
Principal | Managing Director
704.412.5606
chris.skibinski@avisonyoung.com

Henry Lobb
Senior Vice President
704.469.5964
henry.lobb@avisonyoung.com

Chris Loyd
Vice President
704.612.0238
chris.loyd@avisonyoung.com

Trent King
Associate
704.612.0812
trent.king@avisonyoung.com

**AVISON
YOUNG**



Overview

The Woodland Business Park is comprised of twelve buildings totaling 944,403 sf. The park consists of light industrial, flex and distribution space, making it an appealing option for various types of tenants.

Located within close proximity to the I-85/I-77 interchange, the Park offers quick and convenient access to highly efficient interstate systems.





WOODLAND

BUSINESS PARK

INDUSTRIAL SPACE AVAILABLE FOR LEASE - 11,520 SF

3800-C Woodpark Boulevard | Charlotte, North Carolina 28206

Site Plan



Christopher Skibinski, SIOR
Principal | Managing Director
704.412.5606
chris.skibinski@avisonyoung.com

Henry Lobb
Senior Vice President
704.469.5964
henry.lobb@avisonyoung.com

Chris Loyd
Vice President
704.612.0238
chris.loyd@avisonyoung.com

Trent King
Associate
704.612.0812
trent.king@avisonyoung.com



**AVISON
YOUNG**



WOODLAND

B U S I N E S S P A R K

INDUSTRIAL SPACE AVAILABLE FOR LEASE - 11,520 SF

3800-C Woodpark Boulevard | Charlotte, North Carolina 28206

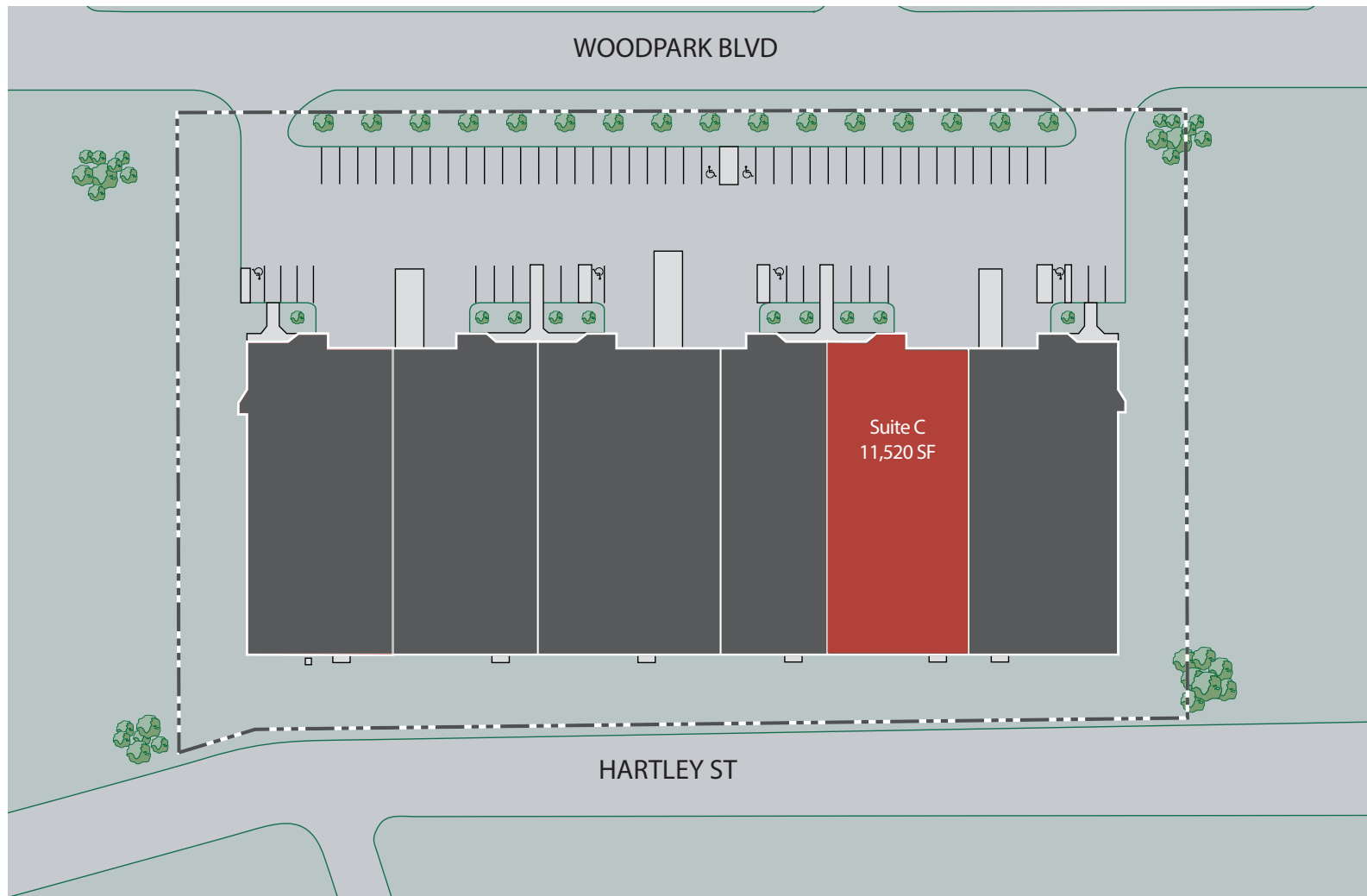

Christopher Skibinski, SIOR
Principal | Managing Director
704.412.5606
chris.skibinski@avisonyoung.com

Henry Lobb
Senior Vice President
704.469.5964
henry.lobb@avisonyoung.com

Chris Loyd
Vice President
704.612.0238
chris.loyd@avisonyoung.com

Trent King
Associate
704.612.0812
trent.king@avisonyoung.com





WOODLAND

BUSINESS PARK

INDUSTRIAL SPACE AVAILABLE FOR LEASE - 11,520 SF

3800-C Woodpark Boulevard | Charlotte, North Carolina 28206

3800-C WOODPARK BLVD. | BUILDING SPECS

Square Footage	
Total Area (SF)	69,256
Available SF	11,520
Estimated Office Area	1,584
Property Features	
Site Size (Acres)	±3.5
Year Built	1984
Loading Type	Front
Clear Height	20'
Column Spacing	35'
Building Depth	150'
Auto Parking	61
Truck Courts	100' deep w/ 50' concrete apron
Dock Doors	2
Drive-In Doors	0
Construction Overview	
Construction	Steel structure with brick cavity walls
Roof Type	EPDM
Roof Age	2003
Fire Protection	Ordinary hazard

Floor Plan

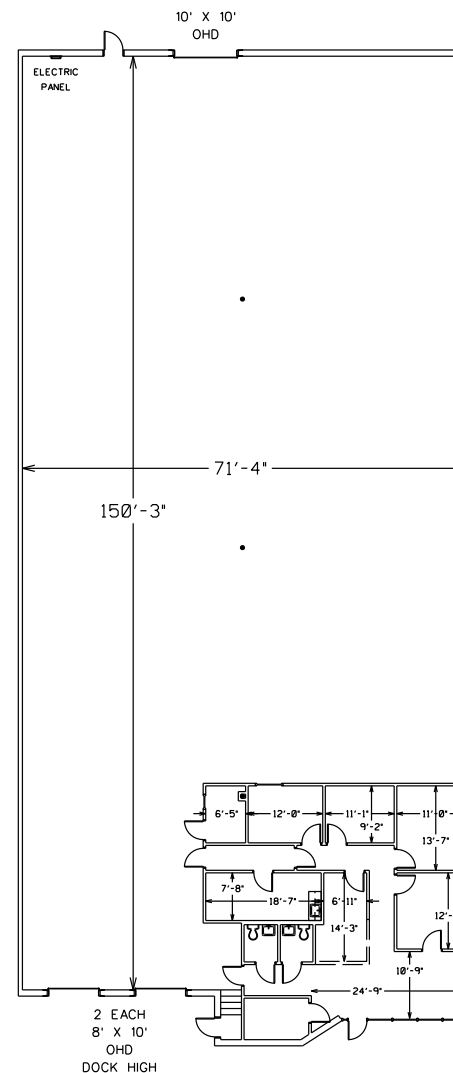

Christopher Skibinski, SIOR
Principal | Managing Director
704.412.5606
chris.skibinski@avisonyoung.com

Henry Lobb
Senior Vice President
704.469.5964
henry.lobb@avisonyoung.com

Chris Loyd
Vice President
704.612.0238
chris.loyd@avisonyoung.com

Trent King
Associate
704.612.0812
trent.king@avisonyoung.com



AVISON
YOUNG



WOODLAND

BUSINESS PARK

INDUSTRIAL SPACE AVAILABLE FOR LEASE - 11,520 SF

3800-C Woodpark Boulevard | Charlotte, North Carolina 28206

Location Map

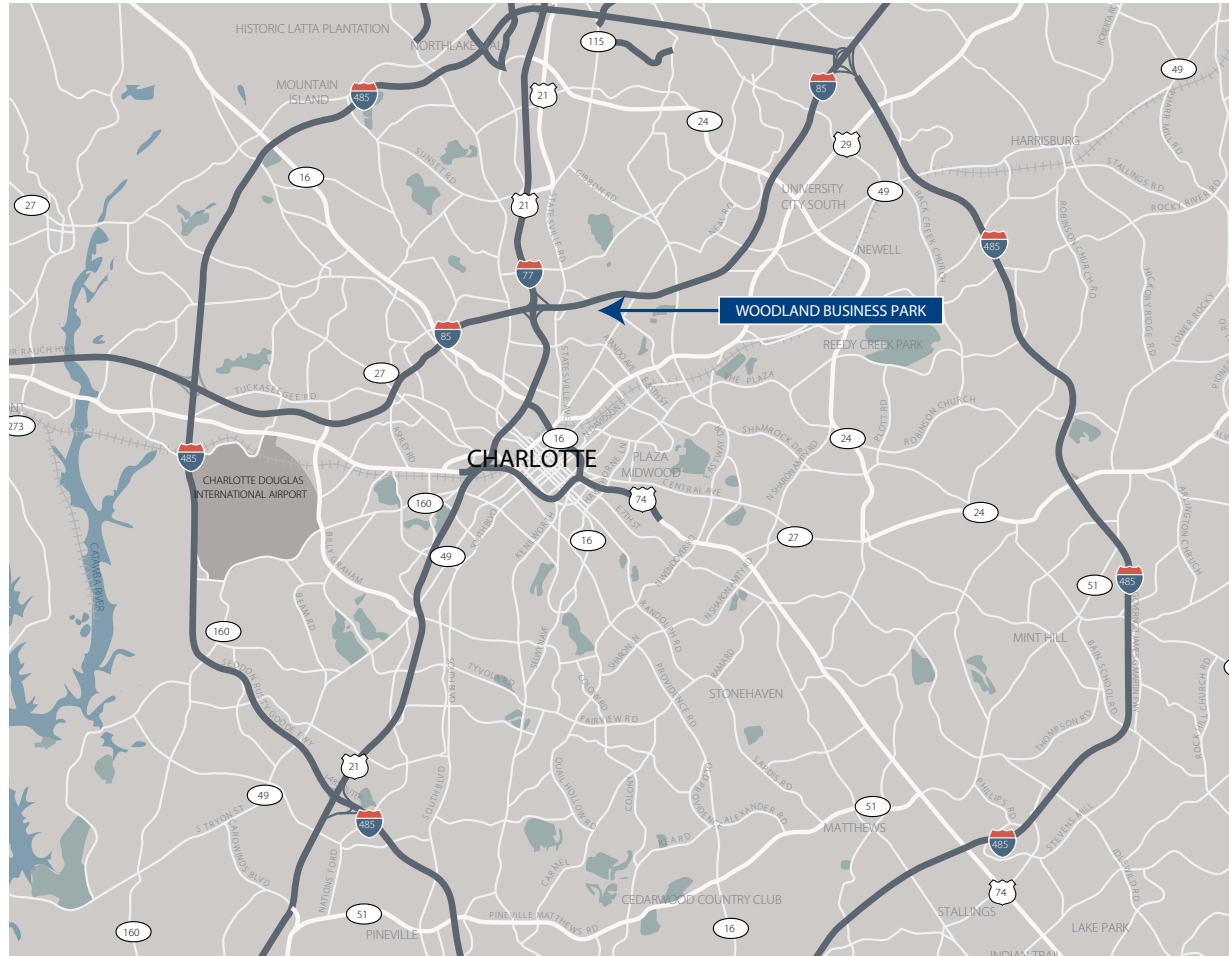

Christopher Skibinski, SIOR
Principal | Managing Director
704.412.5606
chris.skibinski@avisonyoung.com

Henry Lobb
Senior Vice President
704.469.5964
henry.lobb@avisonyoung.com

Chris Loyd
Vice President
704.612.0238
chris.loyd@avisonyoung.com

Trent King
Associate
704.612.0812
trent.king@avisonyoung.com

The information contained herein was obtained from sources believed reliable; however, Avison Young makes no guarantees, warranties, or representations as to the completeness or accuracy thereof. The presentation of this property is submitted subject to errors, omissions, changes of price or conditions prior to sale or lease, or withdrawal without notice.

