

TOTEM VALLEY

BUSINESS CENTER

12912 NE 125th Way | Kirkland, WA 98034



Northwest Building ^{LLC}

LARGE SCALE RENOVATIONS UNDERWAY



BUILDING FEATURES



EXCELLENT ACCESS



GRADE-LEVEL LOADING



13' CLEAR HEIGHT



AMENITIES NEARBY



ABUNDANT PARKING



For more information or to schedule a tour, please contact:



CONNOR GILCHRIST
425.274.4286
gilchrist@broderickgroup.com

JEFF LIVINGSTON
425.274.4288
livingston@broderickgroup.com

RAWLEY HOLMBERG
425.274.4284
holmberg@broderickgroup.com

The information contained herein has been given to us by the owner or sources which we deem reliable. We have no reason to doubt its accuracy, but we do not guarantee it. Prospective tenants should carefully verify all information contained herein.

TOTEM VALLEY BUSINESS CENTER

12912 NE 125th Way | Kirkland, WA 98034

AREA AMENITIES



- | | | |
|--------------------------------|--|--|
| 1 QFC | 11 Fred Meyer | 21 Rite Aid |
| 2 Five Guys | 12 EvergreenHealth Medical Center | 22 LA Fitness |
| 3 Courtyard by Marriott | 13 Key Bank | 23 Northwest Cellars |
| 4 Papa Murphy's | 14 The Village at Totem Lake | 24 Totem Square Shopping Center |
| 5 Olive Garden | 15 Chipotle | 25 Subway |
| 6 Starbucks | 16 MOD Pizza | 26 7-Eleven |
| 7 Azteca | 17 Wells Fargo | 27 Teriyaki Plus |
| 8 Wendy's | 18 Bank of America | 28 Shari's |
| 9 Lowe's | 19 Chick-fil-A | 29 Gold's Gym |
| 10 Jimmy John's | 20 Comfort Inn | |

For more information or to schedule a tour, please contact:



CONNOR GILCHRIST
425.274.4286
gilchrist@broderickgroup.com

JEFF LIVINGSTON
425.274.4288
livingston@broderickgroup.com

RAWLEY HOLMBERG
425.274.4284
holmberg@broderickgroup.com

The information contained herein has been given to us by the owner or sources which we deem reliable. We have no reason to doubt its accuracy, but we do not guarantee it. Prospective tenants should carefully verify all information contained herein.

TOTEM VALLEY

BUSINESS CENTER

12912 NE 125th Way | Kirkland, WA 98034

AVAILABILITY

| BUILDING / SUITE | AVAILABLE SPACE | OFFICE SF | WH SF | AVAILABLE DATE | MONTHLY BASE RENT |
|------------------|-----------------|------------|------------|----------------|-------------------|
| <u>A2 / 228</u> | 5,267 RSF | 2,759 RSF* | 2,508 RSF* | Now | \$10,534 |

*Based on speculative plans and subject to final re-measurement.

The information contained herein has been given to us by the owner or sources that we deem reliable. We have no reason to doubt its accuracy, but we do not guarantee it. Prospective tenants should carefully verify all information contained herein.

SITE MAP

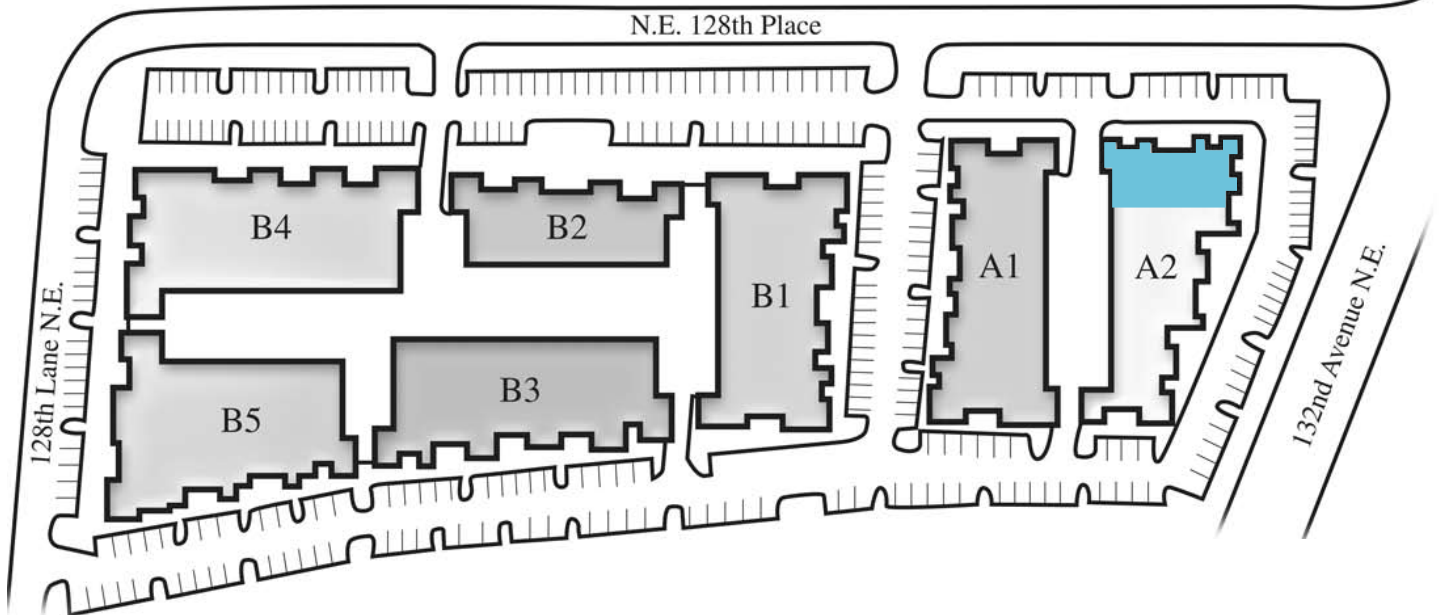

For more information or to schedule a tour, please contact:



CONNOR GILCHRIST
425.274.4286
gilchrist@broderickgroup.com

JEFF LIVINGSTON
425.274.4288
livingston@broderickgroup.com

RAWLEY HOLMBERG
425.274.4284
holmberg@broderickgroup.com

The information contained herein has been given to us by the owner or sources which we deem reliable. We have no reason to doubt its accuracy, but we do not guarantee it. Prospective tenants should carefully verify all information contained herein.

TOTEM VALLEY BUSINESS CENTER

12912 NE 125th Way | Kirkland, WA 98034

BUILDING A2

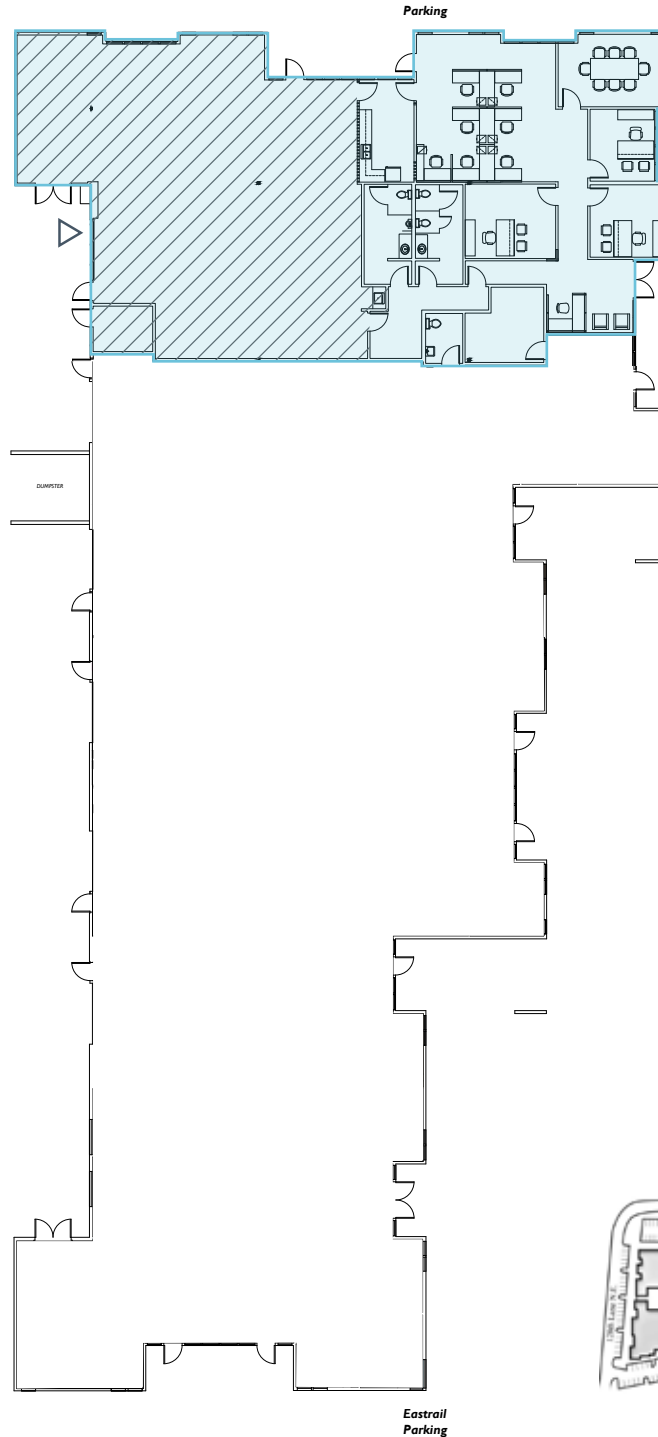

SUITE A228
5,267 RSF
AVAILABLE NOW

Parking
Slater Ave NE



WAREHOUSE



GRADE LEVEL DOOR



↑ BACK TO AVAILABILITY



For more information or to schedule a tour, please contact:

CONNOR GILCHRIST
425.274.4286
gilchrist@broderickgroup.com

JEFF LIVINGSTON
425.274.4288
livingston@broderickgroup.com

RAWLEY HOLMBERG
425.274.4284
holmberg@broderickgroup.com

The information contained herein has been given to us by the owner or sources which we deem reliable. We have no reason to doubt its accuracy, but we do not guarantee it. Prospective tenants should carefully verify all information contained herein.