

FOR LEASE

Alta Vista Plaza

NWC 27th Ave and Northern Ave

Phoenix | Arizona



GROCERY ANCHORED CENTER



Property Highlights

- New Center Anchor: Baiz Market - 3rd location within the Valley
- Located ±0.25 miles west of the I-17 Freeway (Exit 206)
- High Traffic Counts - 120,353 vehicles per day at the intersection
- Dense residential population - 181,891 within 3 miles
- Washington Elementary School located across 27th Avenue
- Drive-thru Pads available
- 4,260 SF End Cap (Divisible)
- **Call for rates**

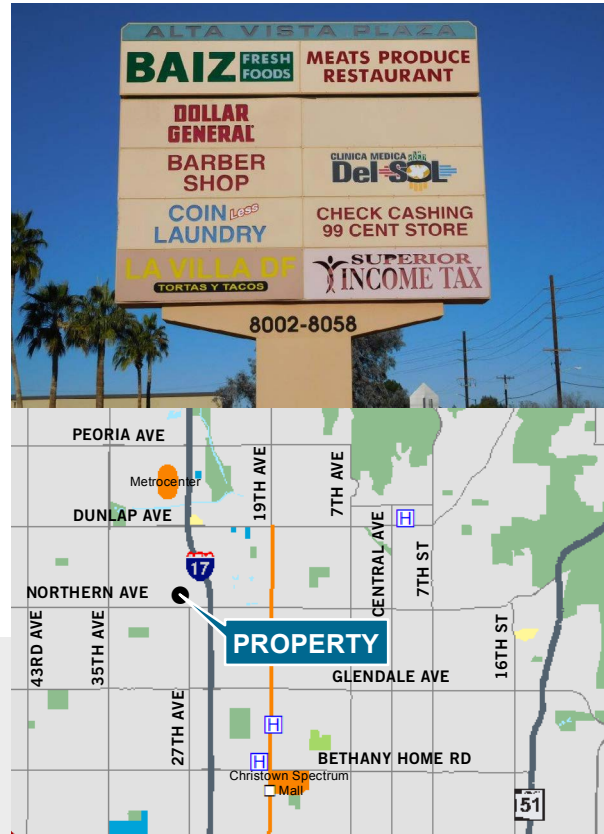

Cliff Johnston
Managing Director
+1 602 224 4445
cliff.johnston@cushwake.com

2555 E Camelback Rd, Ste 400
Phoenix, Arizona
main +1 602 954 9000
fax +1 602 253 0528
cushmanwakefield.com

FOR LEASE

Alta Vista Plaza

NWC 27th Ave and Northern Ave

Phoenix | Arizona



Site Plan

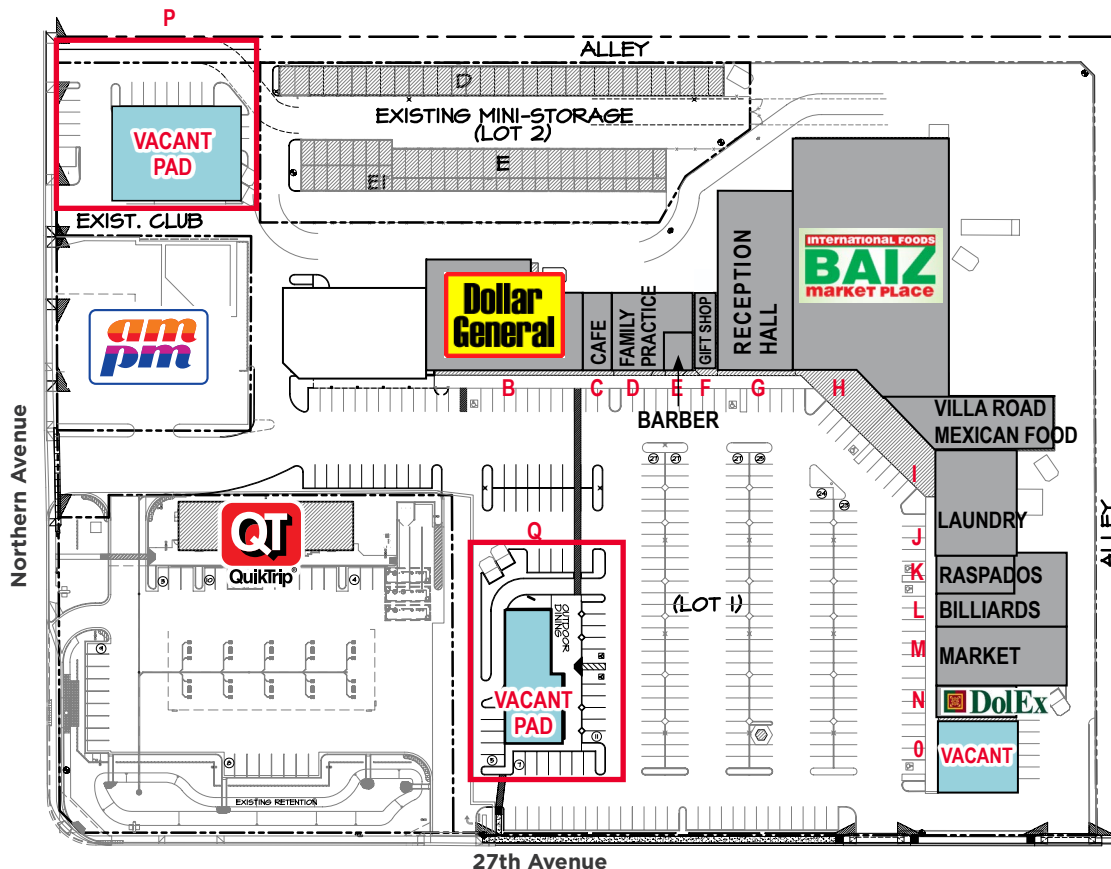

Space Available

| UNIT | TENANT | SF | UNIT | TENANT | SF |
|--------|--------------------------|--------|--------|--------------------------|---------------------------|
| A 25 | Clearly Water Mills, LP | 0 | K 8040 | Las Nieves Raspados | 1,200 |
| B 8010 | Dollar General | 9,147 | L 8042 | Billiards | 2,800 |
| C 8020 | Cafe Emina | 1,200 | M 8048 | Market | 4,000 |
| D 8022 | Gutierrez Family Clinic | 3,120 | N 8050 | Dolex Financial Services | 558 |
| E 8024 | Barber | 480 | O 8054 | Vacant | 4,260 (Divisible) |
| F 8026 | Gift Shop | 1,020 | P | Drive-Thru Pad Available | 2,024 - 3,066 (Buildable) |
| G 8028 | Event Hall | 8,400 | Q | Drive-Thru Pad Available | 3,922 (Buildable) |
| H 8030 | Baiz Market | 21,507 | | | |
| I 8032 | Villa Road Mexican Food | 4,369 | | | |
| J 8036 | Crystal Coinless Laundry | 6,728 | | | |

Demographics

| | 1 Mile | 2 Mile | 3 Mile |
|----------------|----------|----------|----------|
| Population | 21,000 | 82,844 | 181,891 |
| AVG. HH Income | \$42,125 | \$49,180 | \$51,241 |

Traffic Counts

| | North | South | East | West |
|--|-------|--------|--------|--------|
| | 9,280 | 13,285 | 55,609 | 42,179 |

©2020 Cushman & Wakefield. All rights reserved. The information contained in this communication is strictly confidential. This information has been obtained from sources believed to be reliable but has not been verified. No warranty or representation, express or implied, is made as to the condition of the property (or properties) referenced herein or as to the accuracy or completeness of the information contained herein, and same is submitted subject to errors, omissions, change of price, rental or other conditions, withdrawal without notice, and to any special listing conditions imposed by the property owner(s). Any projections, opinions or estimates are subject to uncertainty and do not signify current or future property performance.