

# 2790 JUNIPERO SERRA BLVD.

DALY CITY, CA 94015

±976 RSF OFFICE SPACE  
Great Location Just Off of HWY 280



**Karen Chin**  
Director  
+1 650 401 2132  
karen.chin@cushwake.com  
LIC #01036169

1350 Bayshore Hwy., Suite 900  
Burlingame, CA  
main +1 650 347 3700  
fax +1 650 347 4307  
[cushmanwakefield.com](http://cushmanwakefield.com)





# 2790 JUNIPERO SERRA BLVD.

DALY CITY, CA 94015





# 2790 JUNIPERO SERRA BLVD.

DALY CITY, CA 94015

## PROPERTY HIGHLIGHTS

- ±976 RSF Available
- Great identity
- Close by to Colma BART (14 mins walking) & Daly City BART
- Amenities close by
- Visible from Hwy 280
- 10 minutes to SFO

### Karen Chin

Director  
+1 650 401 2132  
karen.chin@cushwake.com  
LIC #01036169

1350 Bayshore Hwy., Suite 900  
Burlingame, CA  
main +1 650 347 3700  
fax +1 650 347 4307  
[cushmanwakefield.com](http://cushmanwakefield.com)

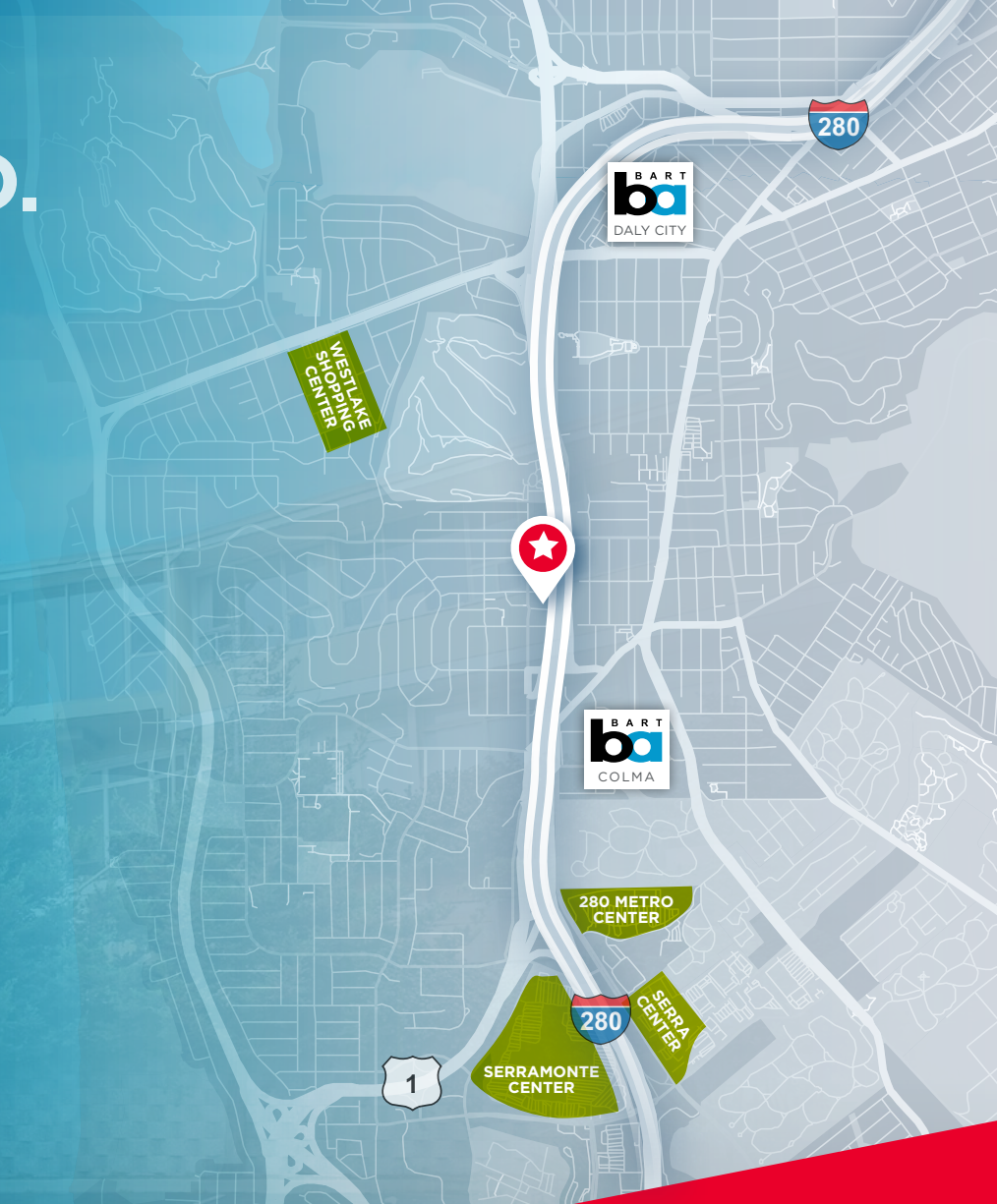

# 2790 JUNIPERO SERRA BLVD

DALY CITY, CA 94015

## FLOOR PLAN

### 2790 Junipero Serra

**Suite 200** | Suite **A** & **C** ±976 RSF  
Divisible to ±199 RSF to ±777 RSF

- Large shared entrance
- Great for accounting/attorneys
- Second floor space
- Available now
- Great glass line
- **\$2.25 - \$2.75 GR**

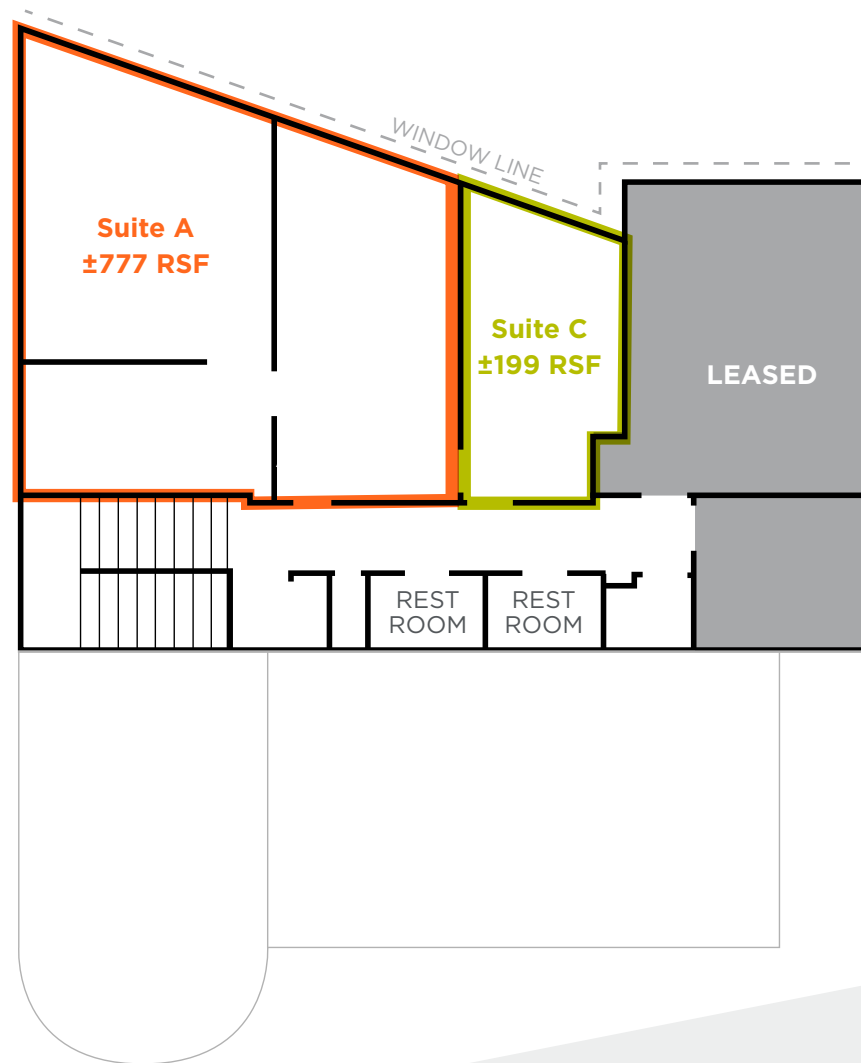

### Karen Chin

Director  
+1 650 401 2132  
karen.chin@cushwake.com  
LIC #01036169

1350 Bayshore Hwy., Suite 900  
Burlingame, CA  
main +1 650 347 3700  
fax +1 650 347 4307  
[cushmanwakefield.com](http://cushmanwakefield.com)

