

4255 RUFFIN ROAD SAN DIEGO, CA 92123



INDUSTRIAL SPACE FOR LEASE
16,000 to 22,700 SF

KEARNY MESA

PROPERTY FEATURES

- Street Front Visibility to Ruffin Road
- Easy Access to the I-15 Freeway
- Extensive Window Line
- 4.0/1000 Parking Ratio
- 16' Clear Height in Warehouse
- 1 Dock High Door
- 2,000 Amps 480/208 V
- 100% HVAC

BUILDING FEATURES

TOTAL SQUARE FEET	54,400 SF
TOTAL AVAILABLE	16,000 to 22,700 SF
LEASE RATE	\$.85 NNN



For more information, please contact:

MICKEY MORERA
Executive Director
(858) 558 5639
mickey.morera@cushwake.com
Lic. #950071

JEFF BROWN
Associate Director
(858) 558 5622
jeff.brown@cushwake.com
Lic. #01496665

CUSHMAN & WAKEFIELD OF SAN DIEGO, INC.
Lic. #01329963
4747 Executive Drive, 9th Floor
San Diego, CA 92121
www.cushmanwakefield.com

The depiction in the included photograph of any person, entity, sign, logo or property, other than Cushman & Wakefield's (C&W) client and the property offered by C&W, is incidental only, and is not intended to connote any affiliation, connection, association, sponsorship or approval by or between that which is incidentally depicted and C&W or its client. This listing shall not be deemed an offer to lease, sublease or sell such property; and, in the event of any transaction for such property, no commission shall be earned by or payable to any cooperating broker except if otherwise provided pursuant to the express terms, rates and conditions of C&W's agreement with its principal, if, as and when such commission (if any) is actually received from such principal. (A copy of the rates and conditions referred to above with respect to this property is available upon request.)

4255 RUFFIN ROAD

Industrial Space For Lease

AVAILABLE
FOR LEASE

FLOOR PLAN

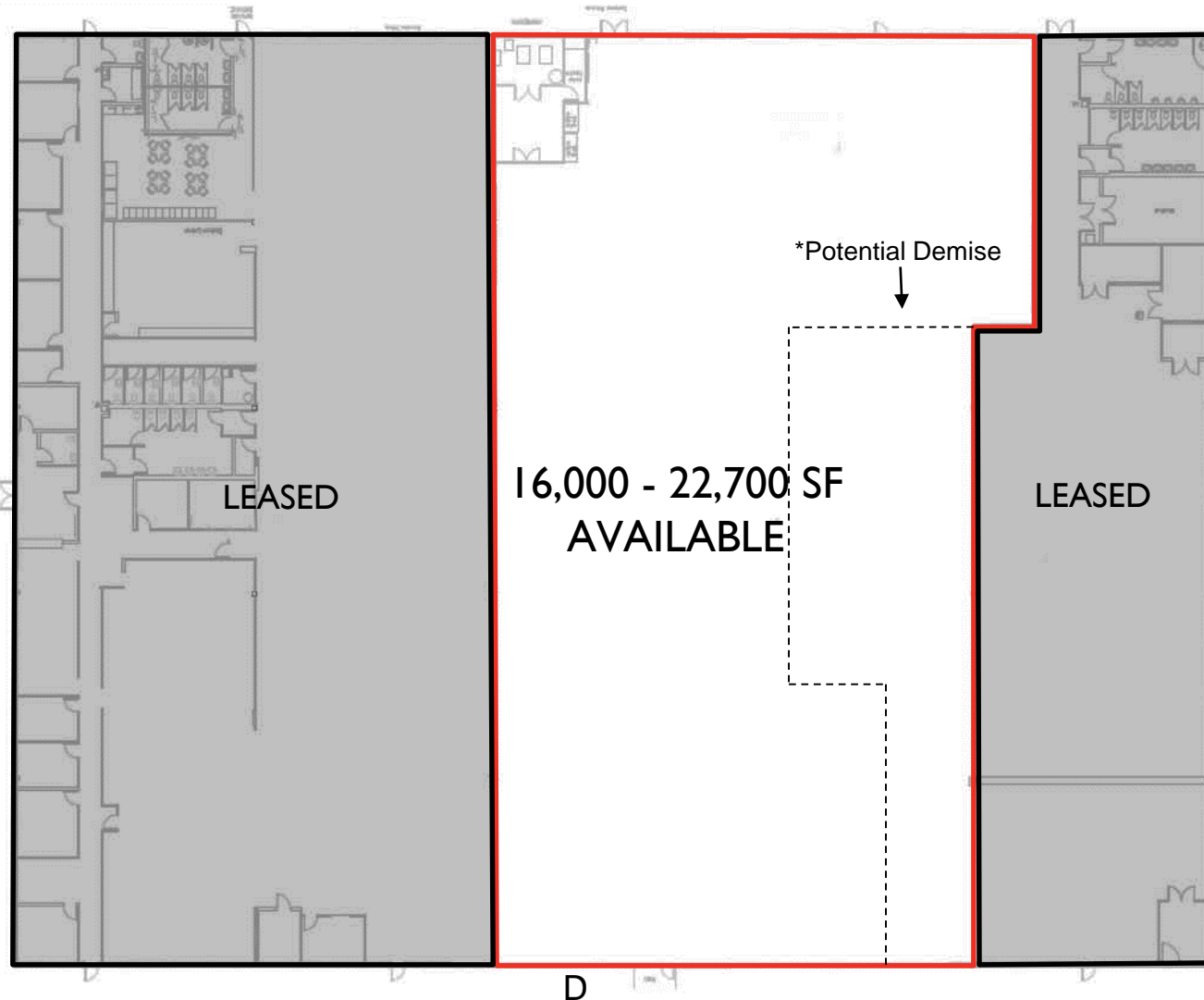

D- Dock High Door

For more information, please contact:

MICKEY MORERA
Executive Director
(858) 558 5622
mickey.morera@cushwake.com
Lic. #950071

JEFF BROWN
Associate Director
(858) 558 5622
jeff.brown@cushwake.com
Lic. #01496665

CUSHMAN & WAKEFIELD OF SAN DIEGO, INC.
Lic. #01329963
4747 Executive Drive, 9th Floor
San Diego, CA 92121
www.cushmanwakefield.com

The depiction in the included photograph of any person, entity, sign, logo or property, other than Cushman & Wakefield's (C&W) client and the property offered by C&W, is incidental only, and is not intended to connote any affiliation, connection, association, sponsorship or approval by or between that which is incidentally depicted and C&W or its client. This listing shall not be deemed an offer to lease, sublease or sell such property; and, in the event of any transaction for such property, no commission shall be earned by or payable to any cooperating broker except if otherwise provided pursuant to the express terms, rates and conditions of C&W's agreement with its principal, if, as and when such commission (if any) is actually received from such principal. (A copy of the rates and conditions referred to above with respect to this property is available upon request.)

4255 RUFFIN ROAD

Industrial Space For Lease

AVAILABLE
FOR LEASE

AERIAL OVERVIEW



For more information, please contact:

MICKEY MORERA
Executive Director
(858) 558 5622
mickey.morera@cushwake.com
Lic. #950071

JEFF BROWN
Associate Director
(858) 558 5622
jeff.brown@cushwake.com
Lic. #01496665

CUSHMAN & WAKEFIELD OF SAN DIEGO, INC.
Lic. #01329963
4747 Executive Drive, 9th Floor
San Diego, CA 92121
www.cushmanwakefield.com

The depiction in the included photograph of any person, entity, sign, logo or property, other than Cushman & Wakefield's (C&W) client and the property offered by C&W, is incidental only, and is not intended to connote any affiliation, connection, association, sponsorship or approval by or between that which is incidentally depicted and C&W or its client. This listing shall not be deemed an offer to lease, sublease or sell such property; and, in the event of any transaction for such property, no commission shall be earned by or payable to any cooperating broker except if otherwise provided pursuant to the express terms, rates and conditions of C&W's agreement with its principal, if, as and when such commission (if any) is actually received from such principal. (A copy of the rates and conditions referred to above with respect to this property is available upon request.)