

**BARRETT PARKWAY EXTENSION**  
 (VARIABLE RIGHT-OF-WAY)  
 COEB COUNTY D.O.T. PROJECT NO. 4225  
 - PUBLIC/ASPHALT/LIMITED ACCESS -  
 45 M.P.H.

**OLD HIGHWAY NO. 41**  
 (VARIABLE RIGHT-OF-WAY)  
 COEB COUNTY D.O.T. PROJECT NO. 4225  
 - PUBLIC/ASPHALT -  
 40 M.P.H.

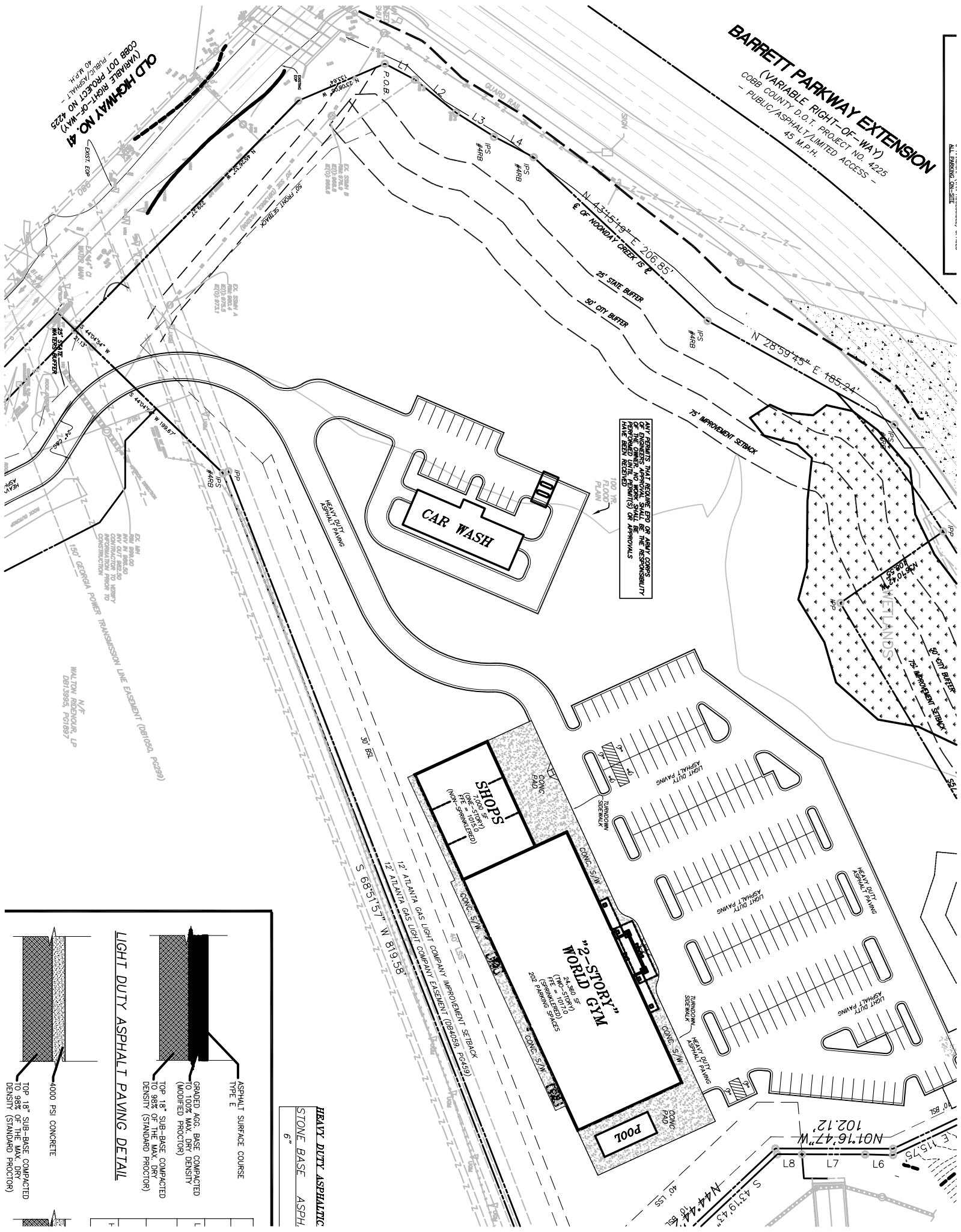

ANY PERMITS THAT REQUIRE EPI OR ADULT CORPS OF ENGINEERS APPROVAL SHALL BE THE RESPONSIBILITY OF THE APPLICANT. PERMITS SHALL BE OBTAINED AND APPROVED PRIOR TO CONSTRUCTION. APPROVALS HAVE BEEN RECEIVED.

